

F.A.U. NO.	SECTION	COUNTY	TOTAL SHEETS	SHEET NO.
2508	02-00039-00-PV	KENDALL	146	62
STA.		TO STA.		
FED. ROAD DIST. NO.	ILLINOIS	FED. AID PROJECT		

87333

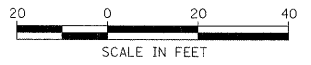

OLD POST ROAD

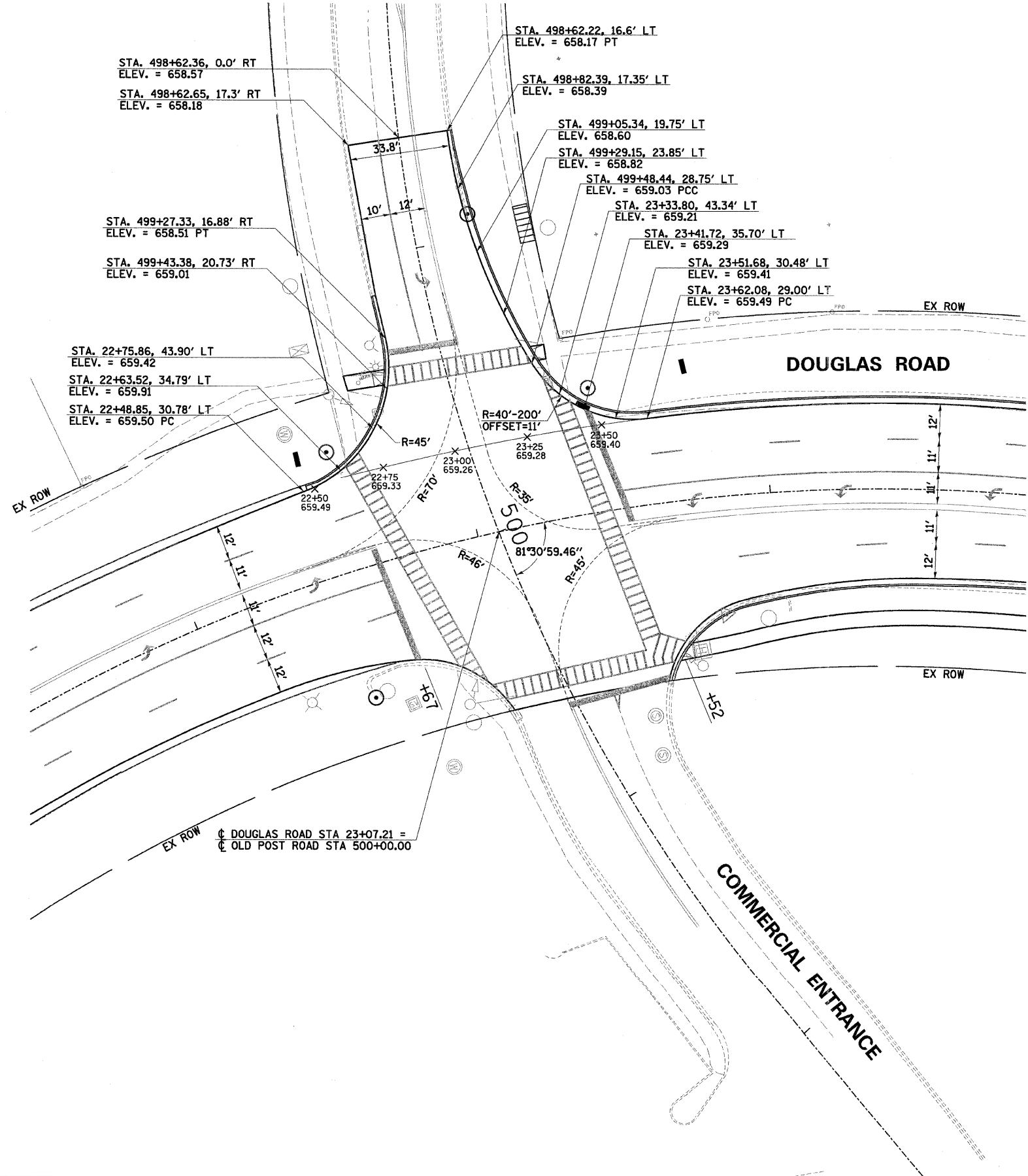

PLAN	SURVEYED	DATE
	PLOTTED	
	CHECKED	
	BY	
	NOTE BOOK NO.	
	CADD FILE NAME	

PROFILE	SURVEYED	DATE
	PLOTTED	
	CHECKED	
	BY	
	NOTE BOOK NO.	
	STRUCTURE NOTATIONS	

2/25/06 AM
3/28/2007
y:\jobs\smith\11\2001\010742_db\douglas\cadd\fn_dwg\142_1101.dgn

ILLINOIS DEPARTMENT OF TRANSPORTATION
F.A.U. 2508 – DOUGLAS ROAD
(U.S. RTE 34 TO U.S. RTE 30)

INTERSECTION PAVEMENT ELEVATION PLAN

SCALE: VERT. _____
 HORIZ. _____
 DATE _____

DRAWN BY _____
 CHECKED BY _____