

F.A.U. RTE.	SECTION	COUNTY	TOTAL SHEETS	SHEET NO.
2508	02-00039-00-PV	KENDALL	146	71
STA.	TO STA.			
FED. ROAD DIST. NO.	ILLINOIS	FED. AID PROJECT		

87333

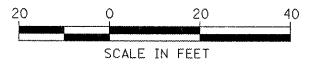

REMOVED EXISTING TRAFFIC SIGNAL EQUIPMENT EACH - 1

THE FOLLOWING EXISTING TRAFFIC SIGNAL EQUIPMENT SHALL BE REMOVED BY THE CONTRACTOR, SHALL REMAIN THE PROPERTY OF THE VILLAGE OF OSWEGO AND SHALL BE DELIVERED BY THE CONTRACTOR TO OSWEGO PUBLIC WORKS.

1 EACH CONTROLLER AND CABINET

THE FOLLOWING ITEMS SHALL BE REMOVED BY THE CONTRACTOR AND DISPOSED OF BY HIM AT HIS EXPENSE. THE SALVAGE VALUE OF THE REMOVED EQUIPMENT SHALL BE REFLECTED IN THE CONTRACT BID PRICE.

- 14 EACH SIGNAL HEAD, 1- FACE
- 1 EACH SERVICE INSTALLATION
- 4 EACH TRAFFIC SIGNAL WOOD POST

TEMPORARY TRAFFIC SIGNAL LEGEND

- ← TEMPORARY TRAFFIC SIGNAL HEAD SPAN WIRE MOUNTED, ORIGINAL LOCATION
- ← TEMPORARY TRAFFIC SIGNAL HEAD SPAN WIRE MOUNTED, SECONDARY LOCATION
- ⊙ TEMPORARY WOOD POLE (CLASS 5 OR BETTER) 45 FOOT MINIMUM
- PROPOSED GUY WIRE TO TEMPORARY WOOD POLE
- ⊠ TEMPORARY CONTROLLER CABINET
- TEMPORARY SPAN WIRE, TETHER WIRE, AND CABLE
- ⊞ TEMPORARY SERVICE INSTALLATION
- ▶ EMERGENCY VEHICLE LIGHT DETECTOR
- ⊞ CONFIRMATION BEACON

REMOVE EXISTING TRAFFIC SIGNAL EQUIPMENT LEGEND

- ← EXISTING SIGNAL HEAD TO BE REMOVED
- "E" ■ EXISTING SERVICE INSTALLATION TO BE REMOVED
- EXISTING SIGNAL POST AND FOUNDATION TO BE REMOVED
- "E" ⊠ EXISTING CONTROLLER AND FOUNDATION TO BE REMOVED
- ⊞ EXISTING HANDHOLE TO BE REMOVED
- "E" ⊞ EXISTING HEAVY-DUTY HANDHOLE TO BE REMOVED
- ⊞ EXISTING ALUMINUM MAST ARM POLE AND FOUNDATION TO BE REMOVED
- EXISTING STEEL MAST ARM POLE AND FOUNDATION TO BE REMOVED

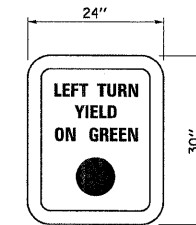

R10-12
24" X 30"
3 SIGN REQUIRED

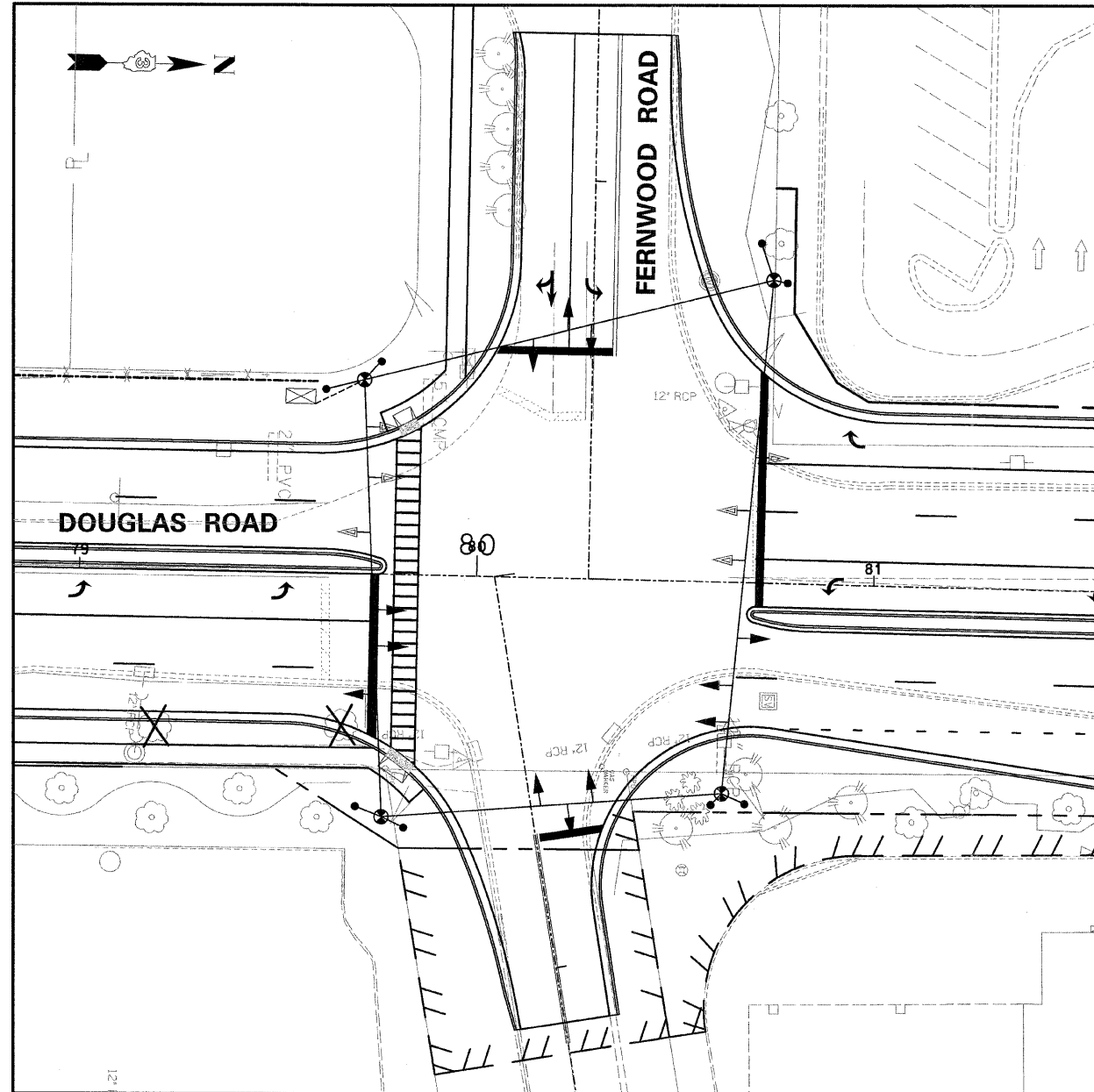

SIGNAL HEADS MAY NEED TO BE MOVED FROM STAGE TO STAGE AS REQUIRED

PLAN	SURVEYED	DATE
NOTE BOOK NO.	PLOTTED	
	CHECKED	
	BY	
	DATE	

PROFILE	SURVEYED	DATE
NOTE BOOK NO.	PLOTTED	
	CHECKED	
	BY	
	DATE	

245222 AM
3/28/2007
x:\jobs\ent\11\200\010742-douglas\cd\Yfn-dwg\742-18101.dgn

ILLINOIS DEPARTMENT OF TRANSPORTATION
F.A.U. 2508 - DOUGLAS ROAD
(U.S. RTE 34 TO U.S. RTE 30)
**TEMPORARY TRAFFIC SIGNAL INSTALLATION
INTERSECTION OF DOUGLAS ROAD
AND FERNWOOD ROAD**

SCALE: VERT. HORIZ.
DATE: DRAWN BY: CHECKED BY: