

PLAN  
 SURVEYED  
 PLOTTED  
 CHECKED  
 DATE  
 BY  
 NO. OF WAY CHECKED  
 DATE FILE NAME

PROFILE  
 SURVEYED  
 PLOTTED  
 CHECKED  
 DATE  
 BY  
 NO. OF WAY CHECKED  
 DATE FILE NAME

# LONG BEACH ROAD

# DOUGLAS ROAD

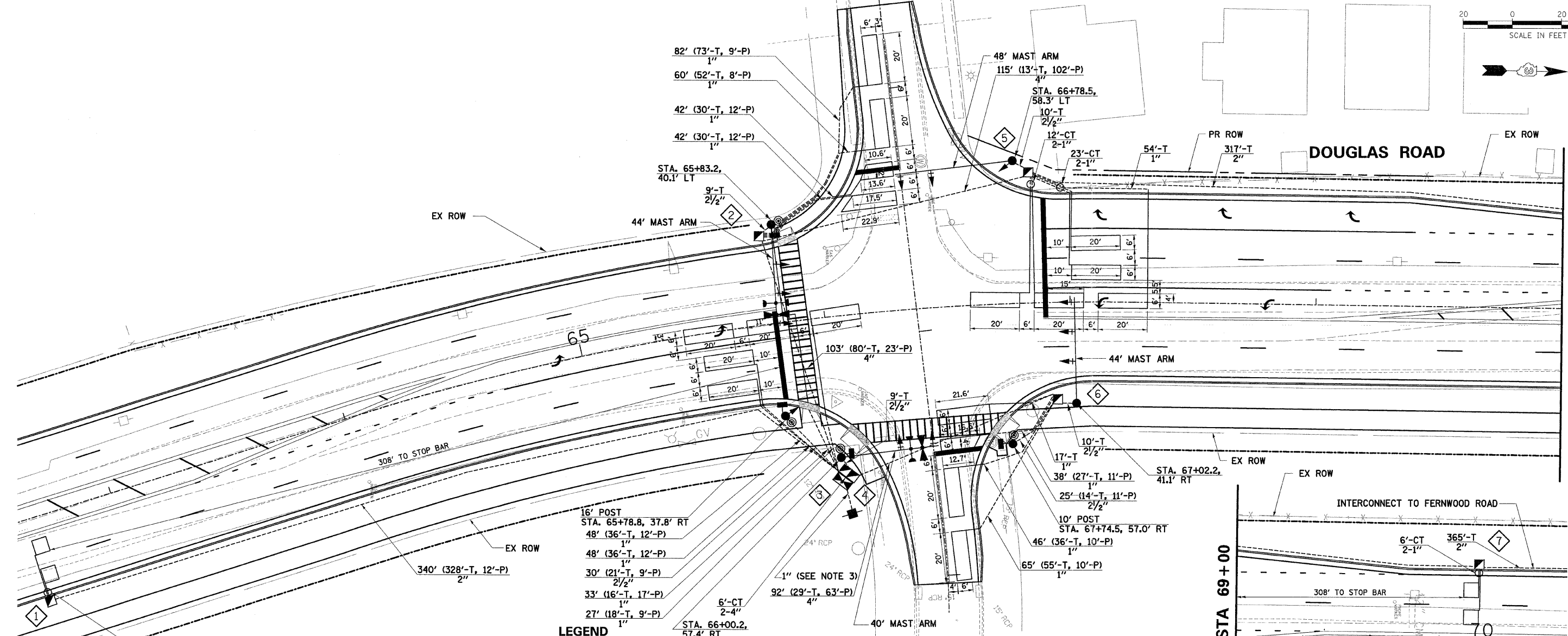

MATCHLINE STA 69+00

MATCHLINE STA 69+00

### LEGEND

	EXISTING	PROPOSED
CONTROLLER CABINET		
SIGNAL POST (LENGTH AS INDICATED)		
SIGNAL FACE		
SIGNAL FACE WITH BACKPLATE		
MAST ARM ASSEMBLY AND POLE (LENGTH AS NOTED)		
COMBINATION MAST ARM ASSEMBLY AND POLE (LENGTH AS NOTED)		
HANDHOLE		
DOUBLE HANDHOLE		
HEAVY DUTY HANDHOLE		
GALVANIZED STEEL CONDUIT		
LOOP DETECTOR		
SERVICE INSTALLATION, TYPE B		
LIGHT DETECTOR		
CONFIRMATION BEACON		
TEMPORARY WOOD POLE (CLASS 5 OR BETTER) 45 FOOT (13.7m) MIN.		
JUNCTION BOX		
PEDESTRIAN SIGNAL HEAD		
PEDESTRIAN PUSHBUTTON		

### NOTES

1. THE EMERGENCY VEHICLE PREEMPTION EQUIPMENT FOR THIS PROJECT SHALL BE "3M OPTICOM".
2. THE TRAFFIC SIGNAL CONTROL EQUIPMENT FOR THIS PROJECT SHALL BE "EAGLE" BRAND TO MATCH ADJACENT SIGNALS.
3. SERVICE INSTALLATION LOCATION TO BE DETERMINED IN THE FIELD AT THE TIME OF CONSTRUCTION

#	EQUIPMENT ITEM	LOCATION
1	HANDHOLE	STA. 62+63.4, 34.5' RT
2	HANDHOLE	STA. 65+77.8, 36.1' LT
3	CONTROLLER	STA. 65+99.7, 67.1' RT
4	DOUBLE HANDHOLE	STA. 66+02.9, 64.2' RT
5	HANDHOLE	STA. 66+84.5, 53.4' LT
6	HANDHOLE	STA. 66+94.3, 39.4' RT
7	HANDHOLE	STA. 69+96.6, 34.6' LT

ILLINOIS DEPARTMENT OF TRANSPORTATION  
 F.A.U. 2508 - DOUGLAS ROAD  
 (U.S. RTE 34 TO U.S. RTE 30)  
 LONG BEACH ROAD  
 TRAFFIC SIGNAL INSTALLATION PLAN

SCALE: VERT. \_\_\_\_\_  
 HORIZ. \_\_\_\_\_  
 DATE \_\_\_\_\_ DRAWN BY \_\_\_\_\_  
 CHECKED BY \_\_\_\_\_

245226 AM  
 3/29/2007  
 Y:\Sbs\smh\2008\00742\_douglas\cdd\Fin\_cwg\742\_sigs.dgn