

**GENERAL NOTES:**

THIS SECTION SHALL BE CONSTRUCTED IN ACCORDANCE WITH THE PLANS, SPECIAL PROVISIONS AND "STANDARD SPECIFICATIONS FOR ROAD AND BRIDGE CONSTRUCTION", ADOPTED JANUARY 1, 2007.

THE WORK INVOLVED ON THIS SECTION CONSISTS OF THE REMOVAL OF THE EXISTING STRUCTURE, THE CONSTRUCTION OF A 60 FOOT LONG SINGLE SPAN PRECAST, PRESTRESSED CONCRETE DECK BEAM BRIDGE, EARTH APPROACHES, AGGREGATE SURFACE COURSE AND OTHER MISCELLANEOUS ITEMS NECESSARY TO COMPLETE THIS SECTION.

ALL ELEVATIONS ARE BASED ON U.S.G.S. MEAN SEA LEVEL DATUM.

IT SHALL BE THE CONTRACTOR'S RESPONSIBILITY TO CONTACT ALL THE UTILITIES, AFFECTING THE PROJECT, PRIOR TO CONSTRUCTION.

**TYPICAL CROSS SECTION PROPOSED**

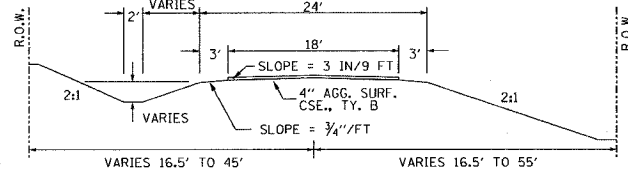

**TYPICAL CROSS SECTION EXISTING**

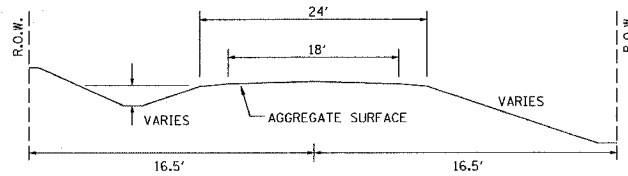

**UTILITIES:**

JULI.I.E. 1-800-892-0123

VERIZON  
225 E. CHESTNUT  
OLNEY, IL 62450  
618-395-6181

WAYNE-WHITE ELECTRIC CO-OP  
ROUTE 45 WEST  
FAIRFIELD, IL 62837  
618-842-2196

NOTE: CONSTRUCT SPECIAL DITCH  
**PAID AS EARTH EX.**  
STA 3+00 TO STA 4+75 RT

NOTE: CONSTRUCT STONE RIPRAP DITCH  
STA 4+50 TO STA 4+75 RT (0.48 TON/LIN FT)  
12 TON STONE RIPRAP DITCH ALLOWED IN PROPOSAL.  
SEE SHEET NO. 13 FOR STONE RIPRAP DITCH DETAIL.

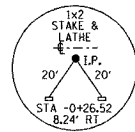

**CURVE #1**  
P.I. STA: 0+97.68  
Δ: RT. 03°24'52"  
D: 01°41'06"  
R: 3400.00'  
T: 101.34'  
L: 202.62'  
E: 1.51'  
e: NONE  
T.R.: NONE  
S.E. RUN: NONE  
P.C. STA: -0+03.66  
P.T. STA: 1+98.95

WAYNE HINDERLITER

**CURVE #3**  
P.I. STA: 5+84.59  
Δ: RT. 12°39'15"  
D: 12°27'20"  
R: 460.00'  
T: 51.00'  
L: 101.59'  
E: 2.82'  
e: NONE  
T.R.: NONE  
S.E. RUN: NONE  
P.C. STA: 5+33.59  
P.T. STA: 6+35.18

WAYNE HINDERLITER

T.R.	SECTION	COUNTY	TOTAL SHEETS	SHEET NO.
231	03-09108-00-BR	EDWARDS	13	2

323 W. 3RD ST.  
P.O. BOX 160  
MT. CARMEL, IL  
62863  
PHONE:  
(618)-262-8651  
FAX:  
(618)-263-3327

LEC JOB # H031007ED

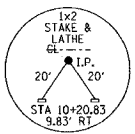

406 W. STATE ST  
SUITE 1  
PRINCETON, IN  
47670  
PHONE:  
(812)-386-7611  
FAX:  
(812)-385-2812

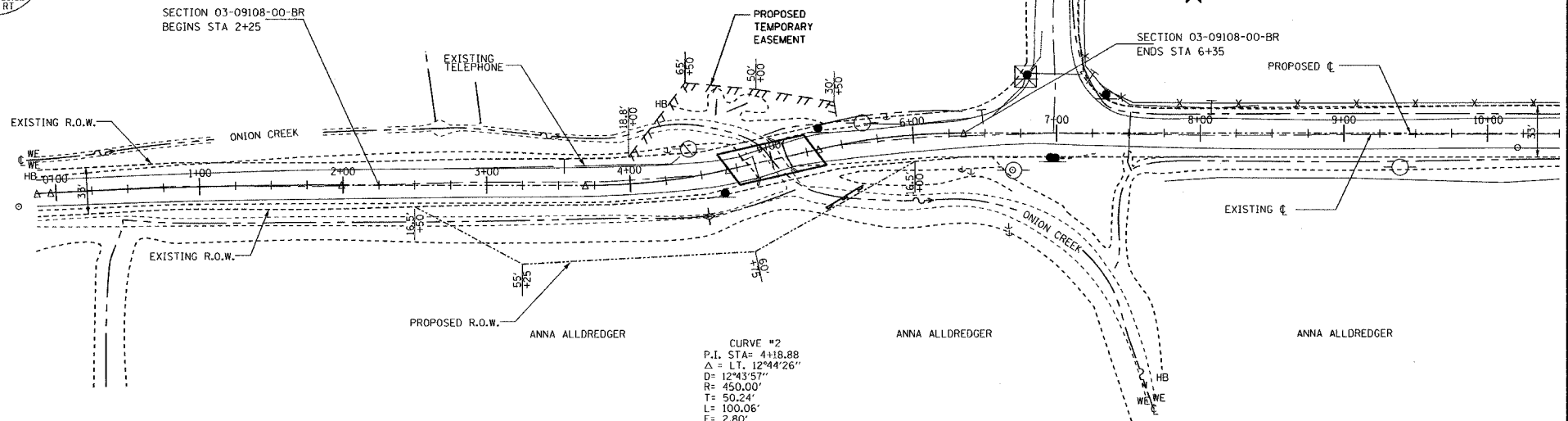

EXISTING BRIDGE STA 4+96.91; STRUCTURE NUMBER: 024-3074  
A 24' LONG BRIDGE HAVING A CONCRETE DECK SUPPORTED  
BY 8-12" STEEL BEAMS ON CONCRETE ABUTMENTS WITH  
CONCRETE WINGS.

ONE (1) EACH-REMOVAL OF EXISTING STRUCTURES ALLOWED IN  
THIS PROPOSAL.

**CURVE #2**  
P.I. STA: 4+18.88  
Δ: LT. 12°44'26"  
D: 12°43'57"  
R: 450.00'  
T: 50.24'  
L: 100.06'  
E: 2.80'  
e: NONE  
T.R.: NONE  
S.E. RUN: NONE  
P.C. STA: 3+68.64  
P.T. STA: 4+68.71

PROPOSED STRUCTURE: NO. 024-3131, STA 5+00,  
A 60' LONG SINGLE SPAN P.P.C.D.B. BRIDGE WITH  
27" DEPTH BEAMS, SPILL THROUGH TYPE ABUTMENTS,  
24' WIDTH, 25° RT SKEW.

SEE SHEETS 5-12 FOR THE DESIGN AND BILL OF MATERIALS.

NOTE: FILL NEXT TO BRIDGE TO BE  
AGGREGATE SURFACE COURSE

TEMPORARY DITCH CHECKS  
AGGREGATE (EROSION CONTROL)

0.2 ACRES SEEDING, CLASS 2 SPECIAL REQUIRED

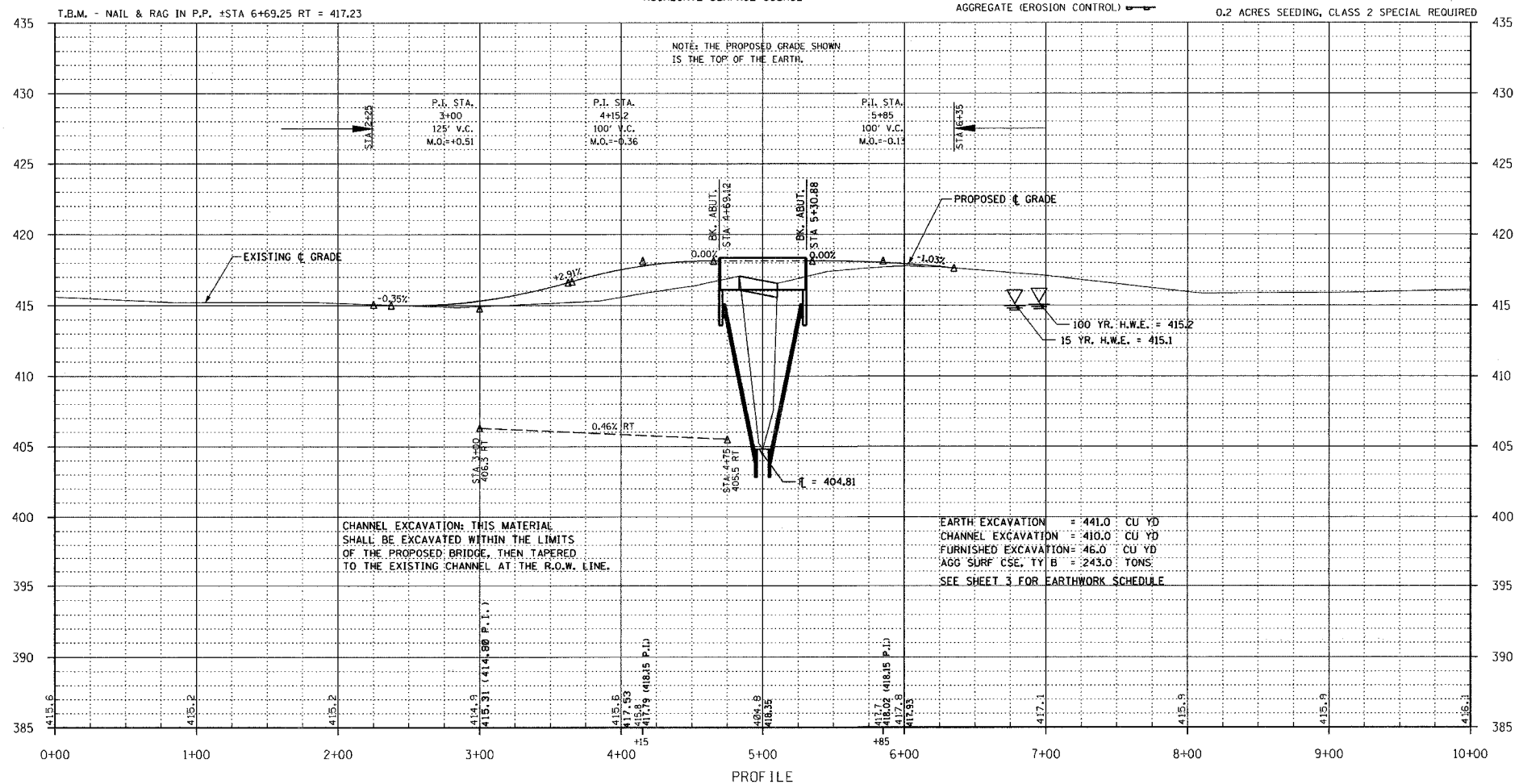

CHANNEL EXCAVATION: THIS MATERIAL  
SHALL BE EXCAVATED WITHIN THE LIMITS  
OF THE PROPOSED BRIDGE, THEN TAPERED  
TO THE EXISTING CHANNEL AT THE R.O.W. LINE.

EARTH EXCAVATION = 441.0 CU YD  
CHANNEL EXCAVATION = 410.0 CU YD  
FURNISHED EXCAVATION = 46.0 CU YD  
AGG SURF CSE, TY B = 243.0 TONS  
SEE SHEET 3 FOR EARTHWORK SCHEDULE



PROFESSIONAL DESIGN FIRM  
LAND SURVEY & PROFESSIONAL  
ENGINEERING CORPORATION  
184-000387  
(62-032435)(35-002769)



AARON M. MEFFORD

NAME

SIGNATURE

DATE

11-30-07

EXPIRES

ROAD DISTRICT NO. 14  
OVER UNION CREEK  
EDWARDS COUNTY, ILLINOIS

SHEET TITLE:

PLAN & PROFILE

SCALE: VARIES  
BY: AMM  
DATE: W67  
REV:

2 OF 13  
SHEETS

SHEET NO.

2