

RTE. NO.	SECTION	COUNTY	TOTAL SHEETS
T.R. 256	06-1116-00-BR	MACON	14
FED. ROAD DIST. NO.	ILLINOIS	PROJECT: BROS-115(63)	

CONTRACT NO. 95530

INDEX OF SHEETS

- 1 Cover Sheet
- 2 Summary of Quantities, General Notes, and Typical Sections
- 3 Plan and Profile
- 4 Horizontal Layout
- 5 Entrance Details
- 6-9 Station Cross Sections
- 10-14 Bridge Plans

STATE OF ILLINOIS
DEPARTMENT OF TRANSPORTATION
DIVISION OF HIGHWAYS
**PLANS FOR PROPOSED
LOCAL AGENCY IMPROVEMENT**

LIST OF STANDARDS

- Standard 000001-05 Standard symbols, abbreviations and patterns
- Standard 280001-04 Temporary erosion control systems
- Standard 515001-02 Name plate for bridges
- Standard 542306-01 Precast Reinforced Concrete Elliptical Flared End Section
- *Standard 542311 Grating For Concrete Flared End Section
- ~~Standard 630001-07 Steel Plate Beam Guardrail Deleted 12-20-07~~
- Standard 630301-04 Shoulder Widening For Type 1 (Special) Guardrail Terminals
- Standard 631011-04 Traffic Barrier Terminal, Type 2
- Standard 635006-02 Reflector and Terminal Marker Placement
- Standard 665001-01 Woven Wire Fence
- Standard 701011-01 Off-road moving operations, 2-l, 2-w, day only, for speeds > 45 mph
- Standard 701301-02 Lane closure, 2-l, 2-w, short time operations
- Standard 701901 Traffic control devices
- Standard BLR-21-7 Typical application of traffic control devices for Construction on Rural Local Highways
- Standard BLR-22-5 Typical application of traffic control devices 2-l, 2-w, rural, Road closed to Thru Traffic
- Standard BLR-27 Traffic Barrier Terminal, Type 5A
- *Grating dimensions to be modified to fit "PRCF END S EL EQRS 60".
- Standard BLR-26 Steel Plate Beam Guardrail

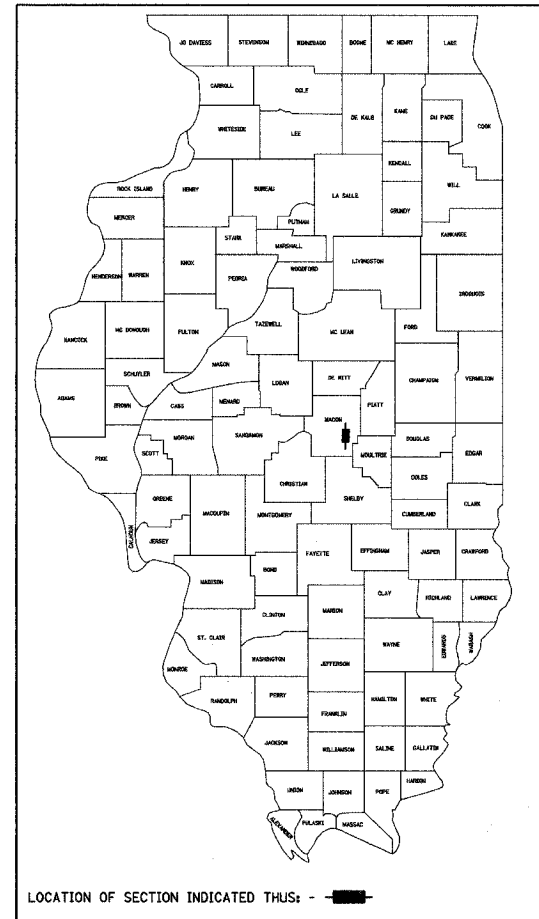
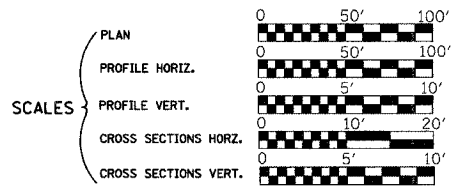

**HIGHWAY BRIDGE PROGRAM
T.R. 256 OVER BIG CREEK
SECTION 06-1116-00-BR
MACON COUNTY
PROJECT BROS-115(63)
C-97-021-08**

ROADWAY CLASSIFICATION: LOCAL STREET (URBAN)
2005 ADT = 550 (2026 ADT = 750)
DESIGN SPEED: 30 MPH

JOINT UTILITY LOCATING INFORMATION FOR EXCAVATORS
J.U.L.I.E. Telephone No. Toll Free 1-800-892-0123

CONTRACT NO. : 95530

URS
345 EAST ASH AVENUE, SUITE B
DECATUR, ILLINOIS 62526
PH. 217-875-4800

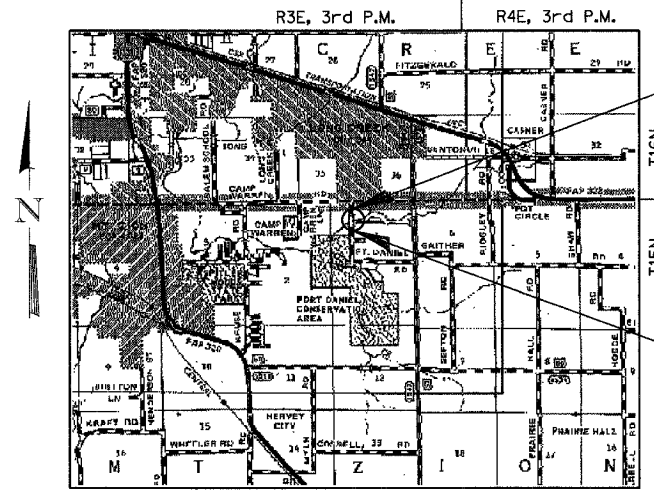

IMPROVEMENT ENDS
STA. 17+15.00

EXIST. STR. NO. 058-3168
PROP. STR. NO. 058-3389

IMPROVEMENT BEGINS
STA. 12+85.00

LAYOUT

Approximate Scale: miles

Total and Net Length of Improvement 430.00 Feet = 0.081 Miles

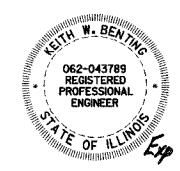

Keith W. Bentley
Illinois Professional No. 43789

APPROVED NOVEMBER 5 2007
[Signature]
COUNTY ENGINEER

PASSED 11-9 2007
[Signature]
DISTRICT SEVEN ENGINEER OF LOCAL ROADS & STREETS

Releasing For Bid Based on Limited Review
11-9 2007
[Signature]
DEPUTY DIRECTOR OF HIGHWAYS, ROAD & BRIDGE ENGINEER

STATE OF ILLINOIS
DEPARTMENT OF TRANSPORTATION

11/5/2007
Date

RTE.	SECTION	COUNTY	TOTAL SHEETS	SHEET NO.
I.R. 256	06-11116-00-BR	MACON	14	5
STA. 8+67.32 TO STA. 21+14.18				
FED. ROAD DIST. NO.	ILLINOIS	PROJECT:	BROS-1154631	

CONTRACT NO. 95530

DATE	
BY	
REVISIONS	
NO.	
DESCRIPTION	
DATE	
BY	
REVISIONS	
NO.	
DESCRIPTION	
DATE	
BY	

DATE	
BY	
REVISIONS	
NO.	
DESCRIPTION	
DATE	
BY	
REVISIONS	
NO.	
DESCRIPTION	
DATE	
BY	

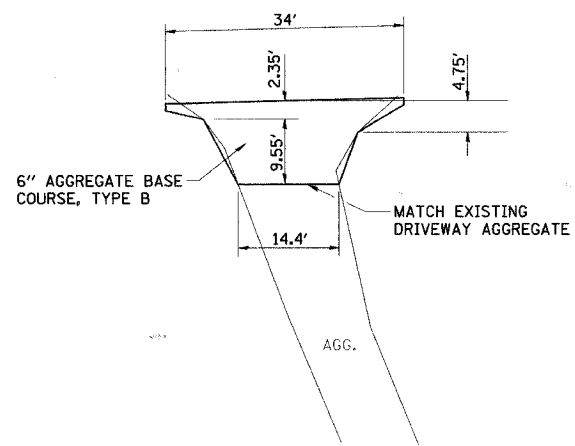

PRIVATE ENTRANCE DETAIL
STA. 16+82.83
 AGGREGATE BASE COURSE, TYPE B
 TOTAL = 10 TONS

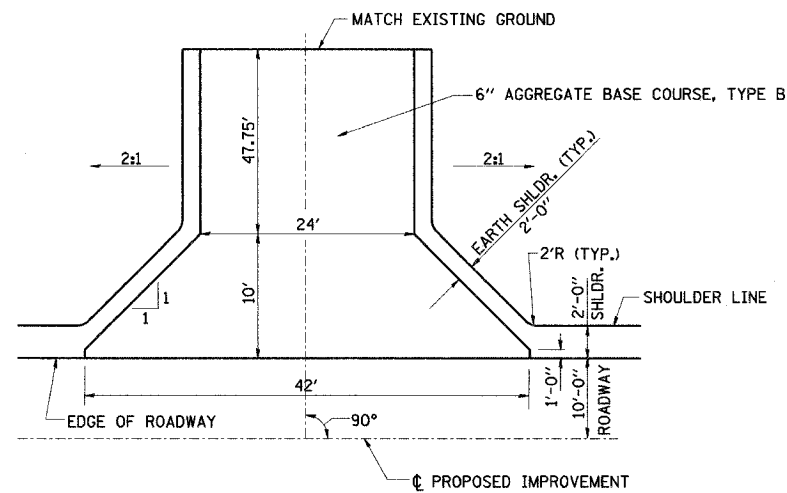

FIELD ENTRANCE DETAIL
STA. 13+50.00
 AGGREGATE BASE COURSE, TYPE B
 TOTAL = 57 TONS

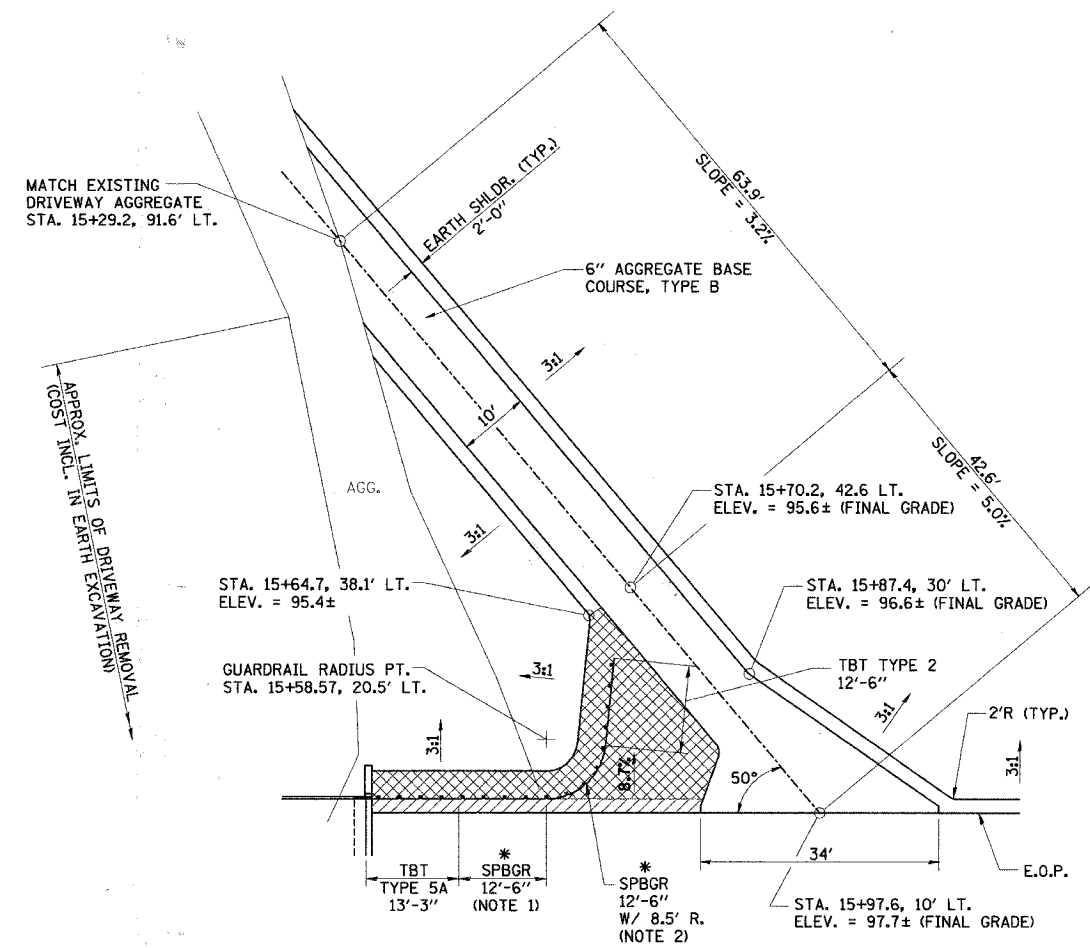

2' SHLDR. SLOPED AT 1/2" / FT.
 SLOPED AT 8.7%

* PAY LIMITS OF STEEL PLATE BEAM
 GUARDRAIL, SHORT RADIUS = 25'-0"

PRIVATE ENTRANCE DETAIL
STA. 16+06.00
 AGGREGATE BASE COURSE, TYPE B
 TOTAL = 50 TONS

NOTES:

- CONSTRUCT ACCORDING TO STANDARD 631011-04 FOR TRAFFIC BARRIER TERMINAL TYPE 2, EXCEPT DELETE END SECTION AND SPLICE INTO RADIUS GUARDRAIL. THE RAIL HEIGHT OF THE TRAFFIC BARRIER TERMINAL TYPE 2'S WILL BE 27".
- FOR THE 8'-6" RADIUS, THE RAIL IS NOT BOLTED TO THE POST LOCATED AT THE MIDPOINT OF THE CURVE.

Revised 12-20-07

ENTRANCE DETAILS