

F.A.S. ROUTE NO.	SECTION	COUNTY	TOTAL SHEETS	SHEET NO.
N/A	06-00126-06-SP	ST. CLAIR	15	6
STA. 10+85.00		TO STA. 22+11.90		
FEDERAL AID PROJECT		CONTRACT 97319		

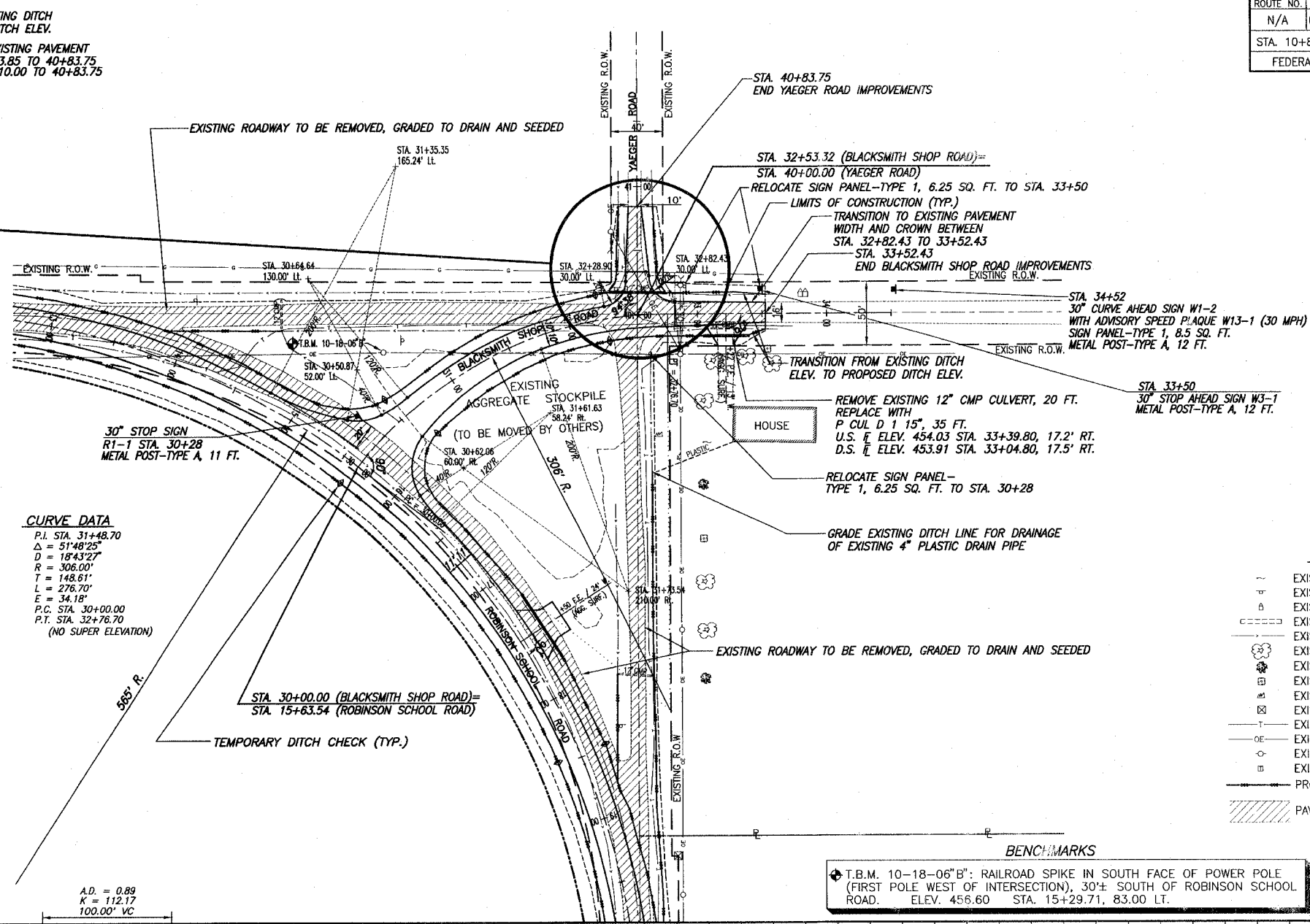
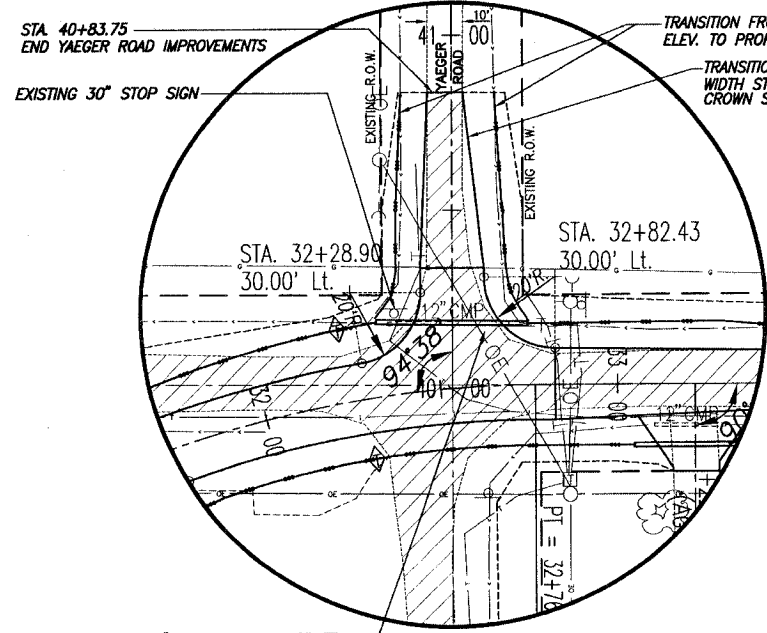

REMOVE EXISTING 12" CMP CULVERT, 35 FT.
REPLACE WITH
P CUL D 1 15", 43 FT.
U.S. ELEV. 453.34 STA. 32+77.08, 20.5' LT.
D.S. ELEV. 453.19 STA. 32+34.08, 16.6' LT.

CURVE DATA
P.I. STA. 31+48.70
Δ = 51°48'25"
D = 18°43'27"
R = 306.00'
T = 148.61'
L = 276.70'
E = 34.18'
P.C. STA. 30+00.00
P.T. STA. 32+76.70
(NO SUPER ELEVATION)

COORDINATE TABLE

STATION	NORTHING	EASTING
11+00.00	30003.01	49346.63
P.C. 11+91.00	30002.59	49437.60
P.I. 17+53.40	30000.00	50000.00
P.T. 20+75.90	29437.60	50000.00
21+00.00	29413.47	50000.00
P.C. 30+00.00	29882.56	49783.18
P.I. 31+48.70	29999.67	49874.82
P.T. 32+76.70	30000.06	50023.43
33+50.00	30000.25	50096.65
40+00.00	29999.10	50000.00
40+50.00	30049.10	50000.00
41+00.00	30099.10	50000.00

- LEGEND**
- EXISTING FLAG POST
 - EXISTING SIGN
 - EXISTING MAILBOX
 - EXISTING CULVERT
 - EXISTING DITCH FLOW LINE
 - EXISTING TREE
 - EXISTING SAPLING
 - EXISTING BUSH
 - EXISTING TREE STUMP
 - EXISTING R.O.W. MONUMENT
 - EXISTING UNDERGROUND TELEPHONE
 - EXISTING OVERHEAD ELECTRIC
 - EXISTING POWER POLE
 - EXISTING TELEPHONE PEDESTAL
 - PROPOSED @ DITCH
 - PAVEMENT REMOVAL

BENCHMARKS
T.B.M. 10-18-06"B: RAILROAD SPIKE IN SOUTH FACE OF POWER POLE (FIRST POLE WEST OF INTERSECTION), 30'E SOUTH OF ROBINSON SCHOOL ROAD. ELEV. 456.60 STA. 15+29.71, 83.00 LT.

SCALE:
PLAN: 1" = 50'
PROFILE: 1" = 50' HORIZ.
1" = 5' VERT.

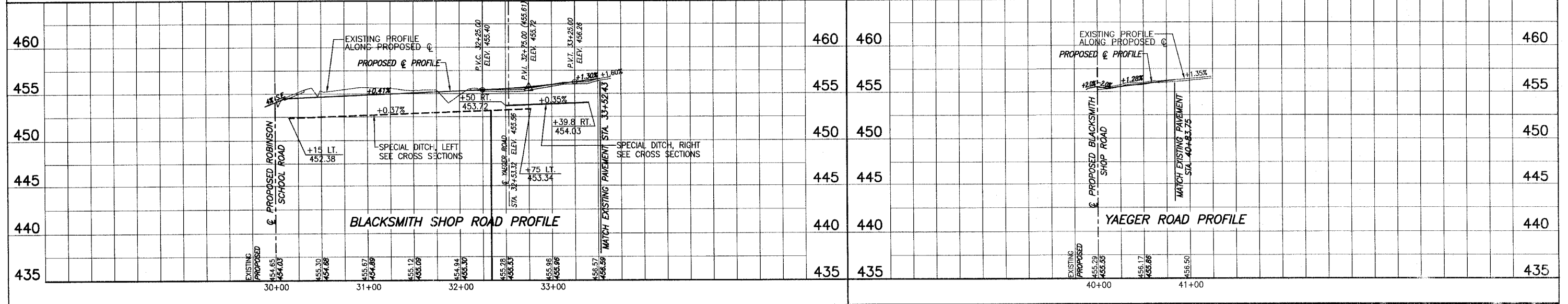

BLACKSMITH SHOP ROAD AND YAEGER ROAD PLAN AND PROFILE
SECTION 06-00126-06-SP ST. CLAIR COUNTY, ILLINOIS