

F.A.U. RTE.	SECTION	COUNTY	TOTAL SHEETS	SHEET NO.
8852	D6-00056-01-WR	MADISON	81	32
STA.		TO STA.		
FED. ROAD DIST. NO.		ILLINOIS FED. AID PROJECT		
DRAINAGE PLAN				

CONTRACT NO. 97324

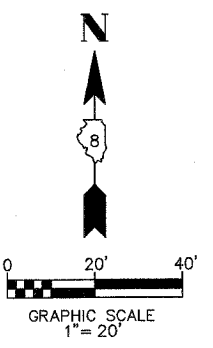
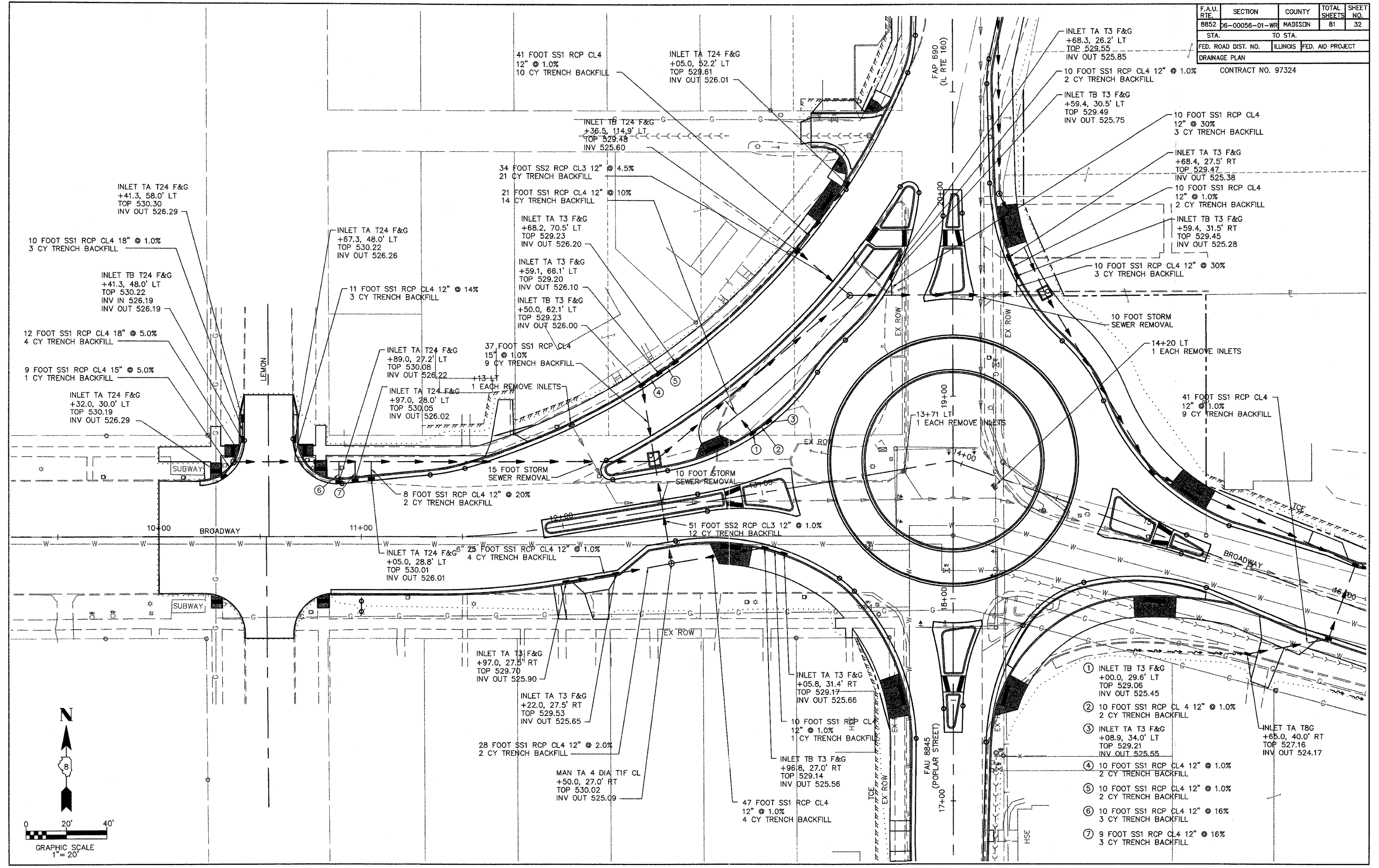

- ① INLET TB T3 F&G
+00.0, 29.6' LT
TOP 529.06
INV OUT 525.45
- ② 10 FOOT SS1 RCP CL 4 12" @ 1.0%
2 CY TRENCH BACKFILL
- ③ INLET TA T3 F&G
+08.9, 34.0' LT
TOP 529.21
INV OUT 525.55
- ④ 10 FOOT SS1 RCP CL4 12" @ 1.0%
2 CY TRENCH BACKFILL
- ⑤ 10 FOOT SS1 RCP CL4 12" @ 1.0%
2 CY TRENCH BACKFILL
- ⑥ 10 FOOT SS1 RCP CL4 12" @ 16%
3 CY TRENCH BACKFILL
- ⑦ 9 FOOT SS1 RCP CL4 12" @ 16%
3 CY TRENCH BACKFILL

- INLET TA T3 F&G
+97.0, 27.5' RT
TOP 529.70
INV OUT 525.90
- INLET TA T3 F&G
+22.0, 27.5' RT
TOP 529.53
INV OUT 525.65
- 28 FOOT SS1 RCP CL4 12" @ 2.0%
2 CY TRENCH BACKFILL
- MAN TA 4 DIA TIF CL
+50.0, 27.0' RT
TOP 530.02
INV OUT 525.09

- INLET TA T3 F&G
+05.8, 31.4' RT
TOP 529.17
INV OUT 525.66
- 10 FOOT SS1 RCP CL
12" @ 1.0%
1 CY TRENCH BACKFILL
- INLET TB T3 F&G
+96.8, 27.0' RT
TOP 529.14
INV OUT 525.56
- 47 FOOT SS1 RCP CL4
12" @ 1.0%
4 CY TRENCH BACKFILL

- INLET TA T24 F&G
+05.0, 28.8' LT
TOP 530.01
INV OUT 526.01
- 25 FOOT SS1 RCP CL4 12" @ 1.0%
4 CY TRENCH BACKFILL

- 8 FOOT SS1 RCP CL4 12" @ 20%
2 CY TRENCH BACKFILL

- 37 FOOT SS1 RCP CL4
15" @ 1.0%
9 CY TRENCH BACKFILL

- 34 FOOT SS2 RCP CL3 12" @ 4.5%
21 CY TRENCH BACKFILL
- 21 FOOT SS1 RCP CL4 12" @ 10%
14 CY TRENCH BACKFILL

- 41 FOOT SS1 RCP CL4
12" @ 1.0%
10 CY TRENCH BACKFILL

- INLET TA T24 F&G
+41.3, 58.0' LT
TOP 530.30
INV OUT 526.29

- 10 FOOT SS1 RCP CL4 18" @ 1.0%
3 CY TRENCH BACKFILL

- INLET TB T24 F&G
+41.3, 48.0' LT
TOP 530.22
INV IN 526.19
INV OUT 526.19

- 12 FOOT SS1 RCP CL4 18" @ 5.0%
4 CY TRENCH BACKFILL

- 9 FOOT SS1 RCP CL4 15" @ 5.0%
1 CY TRENCH BACKFILL

- INLET TA T24 F&G
+32.0, 30.0' LT
TOP 530.19
INV OUT 526.29

- INLET TA T24 F&G
+67.3, 48.0' LT
TOP 530.22
INV OUT 526.26

- 11 FOOT SS1 RCP CL4 12" @ 14%
3 CY TRENCH BACKFILL

- INLET TA T3 F&G
+68.2, 70.5' LT
TOP 529.23
INV OUT 526.20

- INLET TA T3 F&G
+59.1, 66.1' LT
TOP 529.20
INV OUT 526.10

- INLET TB T3 F&G
+50.0, 62.1' LT
TOP 529.23
INV OUT 526.00

- INLET TA T3 F&G
+68.3, 26.2' LT
TOP 529.55
INV OUT 525.85

- 10 FOOT SS1 RCP CL4 12" @ 1.0%
2 CY TRENCH BACKFILL

- INLET TB T3 F&G
+59.4, 30.5' LT
TOP 529.49
INV OUT 525.75

- 10 FOOT SS1 RCP CL4
12" @ 30%
3 CY TRENCH BACKFILL

- INLET TA T3 F&G
+68.4, 27.5' RT
TOP 529.47
INV OUT 525.38

- 10 FOOT SS1 RCP CL4
12" @ 1.0%
2 CY TRENCH BACKFILL

- INLET TB T3 F&G
+59.4, 31.5' RT
TOP 529.45
INV OUT 525.28

- 10 FOOT SS1 RCP CL4 12" @ 30%
3 CY TRENCH BACKFILL

- 10 FOOT STORM
SEWER REMOVAL

- 14+20 LT
1 EACH REMOVE INLETS

- 41 FOOT SS1 RCP CL4
12" @ 1.0%
9 CY TRENCH BACKFILL