

24 2-2 MASSAC, ILL. 32 26

WORK TO BE PERFORMED DURING PHASE A
 OR PHASE B

Top Flange Splice Plate

1. Cut the floorbeam web & stiffeners as required*
2. Install the Retrofit Splice PL.

Bottom Flange Splice PL.

1. Remove the horizontal Connection PL(s) welded to edge of bottom flange.*
2. Remove "TEE" where installed under previous contract.
3. Install the Retrofit Splice PL.
4. Install new Connection PL (where required) and reconnect bottom Gusset PL of Lateral (K) Wind Bracing.*

Inside Web Splice Plate

1. Remove vertical Connection PL welded to the inside Web.*
2. Remove the top horiz. Connection PL welded to the inside Web.*
3. Install the Retrofit Splice PL.
4. Install the Bent PL connection to the floorbeam Web.*
5. Install new angles and reconnect top Gusset PL of Lateral (K) Wind bracing.*

Outside Web Splice Plate

1. Remove Gusset PL welded to outside Web.*
2. Remove "TEE" where installed under previous contract.*
3. Install the Retrofit Splice PL.

Tie Girder Support

1. Install new Retrofit "TEE".*
2. Remove temporary support.*

* Where there is an existing retrofit "Bottom Flange Splice Plate" the bottom gusset plate of the "Lateral (K) Wind bracing" has been installed. At joints which do not require a "Bottom Flange Splice Plate" all work required to install the Lateral (K) Wind Bracing (top & bottom) shall be included with the "Inside Web Splice Plate"

* This applies only at interior panel points.

Note:

All work is divided into two Phases as follows:
 Phase A - Construction to be performed prior to allowing traffic on the bridge.
 Phase B - Construction to be performed with restricted traffic on the bridge.

Ex - Retrofit Splice PL installed under previous contract.

A - New Retrofit work to be done during Phase A.

B - New Retrofit work to be done during Phase B.

Ø - No Retrofit work required.

GR - Vertical Gusset PL supporting Tie Girder welded to outside has been removed.

AH - Access Hole has been cut in top Flange.

** - Gusset PL broken and not removed.

Ø - Existing Retrofit PL to be removed.

OR - Tie Girder supported as originally erected.

T - Tie Girder supported by a "TEE" (to be removed) installed under a previous contract.

CS - Tie Girder supported by cables attached to the floorbeam.

HS - Tie Girder supported by cables attached to a H-Beam that spans from one floorbeam to the next.

WORK REQUIRED IN PHASES A & B PLUS
 EXISTING CONDITIONS OF STRUCTURE

	UNIT II						UNIT V						
	WORK TO BE PERFORMED						WORK TO BE PERFORMED						
	Top Flange	Bottom Flange	Inside Web	Outside Web	Tie Girder Support	Existing Conditions (of Tie Girder Support)	Top Flange	Bottom Flange	Inside Web	Outside Web	Tie Girder Support	Existing Conditions (of Tie Girder Support)	
T0	US	A	A	A	A	Ø	A	A	A	A	Ø		
	DS	A	A	A	A	Ø	A	A	A	A	Ø		
T1	US	Ø	Ø	Ex	B	B	OR	Ø	B	A	A	B	OR
	DS	Ø	Ø	B	B	B	GR,T	Ø	B	B	B	B	GR,T
T2	US	Ø	B	B	B	B	OR	B	Ex	B	A	A	GR,H5
	DS	Ø	Ø	A	A	A	GR,CS	B	B	B	B	B	OR
T3	US	Ø	Ø	B	B	B	OR,CS,AH	Ø	B	B	A	B	OR,AH
	DS	A	A	B	B	A	OR	Ø	B	A	B	B	OR,AH
T4	US	Ø	Ø	B	B	B	OR	Ø	Ø	B	B	B	OR
	DS	Ø	Ø	B	B	B	GR,T	B	Ex	B	A	A	GR,H5
T5	US	Ex	B	B	A	B	OR	Ø	Ex	B	A	A	GR,H5
	DS	Ø	Ø	A	B	B	GR,CS	B	B	B	A	B	OR
T6	US	Ø	Ø	B	B	B	OR,OR,AH	Ø	Ø	B	B	B	OR
	DS	B	Ø	B	B	B	OR	Ø	Ø	B	B	B	OR
T7	US	Ø	Ø	A	Ex	A	GR,H5	Ø	B	B	B	B	OR
	DS	Ø	Ø	Ex	A	A	GR,T	Ø	Ø	B	A	A	GR,T
T8	US	Ø	Ø	B	B	B	OR	Ø	B	B	B	B	GR,T
	DS	Ø	Ø	B	B	B	GR,CS	A	A	B	A	A	OR
T9	US	Ø	Ø	B	B	B	GR,T	Ø	Ø	B	B	B	OR
	DS	Ø	Ø	B	B	B	OR,AH	Ex	Ex	Ex	A	GR,H5	
T10	US	Ø	Ex	B	B	B	**H5	Ø	B	B	A	B	OR,AH
	DS	Ex	B	A	B	B	GR,T	Ø	Ø	B	A	A	GR,T,AH
T11	US	Ø	Ø	B	B	B	OR,AH	Ø	Ø	Ex	B	B	GR,T
	DS	B	A	B	A	A	OR	Ø	B	A	Ex	B	GR,H5
T12	US	Ø	Ø	B	B	B	GR,T	Ø	Ø	A	B	B	OR
	DS	Ø	Ø	A	A	A	OR	Ø	A	A	A	A	OR
T13	US	Ø	Ø	B	Ex	B	GR,H5	Ø	A	Ex	B	A	OR
	DS	Ø	Ø	B	Ex	B	GR,H5	B	B	A	Ex	B	GR,H5
T14	US	Ø	Ø	B	B	B	OR	B	B	A	A	B	GR,T
	DS	Ø	Ø	B	B	B	GR,CS,AH	Ø	Ø	B	A	A	OR
T15	US	Ø	Ø	A	A	A	GR,T	Ø	A	A	A	A	OR
	DS	Ex	B	B	A	B	OR	Ø	B	B	B	B	OR
T16	US	Ø	Ø	B	B	B	GR,CS	B	B	B	B	B	OR
	DS	B	Ø	B	A	A	GR,T	Ø	Ø	B	A	A	GR,T
T17	US	A	A	A	A			Ø	Ø	B	B	B	GR,T
	DS	A	A	A	A			B	B	B	B	B	OR
T18	US							B	A	A	A	A	OR,AH
	DS							B	A	B	A	A	OR,AH
T19	US							B	A	A	Ex	A	GR,H5
	DS							Ø	B	A	A	B	GR,T
T20	US							Ex	Ø	A	A	A	GR,T
	DS							Ø	B	A	A	B	OR
T21	US							A	A	A	A		
	DS							A	A	A	A	Ø	

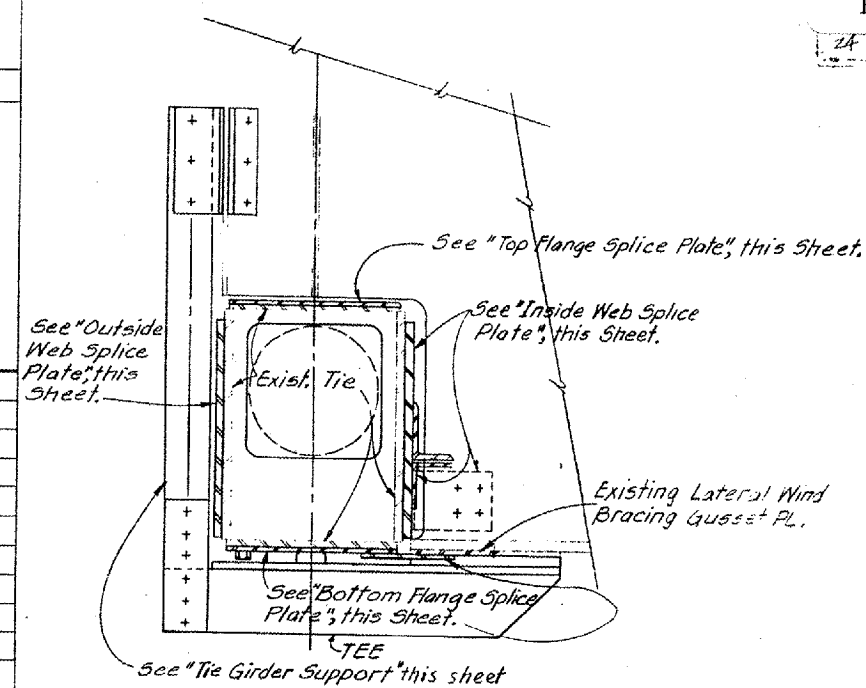

SECTION @ FLOORBEAM WITH BOTTOM FLANGE SPLICE PL. Shown at panel point without Bolted Splice, Section at Bolted Field Splice Similar.

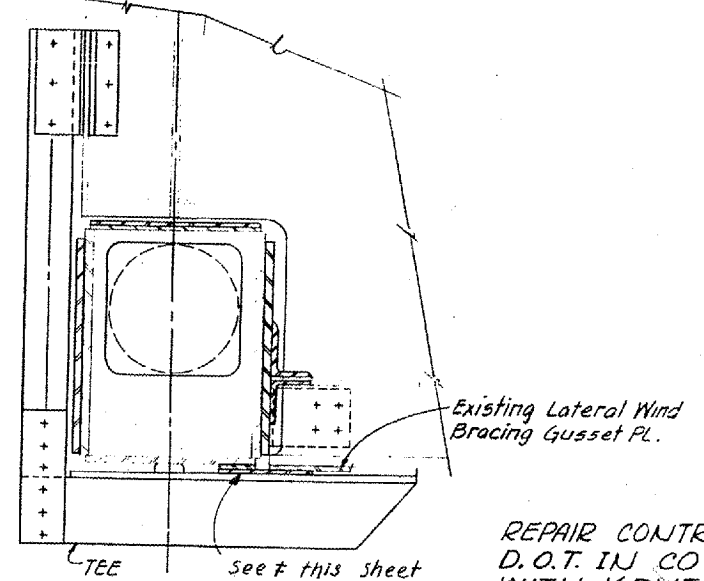

SECTION @ FLOORBEAM WITHOUT BOTTOM FLANGE SPLICE PL. Shown at panel point without Field Bolted Splice, Section at Field Bolted Splice Similar. (For callouts not shown, see "Section @ Floorbeam with Bottom Flange Splice Plate", above.)

REPAIR CONTRACT BY ILLINOIS D.O.T. IN CO-OPERATION WITH KENTUCKY D.O.T. Sheet No. 22

COMMONWEALTH OF KENTUCKY BUREAU OF HIGHWAYS ILLINOIS DEPARTMENT OF TRANSPORT. BRIDGE OVER OHIO RIVER ON I-24 BETWEEN McCRACKEN COUNTY, KY. AND MASSAC COUNTY, ILLINOIS

WORK TO BE PERFORMED & EXISTING CONDITIONS

Revised Unit II - T9, D.S. Top Flg & Bott. Flg to Ex. (7-7-80)

UPDATE DATE
 LETTING DATE

DESIGNED BY
 CHECKED BY
 DATE

DIETZEN 11-76