

**SYMBOLS**

- Work area - Auxiliary/Exit Lane
- Sign
- Type II barricades or drums with steady burning monodirectional light
- Drums with steady burning monodirectional light

Type II barricades, drums, or vertical barricades at 100' centers ( 50' centers within 200' of ramp opening ) for entire length of auxiliary / exit lane.

**GENERAL NOTES**

This detail is used where, at any time any vehicle, equipment, workers or their activities require a closure of only the auxiliary / exit lane between the Prospect, Neil, Lincoln, and Cunningham interchanges on I-74 in Champaign.

This detail must always be used in combination with detail "I-74 Auxiliary / Exit Lane Closures - Champaign - Modified 701400"

To avoid signage conflict, the existing yellow post mounted W4-3-48 "Added Lane" sign in the gore area must be covered.

When work does not exceed 3 days, pavement marking tape may be omitted.

A check barricade shall be placed in the middle of the closed auxiliary / exit lane and at the shoulder at 1000' (300 m) centers.

Traffic control devices delineating the exit ramp may be omitted if the work zone ends 500' (150 m) before the ramp opening.

All dimensions are in inches (millimeters) unless otherwise shown.

**ON-RAMP**

This Detail depicts a shortening of the normal entrance ramp. This method shall be used whenever the existing geometrics can be retained. Consideration should be given to the entering motorists' line of sight, through, between, or over the delineation devices.

**SYMBOLS**

- Work area - Auxiliary/Exit Lane
- Sign
- Type II barricades or drums with steady burning monodirectional light
- Drums with steady burning monodirectional light

Type II barricades, drums, or vertical barricades at 100' centers ( 50' centers within 200' of ramp opening ) for entire length of auxiliary / exit lane.

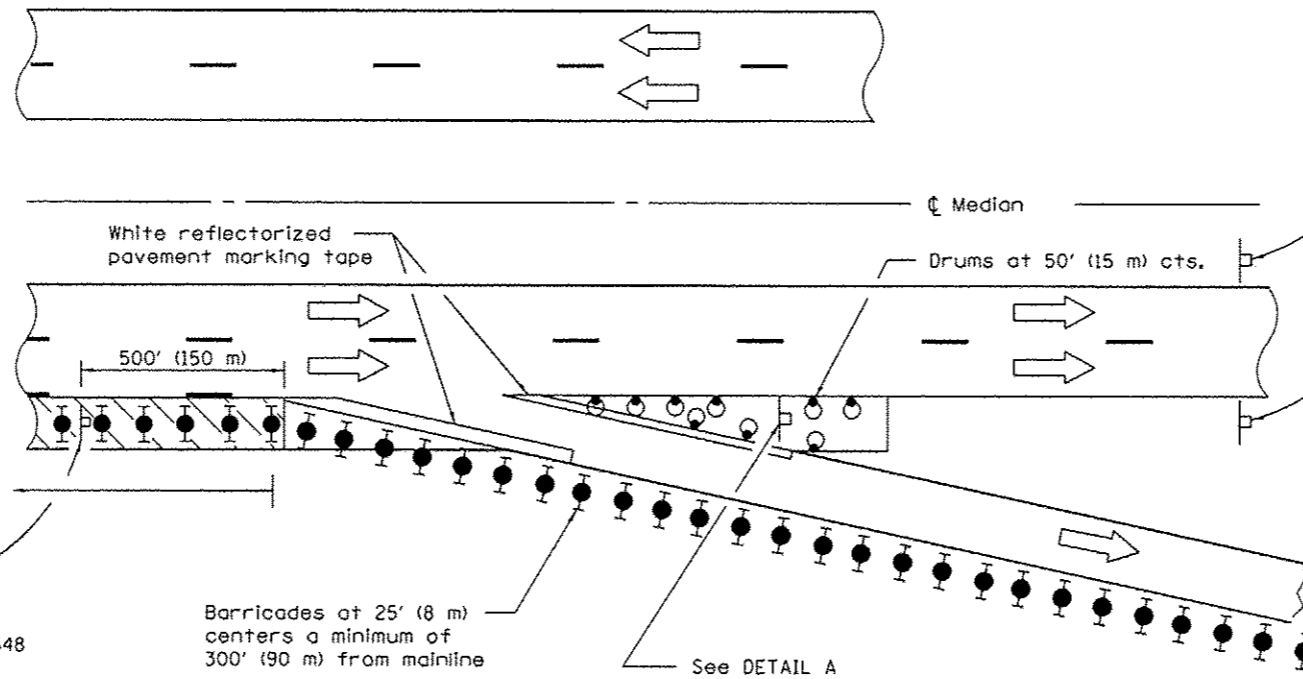

**OFF RAMP**

This Detail depicts an extension of the normal exit ramp. This method shall be used whenever existing geometrics can be retained. Consideration should be given to the exiting motorists' line of sight through, between or over the delineation devices.

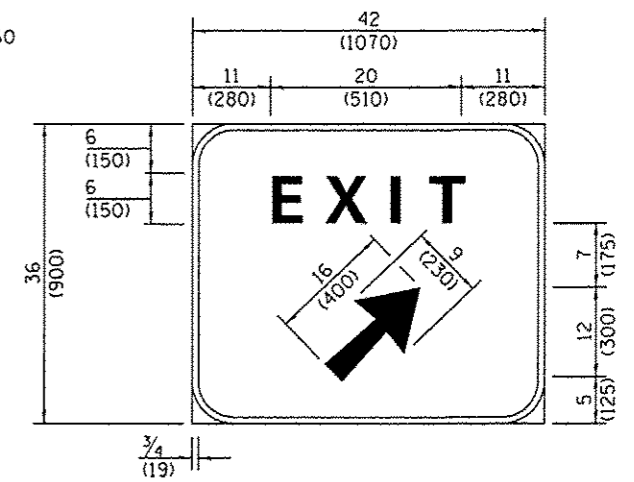

Background - Green  
Border and legend - White  
"O" size letters

EXIT SIGN - SPECIAL

**DETAIL A**

(To be utilized where distance between the two rows of channelizing devices is 6' (1.8 m) in width.)

FILE NAME =	USER NAME = bucklesj	DESIGNED -	REVISED -	<b>STATE OF ILLINOIS DEPARTMENT OF TRANSPORTATION</b>	<b>I-74 AUXILIARY /EXIT LANE CLOSURES - CHAMPAIGN SHEET 2 OF 2 - MODIFIED 701411 + 701401</b>	F.A.I. RTE.	SECTION	COUNTY	TOTAL SHEETS	SHEET NO.	
c:\pr-work\p1dot\bucklesj\0808231\056222-shr-TS.dgn	PLOT SCALE = 40x.0000 1" / in.	DRAWN -	REVISED -			74	.	CHAMPAIGN	50	13	
#MODELNAME#	PLOT DATE = 8/22/2012	CHECKED -	REVISED -			CONTRACT NO. 46222					
		DATE -	REVISED -			ILLINOIS FED. AID PROJECT					