

EARTHWORK SCHEDULE

EARTH EXCAVATION & FURNISHED EXCAVATION AND UNSUITABLE MATERIAL REMOVAL STA. 13+15.98 TO STA.36+31.80											
STATION	CUT AREA SQ. FT.	CUT VOLUME CU. YD.	FILL AREA SQ. FT.	FILL VOLUME CU. YD.	MULT. FACTOR	EXPANDED FILL VOLUME CU. YD.	TOPSOIL PLACE AREA SQ. FT.	TOPSOIL PLACE VOL. CU. YD.	UNSUITABLE REM AREA SQ. FT.	UNSUITABLE REM VOL. CU. YD.	
13+15.98	37.1	0.0	0.2	0.0	1.2	0.0	2.0	0.0	17.1	0.0	
13+50.00	44.2	51.3	0.0	0.1	1.2	0.2	3.0	3.1	19.7	23.2	
14+00.00	61.6	97.9	0.0	0.0	1.2	0.0	3.0	5.6	21.4	38.0	
14+50.00	78.3	129.5	0.3	0.2	1.2	0.3	5.3	7.7	22.0	40.1	
15+00.00	72.0	139.2	0.1	0.3	1.2	0.4	0.0	4.9	21.9	40.6	
15+50.00	66.2	128.0	0.4	0.5	1.2	0.5	0.0	0.0	22.1	40.7	
16+00.00	98.5	152.5	25.0	23.6	1.2	27.1	0.0	0.0	18.4	37.5	
16+50.00	145.1	225.5	18.7	40.4	1.2	46.5	0.0	0.0	18.6	34.2	
17+00.00	206.3	325.3	37.6	52.0	1.2	56.8	0.0	0.0	17.7	33.6	
17+50.00	280.8	451.0	29.9	62.5	1.2	71.8	0.0	0.0	17.9	32.9	
18+00.00	346.8	581.1	68.5	91.1	1.2	104.8	0.0	0.0	17.3	32.6	
18+50.00	448.8	736.6	146.0	198.6	1.2	226.4	0.0	0.0	17.3	32.1	
19+00.00	578.4	951.1	158.8	282.2	1.2	324.5	0.0	0.0	17.8	32.5	
19+50.00	699.2	1182.9	138.8	275.5	1.2	316.8	0.0	0.0	18.1	33.3	
20+00.00	1000.7	1574.0	134.9	253.4	1.2	291.5	4.1	3.8	24.4	39.3	
20+50.00	1632.4	2438.0	145.1	259.3	1.2	298.2	16.8	19.4	26.9	47.5	
21+00.00	1719.9	2966.9	346.2	455.0	1.2	523.2	0.0	15.6	20.6	44.0	
21+50.00	1558.7	2898.6	317.6	614.7	1.2	706.9	0.0	0.0	13.9	31.9	
22+00.00	1651.2	2972.1	331.1	600.7	1.2	690.8	0.0	0.0	0.1	13.0	
22+25.32	1910.9	1670.2	149.3	225.3	1.2	259.1	8.0	3.7	12.9	6.1	
22+50.00	2073.7	1821.1	0.1	68.3	1.2	78.6	49.9	26.4	66.8	36.4	
23+00.00	2746.7	4463.3	0.0	0.1	1.2	0.1	64.0	105.4	79.5	135.4	
23+50.00	2778.1	5115.6	0.0	0.0	1.2	0.0	67.8	122.0	83.3	150.7	
24+00.00	2888.3	5246.6	0.0	0.0	1.2	0.0	74.4	131.6	89.9	160.4	
24+50.00	3013.4	5464.5	0.2	0.2	1.2	0.2	89.0	151.2	104.6	180.1	
25+00.00	2714.9	5304.0	0.0	0.2	1.2	0.2	86.3	162.3	102.0	191.3	
25+50.00	2449.7	4782.1	0.0	0.0	1.2	0.0	81.8	155.7	97.3	184.5	
26+00.00	2278.9	4378.4	0.2	0.2	1.2	0.2	82.8	152.4	98.4	181.2	
26+50.00	2024.9	3985.0	0.0	0.2	1.2	0.2	80.5	151.2	96.1	180.1	
27+00.00	1735.9	3482.1	0.0	0.0	1.2	0.0	76.7	145.6	92.2	174.4	
27+50.00	1438.6	2939.3	0.0	0.0	1.2	0.0	70.6	136.4	86.1	165.1	
28+00.00	1092.0	2343.1	0.0	0.0	1.2	0.0	62.4	123.1	77.9	151.8	
28+50.00	795.4	1747.5	0.0	0.0	1.2	0.0	55.2	108.8	70.5	137.4	
29+00.00	551.7	1247.3	0.0	0.0	1.2	0.0	48.2	95.7	63.6	124.2	
29+50.00	471.7	947.6	0.9	0.9	1.2	1.0	42.6	84.0	58.0	112.6	
30+00.00	175.0	598.8	1.9	2.6	1.2	3.0	40.4	76.8	55.8	105.4	
30+50.00	46.6	205.3	66.1	63.0	1.2	72.4	37.2	71.8	52.6	100.4	
31+00.00	174.6	204.9	43.8	101.7	1.2	117.0	54.3	84.7	69.8	113.3	
31+50.00	87.3	242.5	31.7	69.9	1.2	80.3	38.4	85.8	53.8	114.4	
32+00.00	62.3	138.6	16.9	44.9	1.2	51.7	24.7	58.4	40.2	87.0	
32+50.00	68.5	121.1	0.0	15.6	1.2	18.0	0.0	22.9	17.5	53.4	
33+00.00	96.0	152.3	0.0	0.0	1.2	0.0	12.8	11.8	25.9	40.2	
33+50.00	82.3	165.1	0.0	0.0	1.2	0.0	11.7	22.7	23.5	45.8	
34+00.00	78.0	148.4	0.0	0.0	1.2	0.0	10.4	20.5	21.6	41.8	
34+25.00	52.2	60.3	0.0	0.0	1.2	0.0	10.3	9.6	11.5	15.3	
34+50.00	49.9	47.2	0.0	0.0	1.2	0.0	9.0	8.9	10.4	10.2	
34+75.00	45.6	44.2	0.0	0.0	1.2	0.0	8.2	7.9	9.5	9.2	
35+00.00	38.9	39.1	0.0	0.0	1.2	0.0	7.5	7.3	8.7	8.4	
35+50.00	33.4	66.9	0.0	0.0	1.2	0.0	6.8	13.3	8.1	15.6	
36+00.00	34.8	63.1	0.0	0.0	1.2	0.0	0.0	6.3	0.0	7.5	
36+31.80	20.4	32.5	0.2	0.1	1.2	0.1	10.5	6.2	11.7	6.9	
	SUBTOTAL	75269.7	SUBTOTAL	3803.3	SUBTOTAL	4373.8	SUBTOTAL	2430.5	SUBTOTAL	3673.4	
*QUANTITIES NOT IN CROSS SECTIONS (POND AREA)		25656.2		882.5	1.2	1059.0		1764.7		1764.7	
TOTAL	100925.9	TOTAL	4685.8	TOTAL	5432.8	TOTAL	4195.2	TOTAL	5438.1		

* QUANTITIES GENERATED USING GEOPAK TIN SURFACE TO SURFACE CALCULATIONS.

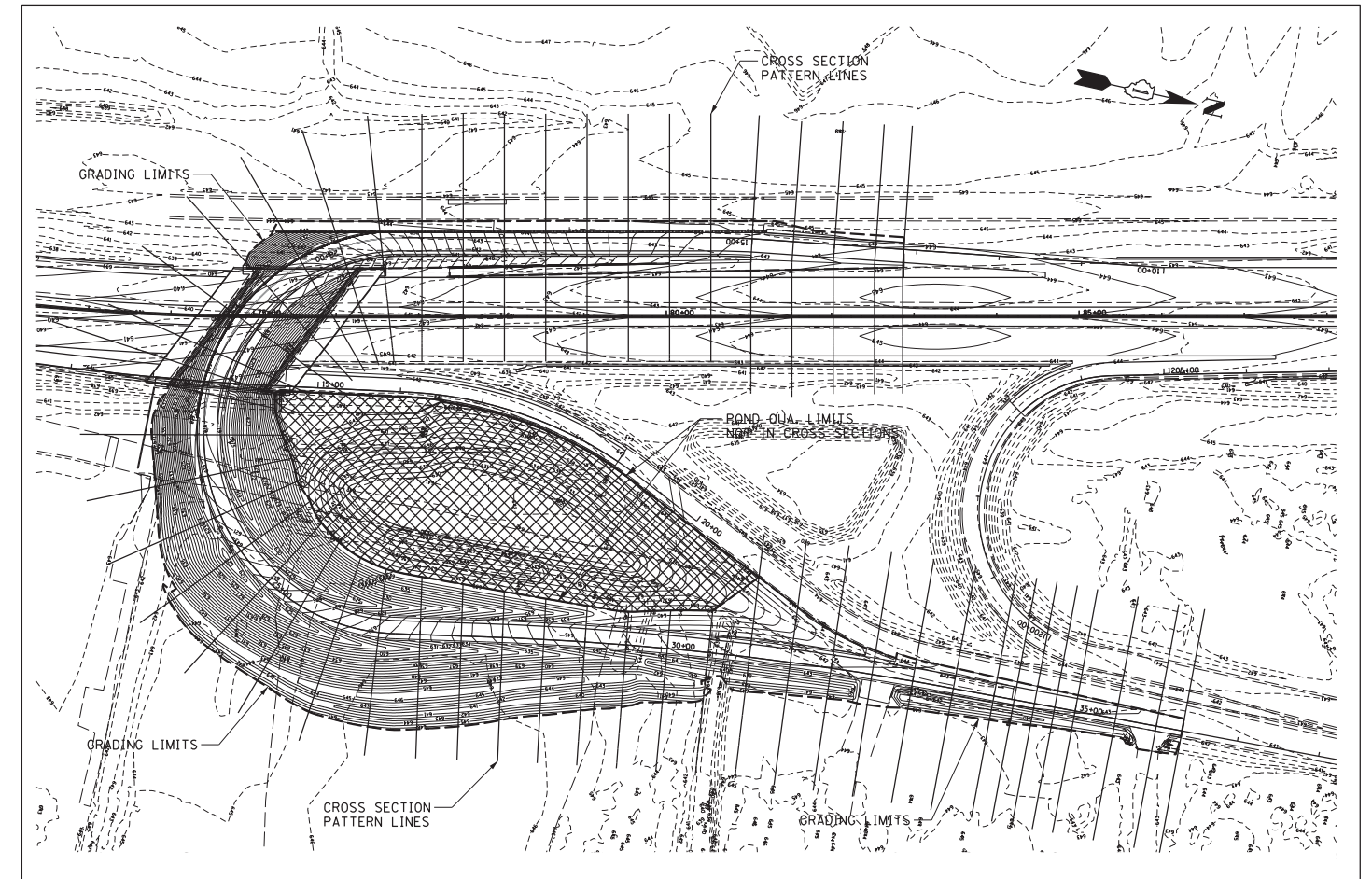

**CROSS SECTION LOCATION
N.T.S.**

NOTE:

1. "REMOVAL OF UNSUITABLE MATERIAL" INCLUDES:
 - TOPSOIL (6"DEPTH) 5438.1 C.Y.
 - 200 CY FOR REMOVAL OF POOR SOILS AT THE DIRECTION OF THE ENGINEER.
 - TOTAL REMOVAL OF UNSUITABLE MATERIAL IS 5638 C.Y.
2. A QUANTITY OF 200 C.Y. OF POROUS GRANULAR EMBANKMENT, SUBGRADE HAS BEEN INCLUDED IN THE QUANTITIES FOR THE REPLACEMENT OF POOR SOILS.