

NOTES

- SEE PAVEMENT MARKING AND SIGNING PLANS, LIGHTING PLANS, LANDSCAPING PLANS, AND TRAFFIC SIGNAL PLANS FOR ADDITIONAL REMOVALS NOT SHOWN ON THIS SHEET.
- REMOVAL AND DISPOSAL OF EXISTING SHOULDER STABILIZATION UNDER EXISTING GUARDRAIL SHALL NOT BE MEASURED FOR PAYMENT BUT SHALL BE INCLUDED IN THE COST OF SHOULDER REMOVAL.
- REMOVAL AND DISPOSAL OF EXISTING BURIED MOUNTABLE CURB SHALL NOT BE MEASURED FOR PAYMENT BUT SHALL BE INCLUDED IN THE COST OF SHOULDER REMOVAL.

REMOVAL LEGEND

- PAVEMENT REMOVAL
- SHOULDER REMOVAL
- HMA SURFACE REMOVAL, 4"
- DRAINAGE STR. ADJUSTMENT
- DRAINAGE STR. REMOVAL
- ITEM REMOVAL
- CONCRETE MEDIAN REMOVAL
- PAVED DITCH REMOVAL
- STORM SEWER REMOVAL
- LINEAR ITEM REMOVAL

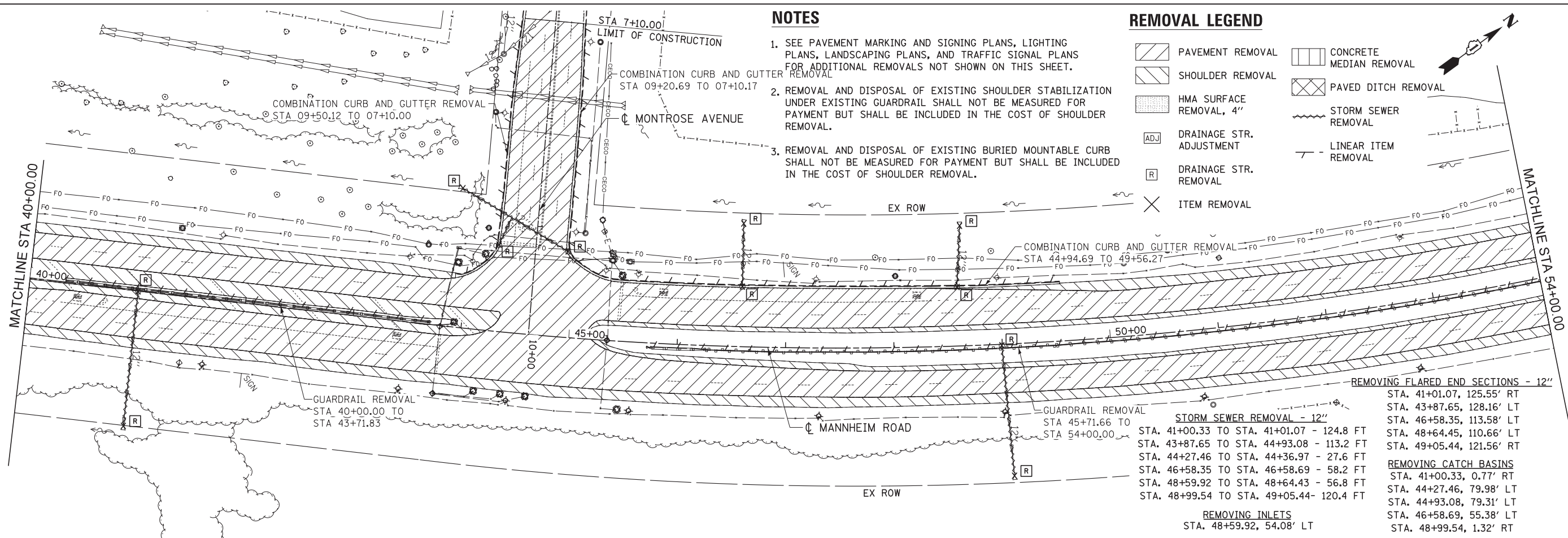

- REMOVING FLARED END SECTIONS - 12"**
 STA. 41+01.07, 125.55' RT
 STA. 43+87.65, 128.16' LT
 STA. 46+58.35, 113.58' LT
 STA. 48+64.45, 110.66' RT
 STA. 49+05.44, 121.56' RT
- STORM SEWER REMOVAL - 12"**
 STA. 41+00.33 TO STA. 41+01.07 - 124.8 FT
 STA. 43+87.65 TO STA. 44+93.08 - 113.2 FT
 STA. 44+27.46 TO STA. 44+36.97 - 27.6 FT
 STA. 46+58.35 TO STA. 46+58.69 - 58.2 FT
 STA. 48+59.92 TO STA. 48+64.43 - 56.8 FT
 STA. 48+99.54 TO STA. 49+05.44 - 120.4 FT
- REMOVING CATCH BASINS**
 STA. 41+00.33, 0.77' RT
 STA. 44+27.46, 79.98' LT
 STA. 44+93.08, 79.31' LT
 STA. 46+58.69, 55.38' LT
 STA. 48+99.54, 1.32' RT
- REMOVING INLETS**
 STA. 48+59.92, 54.08' LT

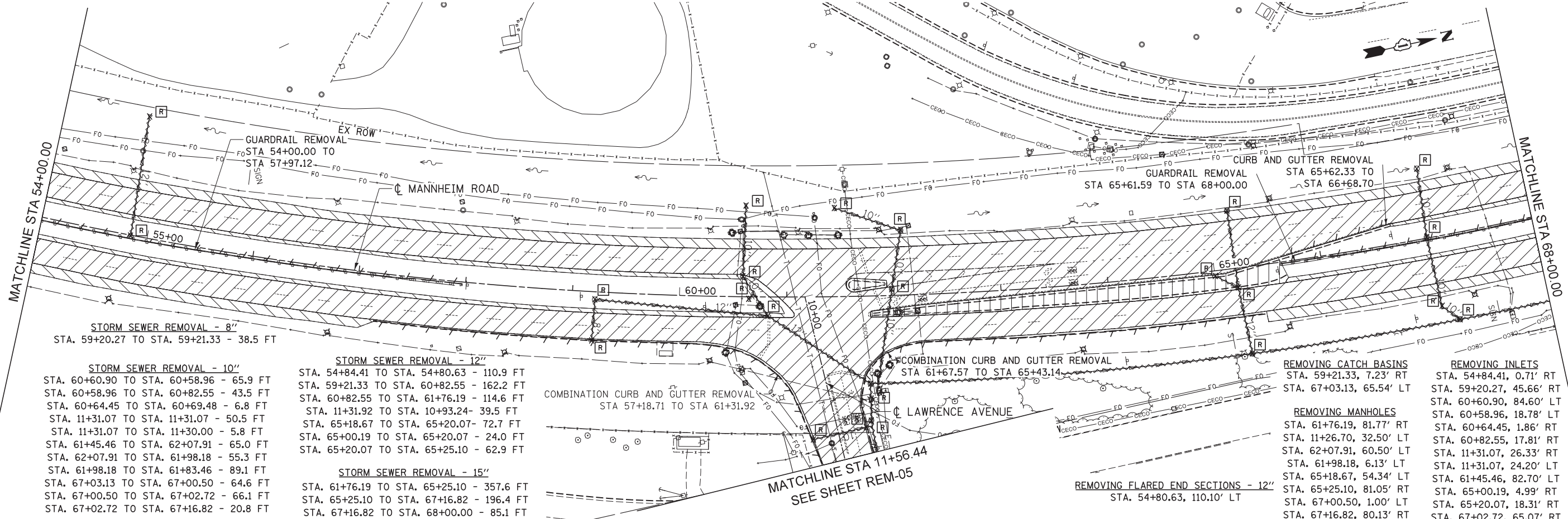

- STORM SEWER REMOVAL - 8"**
 STA. 59+20.27 TO STA. 59+21.33 - 38.5 FT
- STORM SEWER REMOVAL - 10"**
 STA. 60+60.90 TO STA. 60+58.96 - 65.9 FT
 STA. 60+58.96 TO STA. 60+82.55 - 43.5 FT
 STA. 60+64.45 TO STA. 60+69.48 - 6.8 FT
 STA. 11+31.07 TO STA. 11+31.07 - 50.5 FT
 STA. 11+31.07 TO STA. 11+30.00 - 5.8 FT
 STA. 61+45.46 TO STA. 62+07.91 - 65.0 FT
 STA. 62+07.91 TO STA. 61+98.18 - 55.3 FT
 STA. 61+98.18 TO STA. 61+83.46 - 89.1 FT
 STA. 67+03.13 TO STA. 67+00.50 - 64.6 FT
 STA. 67+00.50 TO STA. 67+02.72 - 66.1 FT
 STA. 67+02.72 TO STA. 67+16.82 - 20.8 FT
- STORM SEWER REMOVAL - 12"**
 STA. 54+84.41 TO STA. 54+80.63 - 110.9 FT
 STA. 59+21.33 TO STA. 60+82.55 - 162.2 FT
 STA. 60+82.55 TO STA. 61+76.19 - 114.6 FT
 STA. 11+31.92 TO STA. 10+93.24 - 39.5 FT
 STA. 65+18.67 TO STA. 65+20.07 - 72.7 FT
 STA. 65+00.19 TO STA. 65+20.07 - 24.0 FT
 STA. 65+20.07 TO STA. 65+25.10 - 62.9 FT
- STORM SEWER REMOVAL - 15"**
 STA. 61+76.19 TO STA. 65+25.10 - 357.6 FT
 STA. 65+25.10 TO STA. 67+16.82 - 196.4 FT
 STA. 67+16.82 TO STA. 68+00.00 - 85.1 FT
- COMBINATION CURB AND GUTTER REMOVAL**
 STA 57+18.71 TO STA 61+31.92
- STORM SEWER REMOVAL - 12"**
 STA. 65+61.59 TO STA 68+00.00
- REMOVING CATCH BASINS**
 STA. 59+21.33, 7.23' RT
 STA. 67+03.13, 65.54' LT
- REMOVING MANHOLES**
 STA. 61+76.19, 81.77' RT
 STA. 11+26.70, 32.50' LT
 STA. 62+07.91, 60.50' LT
 STA. 61+98.18, 6.13' LT
 STA. 65+18.67, 54.34' LT
 STA. 65+25.10, 81.05' RT
 STA. 67+00.50, 1.00' LT
 STA. 67+16.82, 80.13' RT
- REMOVING FLARED END SECTIONS - 12"**
 STA. 54+80.63, 110.10' LT
- REMOVING INLETS**
 STA. 54+84.41, 0.71' RT
 STA. 59+20.27, 45.66' RT
 STA. 60+60.90, 84.60' LT
 STA. 60+58.96, 18.78' LT
 STA. 60+64.45, 1.86' RT
 STA. 60+82.55, 17.81' RT
 STA. 11+31.07, 26.33' RT
 STA. 11+31.07, 24.20' LT
 STA. 61+45.46, 82.70' LT
 STA. 65+00.19, 4.99' RT
 STA. 65+20.07, 18.31' RT
 STA. 67+02.72, 65.07' RT



USER NAME = mkosir
 PLOT SCALE = 50:1
 PLOT DATE = 19-OCT-2012

DESIGNED LLS/MMK
 DRAWN MMK
 CHECKED LLS
 DATE 10/19/12

REVISED -
 REVISED -
 REVISED -
 REVISED -

**STATE OF ILLINOIS
 DEPARTMENT OF TRANSPORTATION**

**REMOVAL PLAN
 MANNHEIM ROAD**

SCALE: 1" = 50' SHEET NO. 2 OF 6 SHEETS STA. 40+00.00 TO STA. 68+00.00

F.A.P. RTE.	SECTION	COUNTY	TOTAL SHEETS	SHEET NO.
330	0105 WRS&HB	COOK	605	59
CONTRACT NO. 60G37				

ILLINOIS FED. AID PROJECT

REM-02

FILE NAME = IP_PWP\dms47844\DI68G37-shr-rem2.dgn