

NOTES

1. SEE PAVEMENT MARKING AND SIGNING PLANS, LIGHTING PLANS, LANDSCAPING PLANS, AND TRAFFIC SIGNAL PLANS FOR ADDITIONAL REMOVALS NOT SHOWN ON THIS SHEET.
2. REMOVAL AND DISPOSAL OF EXISTING SHOULDER STABILIZATION UNDER EXISTING GUARDRAIL SHALL NOT BE MEASURED FOR PAYMENT BUT SHALL BE INCLUDED IN THE COST OF SHOULDER REMOVAL.
3. REMOVAL AND DISPOSAL OF EXISTING BURIED MOUNTABLE CURB SHALL NOT BE MEASURED FOR PAYMENT BUT SHALL BE INCLUDED IN THE COST OF SHOULDER REMOVAL.

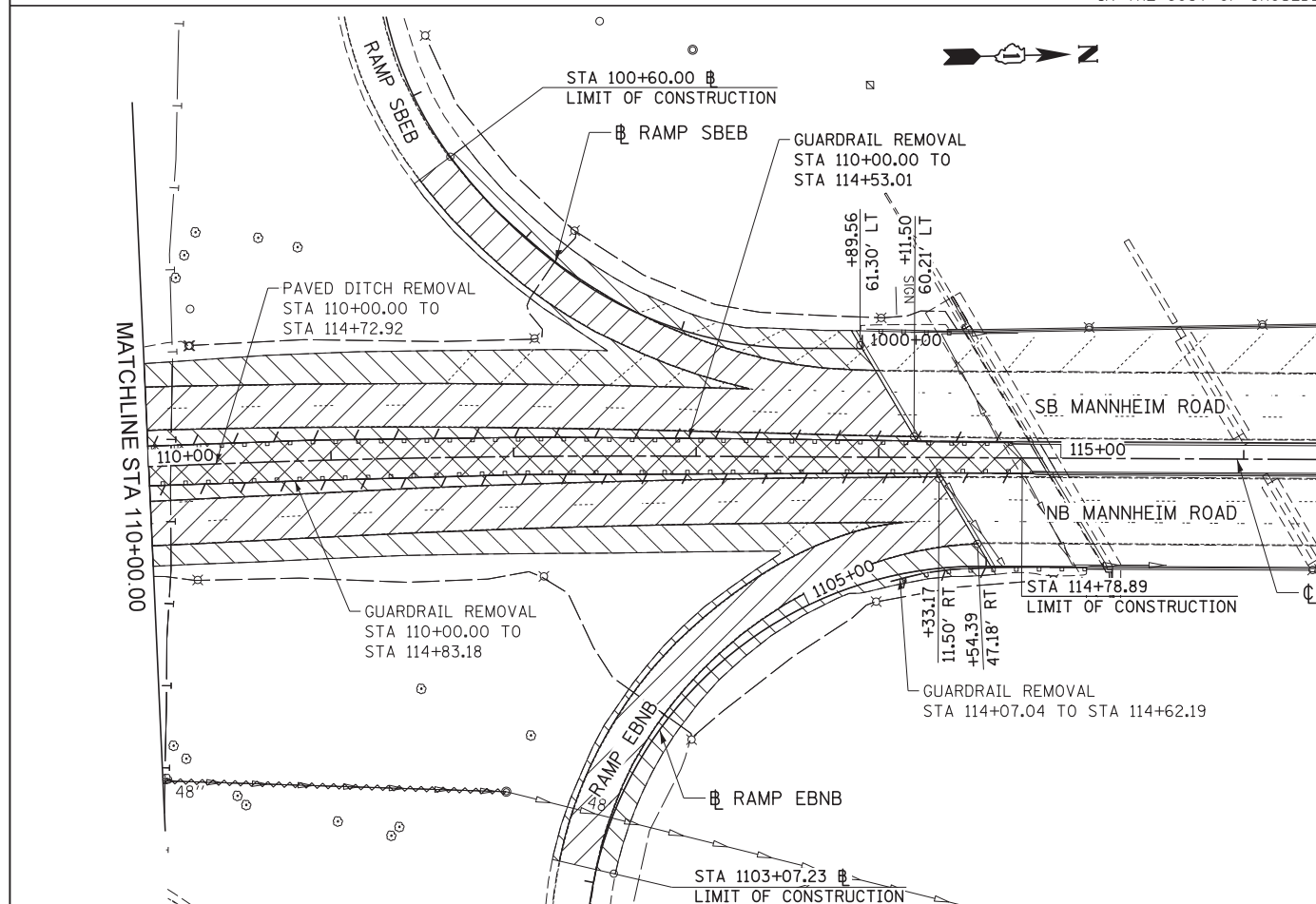

- STORM SEWER REMOVAL - 6"**
STA. 101+33.03 TO STA. 101+32.26 - 24.9 FT
- STORM SEWER REMOVAL - 8"**
STA. 96+21.70 TO STA. 95+84.53 - 37.3 FT
STA. 101+32.26 TO STA. 101+67.02 - 39.3 FT
- STORM SEWER REMOVAL - 10"**
STA. 102+42.59 TO STA. 101+67.02 - 78.0 FT
STA. 104+95.00 TO STA. 104+63.16 - 51.0 FT
STA. 104+63.16 TO STA. 103+46.16 - 117.4 FT
STA. 103+86.41 TO STA. 105+69.20 - 181.1 FT
STA. 105+69.20 TO STA. 106+16.37 - 53.3 FT
STA. 105+40.45 TO STA. 106+16.37 - 76.3 FT
STA. 107+78.54 TO STA. 107+77.06 - 63.6 FT
STA. 107+77.06 TO STA. 107+22.73 - 96.7 FT
STA. 107+22.73 TO STA. 106+39.49 - 81.8 FT
- STORM SEWER REMOVAL - 12"**
STA. 98+06.50 TO STA. 98+08.13 - 12.6 FT
STA. 98+08.13 TO STA. 98+08.19 - 26.9 FT
STA. 98+08.19 TO STA. 98+07.24 - 18.8 FT
STA. 98+07.24 TO STA. 98+08.44 - 17.9 FT
STA. 98+08.44 TO STA. 98+08.89 - 27.4 FT
STA. 98+08.89 TO STA. 98+24.21 - 24.7 FT
STA. 99+72.72 TO STA. 99+72.96 - 64.9 FT
STA. 99+72.96 TO STA. 99+73.01 - 33.8 FT
STA. 101+67.02 TO STA. 101+47.31 - 26.7 FT
STA. 101+47.31 TO STA. 101+45.81 - 27.7 FT
STA. 101+45.81 TO STA. 101+01.21 - 63.8 FT
STA. 103+46.16 TO STA. 103+28.80 - 65.8 FT
STA. 103+28.80 TO STA. 103+12.52 - 60.9 FT
STA. 106+19.85 TO STA. 106+18.75 - 26.5 FT
STA. 106+18.75 TO STA. 106+17.10 - 18.3 FT
STA. 106+17.10 TO STA. 106+16.47 - 18.4 FT
STA. 106+16.47 TO STA. 106+16.37 - 32.4 FT
STA. 106+16.37 TO STA. 106+39.49 - 70.1 FT
STA. 106+39.49 TO STA. 106+35.76 - 31.6 FT
- STORM SEWER REMOVAL - 36"**
STA. 95+74.63 TO STA. 98+24.21 - 251.0 FT
- STORM SEWER REMOVAL - 48"**
STA. 98+24.21 TO STA. 103+12.52 - 483.0 FT
STA. 103+12.52 TO STA. 107+47.85 - 428.9 FT
STA. 107+47.85 TO STA. 111+93.90 - 433.5 FT

REMOVAL LEGEND

- PAVEMENT REMOVAL
- SHOULDER REMOVAL
- HMA SURFACE REMOVAL, 4"
- DRAINAGE STR. ADJUSTMENT
- DRAINAGE STR. REMOVAL
- CONCRETE MEDIAN REMOVAL
- PAVED DITCH REMOVAL
- STORM SEWER REMOVAL
- LINEAR ITEM REMOVAL
- ITEM REMOVAL

REMOVING INLETS

- STA. 98+08.13, 45.67' LT
- STA. 98+08.19, 18.75' LT
- STA. 98+08.44, 17.78' RT
- STA. 99+72.72, 18.12' LT
- STA. 103+46.16, 18.86' LT
- STA. 104+63.16, 19.00' LT
- STA. 105+40.45, 63.50' RT
- STA. 106+19.85, 45.61' LT
- STA. 106+18.75, 19.10' LT
- STA. 107+78.54, 19.27' LT

REMOVING CATCH BASINS

- STA. 98+06.50, 58.14' LT
- STA. 104+95.00, 58.80' LT

REMOVING MANHOLES

- STA. 96+21.70, 55.65' LT
- STA. 98+07.24, 0.00' LT
- STA. 98+08.89, 44.98' RT
- STA. 99+72.96, 46.81' RT
- STA. 101+32.26, 18.39' LT
- STA. 101+67.02, 0.00' LT
- STA. 101+47.31, 18.11' RT
- STA. 101+45.81, 45.49' RT
- STA. 102+42.59, 19.24' LT
- STA. 103+12.52, 103.39' RT
- STA. 103+28.80, 44.60' RT
- STA. 103+86.41, 59.60' RT
- STA. 106+16.47, 17.59' RT
- STA. 106+16.37, 50.00' RT
- STA. 106+17.10, 0.80' LT
- STA. 105+69.20, 75.70' RT
- STA. 106+39.49, 116.38' RT
- STA. 107+22.73, 124.60' RT
- STA. 107+47.85, 158.81' RT
- STA. 107+77.06, 44.24' RT



USER NAME = mikosir	DESIGNED LLS/MMK	REVISED -
PLOT SCALE = 50:1	DRAWN MMK	REVISED -
PLOT DATE = 19-OCT-2012	CHECKED LLS	REVISED -
	DATE 10/19/12	REVISED -

STATE OF ILLINOIS
DEPARTMENT OF TRANSPORTATION

**REMOVAL PLAN
MANNHEIM ROAD**

SCALE: 1" = 50' SHEET NO. 3 OF 6 SHEETS STA. 96+00.00 TO STA. EOP

F.A.P. RTE.	SECTION	COUNTY	TOTAL SHEETS	SHEET NO.
330	0105 WRS&HB	COOK	605	61
CONTRACT NO. 60G37				
ILLINOIS FED. AID PROJECT				

REM-04