

PLAN	SURVEYED	DATE
	PLOTTED	BY
	GRADES CHECKED	
	STRUCTURE NOTATIONS CHD	
	NOTE BOOK NO.	
	CHECKED	
	DATE	
	FILE NAME	

PROFILE	SURVEYED	DATE
	PLOTTED	BY
	GRADES CHECKED	
	STRUCTURE NOTATIONS CHD	
	NOTE BOOK NO.	
	CHECKED	
	DATE	
	FILE NAME	

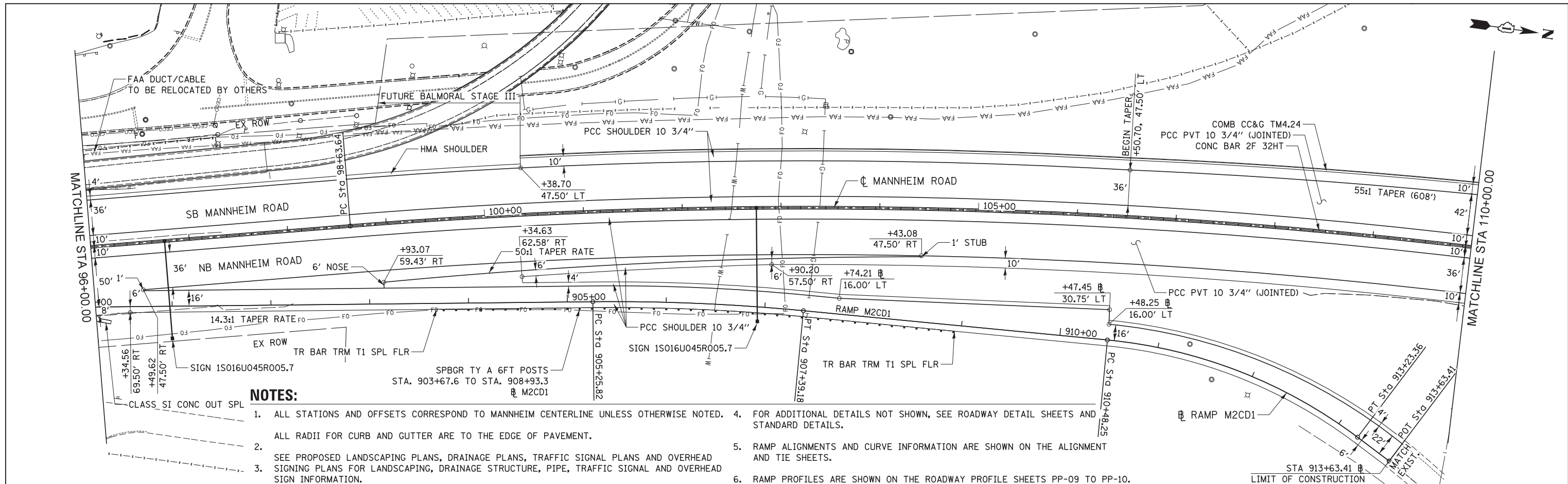

NOTES:

- ALL STATIONS AND OFFSETS CORRESPOND TO MANNHEIM CENTERLINE UNLESS OTHERWISE NOTED.
- ALL RADII FOR CURB AND GUTTER ARE TO THE EDGE OF PAVEMENT.
- SEE PROPOSED LANDSCAPING PLANS, DRAINAGE PLANS, TRAFFIC SIGNAL PLANS AND OVERHEAD SIGNING PLANS FOR LANDSCAPING, DRAINAGE STRUCTURE, PIPE, TRAFFIC SIGNAL AND OVERHEAD SIGN INFORMATION.
- FOR ADDITIONAL DETAILS NOT SHOWN, SEE ROADWAY DETAIL SHEETS AND STANDARD DETAILS.
- RAMP ALIGNMENTS AND CURVE INFORMATION ARE SHOWN ON THE ALIGNMENT AND TIE SHEETS.
- RAMP PROFILES ARE SHOWN ON THE ROADWAY PROFILE SHEETS PP-09 TO PP-10.

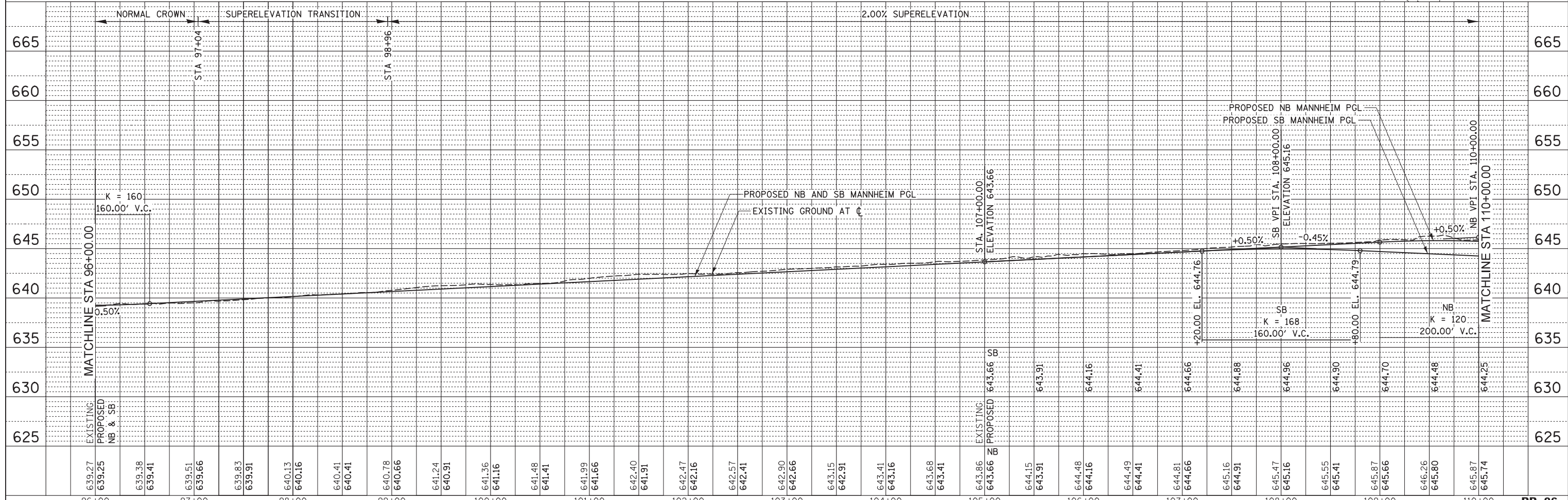

USER NAME = mikosir
 DRAWN MMK
 CHECKED LLS
 DATE 10/19/12

DESIGNED LLS/MMK
 REVISIONS
 REVISIONS
 REVISIONS
 REVISIONS

STATE OF ILLINOIS
 DEPARTMENT OF TRANSPORTATION

PLAN AND PROFILE
 MANNHEIM ROAD
 SCALE: 1" = 50'
 SHEET NO. 6 OF 12 SHEETS
 STA. 96+00.00 TO STA. 110+00.00

F.A.P. RTE.	SECTION	COUNTY	TOTAL SHEETS	SHEET NO.
330	0105 WRS&HB	COOK	605	69
CONTRACT NO. 60637				
ILLINOIS FED. AID PROJECT				