

MAINTENANCE OF TRAFFIC LEGEND

	WORK AREA		TRAFFIC DIRECTION		ARROW BOARD		PVT MK - LINE 4" WHITE		PVT MK - LINE 24" WHITE
	TEMPORARY PAVEMENT (TO BE CONSTRUCTED IN CURRENT STAGE)		BARRICADE, TYPE III, W/ TYPE A BI-DIRECTIONAL FLASHING LIGHT		DOUBLE VERTICAL PANEL		PVT MK - LINE 4" YELLOW		PVT MK - LINE 8" WHITE
			TYPE II BARRICADES OR DRUMS W/ TYPE C STEADY BURN LIGHT		PROPOSED SIGN		PVT MK - DBL 4" YELLOW		TEMP PVT MK (SEE GENERAL NOTES SHT G-03)
			TYPE B MONO-DIRECTIONAL FLASHING LIGHT		TEMPORARY CONCRETE BARRIER		PVT MK - LINE 6" WHITE		WET REF TEM TAPE T3 (SEE GENERAL NOTES SHT G-03)
					RAMP CLOSED		PVT MK - LINE 12"		PERM PVT MK (SEE PVT MK PLANS)
							PVT MK - LTRS & SYMB		

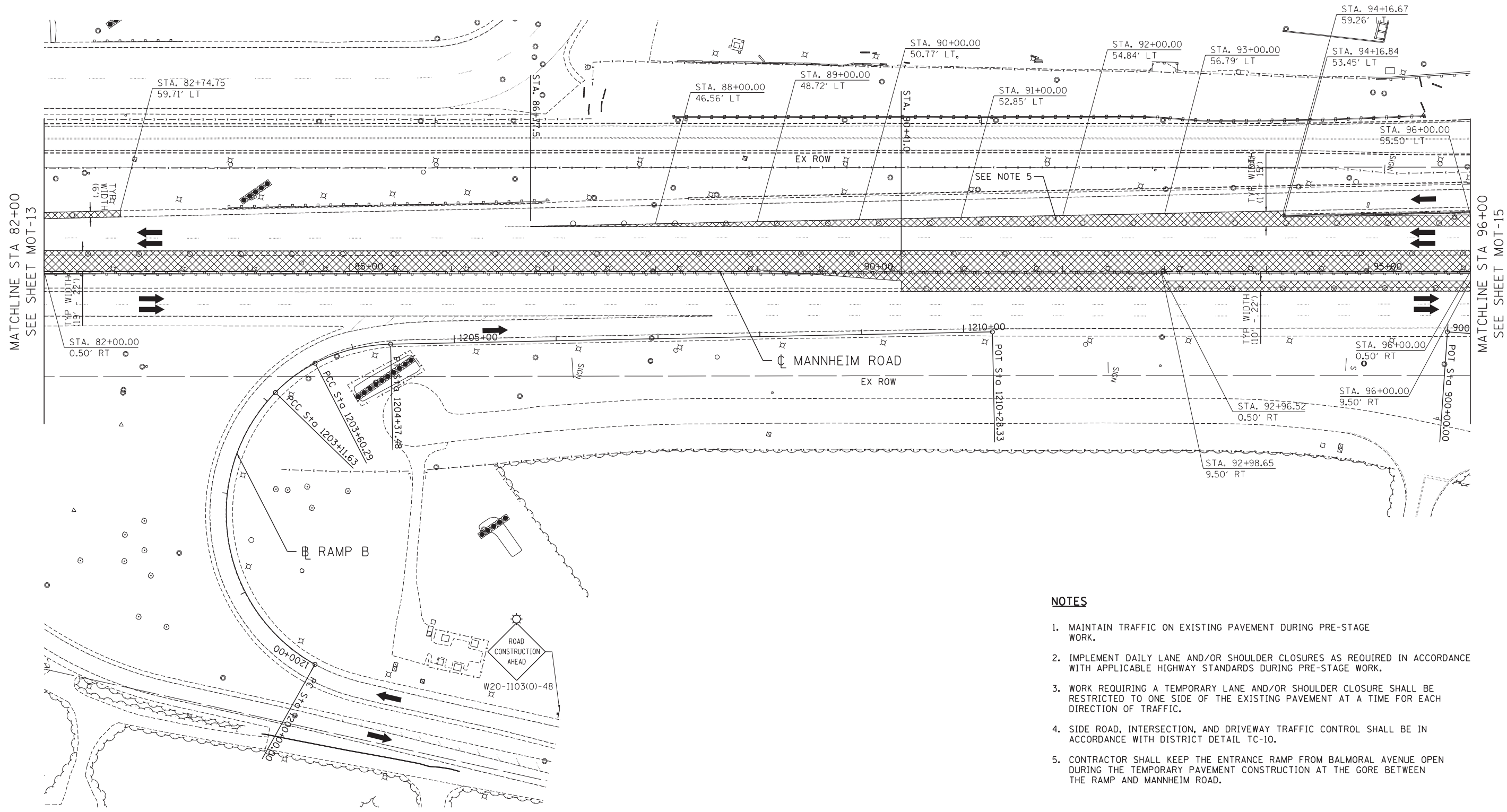

NOTES

1. MAINTAIN TRAFFIC ON EXISTING PAVEMENT DURING PRE-STAGE WORK.
2. IMPLEMENT DAILY LANE AND/OR SHOULDER CLOSURES AS REQUIRED IN ACCORDANCE WITH APPLICABLE HIGHWAY STANDARDS DURING PRE-STAGE WORK.
3. WORK REQUIRING A TEMPORARY LANE AND/OR SHOULDER CLOSURE SHALL BE RESTRICTED TO ONE SIDE OF THE EXISTING PAVEMENT AT A TIME FOR EACH DIRECTION OF TRAFFIC.
4. SIDE ROAD, INTERSECTION, AND DRIVEWAY TRAFFIC CONTROL SHALL BE IN ACCORDANCE WITH DISTRICT DETAIL TC-10.
5. CONTRACTOR SHALL KEEP THE ENTRANCE RAMP FROM BALMORAL AVENUE OPEN DURING THE TEMPORARY PAVEMENT CONSTRUCTION AT THE GORE BETWEEN THE RAMP AND MANNHEIM ROAD.

\\D:\166037-ALIGNMENT.DGN, \\D:\166037-LAYOUT.DGN, \\D:\166037-TOP.DGN, \\D:\166037-ROW.DGN, \\D:\166037-STAGING.DGN, \\D:\166037-BORDER.DGN
 10-18-2012, 13:17:59 BAJZEKJ F:\DOC\EXP\CHI-00012584-02\COMMON\SET\TEMP\SHHEE\LOT\DI6037-SHT-STAGINGP_6.DGN

FILE NAME = *FILEL*	USER NAME = *USER*	DESIGNED - BRH	REVISED -
		DRAWN - JZP	REVISED -
		CHECKED - KDA	REVISED -
		DATE - 10/19/12	REVISED -
PLOT SCALE = *SCALE*			
PLOT DATE = *DATE*			

**STATE OF ILLINOIS
DEPARTMENT OF TRANSPORTATION**

**MAINTENANCE OF TRAFFIC
PRE-STAGE**

SCALE: 1"=50' SHEET NO. OF SHEETS STA. 82+00 TO STA. 96+00

F.A. RTE.	SECTION	COUNTY	TOTAL SHEETS	SHEET NO.
	0105 WRS&HB	COOK	605	102
CONTRACT NO. 60G37				
ILLINOIS FED. AID PROJECT				

MOT-14