

**MAINTENANCE OF TRAFFIC LEGEND**

<ul style="list-style-type: none"> <li> WORK AREA</li> <li> BARRICADE, TYPE III, W/ TYPE A BI-DIRECTIONAL FLASHING LIGHT</li> <li> TYPE II BARRICADES OR DRUMS W/ TYPE C STEADY BURN LIGHT</li> <li> TYPE B MONO-DIRECTIONAL FLASHING LIGHT</li> </ul>	<ul style="list-style-type: none"> <li> TRAFFIC DIRECTION</li> <li> ARROW BOARD</li> <li> DOUBLE VERTICAL PANEL</li> <li> PROPOSED SIGN</li> <li> TEMPORARY CONCRETE BARRIER</li> <li> RAMP CLOSED</li> </ul>	<ul style="list-style-type: none"> <li> PVT MK - LINE 4" WHITE</li> <li> PVT MK - LINE 4" YELLOW</li> <li> PVT MK - DBL 4" YELLOW</li> <li> PVT MK - LINE 6" WHITE</li> <li> PVT MK - LINE 12"</li> <li> PVT MK - LTRS &amp; SYMB</li> <li> PVT MK - LINE 24" WHITE</li> <li> PVT MK - LINE 8" WHITE</li> <li> TEMP PVT MK (SEE GENERAL NOTES SHT G-03)</li> <li> WET REF TEM TAPE T3 (SEE GENERAL NOTES SHT G-03)</li> <li> PERM PVT MK (SEE PVT MK PLANS)</li> </ul>
--	---	--

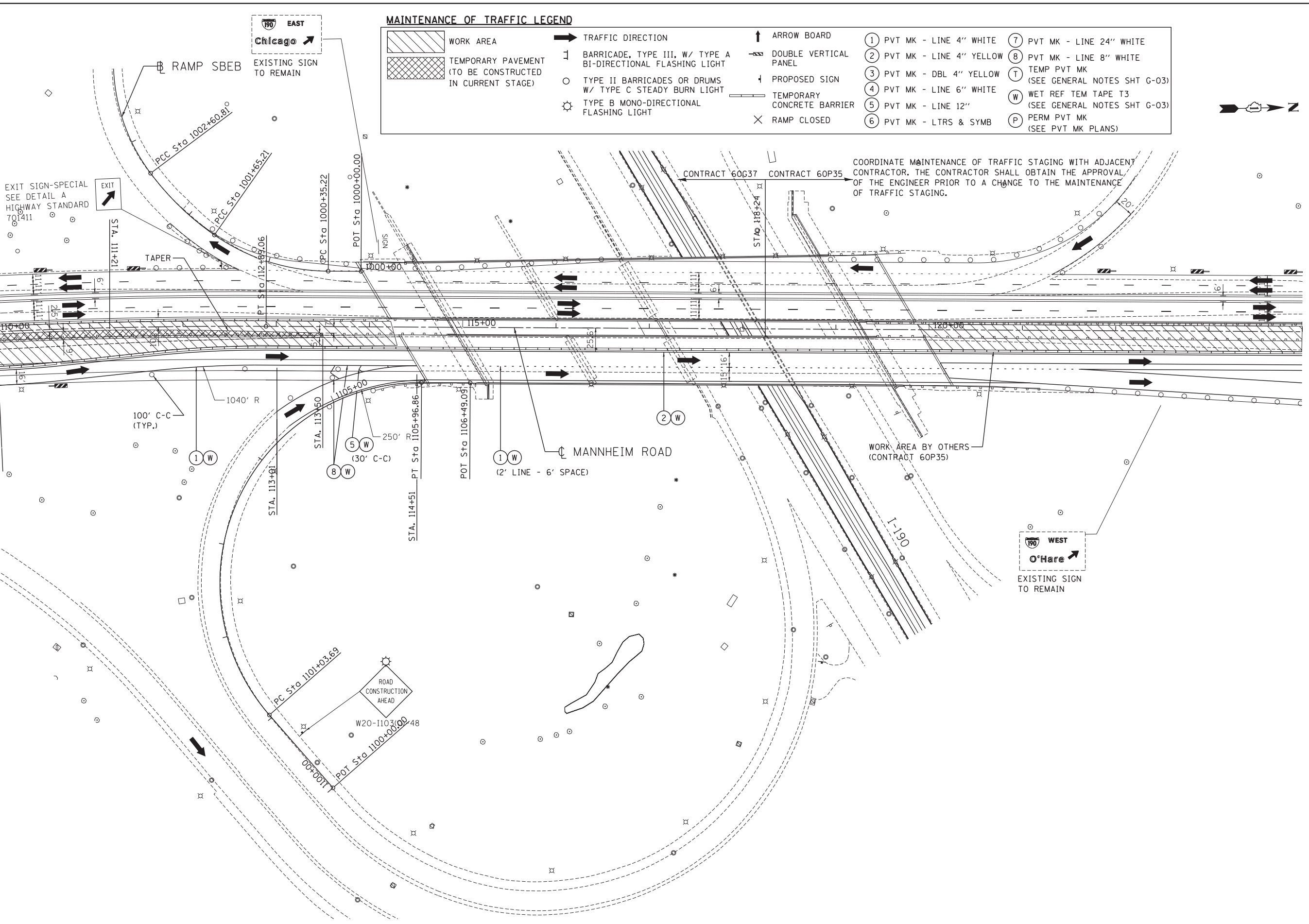

MATCHLINE STA 110+00  
SEE SHEET MOT-35



COORDINATE MAINTENANCE OF TRAFFIC STAGING WITH ADJACENT CONTRACTOR. THE CONTRACTOR SHALL OBTAIN THE APPROVAL OF THE ENGINEER PRIOR TO A CHANGE TO THE MAINTENANCE OF TRAFFIC STAGING.

WEST  
O'Hare  
EXISTING SIGN TO REMAIN

\D:\16037-ALIGNMENT.DGN, \D:\16037-LAYOUT.DGN, \D:\16037-TOPO.SIB.DGN, \D:\16037-ROW.DGN, \D:\16037-STAGINGIB.DGN, \D:\16037-STAGINGIB\_8.DGN, \D:\16037-STAGINGIB\_8.DGN, \D:\16037-BORDERT.DGN, \D:\16037-TEMPORARYSET, TEMPSHEET.PLOT, \D:\16037-SHT-STAGINGIB\_8.DGN, \D:\16037-BAJZEKKJ

<b>TENG</b> TENG & ASSOCIATES, INC. ENGINEERS/ARCHITECTS/PLANNERS CHICAGO, ILLINOIS		USER NAME = #USER* DESIGNED - BRH DRAWN - JZP CHECKED - KDA DATE - 10/19/12	REVISED - REVISED - REVISED - REVISED -	<b>STATE OF ILLINOIS DEPARTMENT OF TRANSPORTATION</b>			<b>MAINTENANCE OF TRAFFIC STAGE 1 - SUB-STAGE B</b>		F.A. RTE. SECTION COUNTY TOTAL SHEETS SHEET NO. 0105 WRS&HB COOK 605 124	
FILE NAME = #FILEL# PLOT SCALE = #SCALE* PLOT DATE = #DATE*	DATE - 10/19/12	SCALE: 1"=50' SHEET NO. OF SHEETS STA. 110+00 TO STA. EOP	CONTRACT NO. 60G37		ILLINOIS FED. AID PROJECT		MOT-36			