

\\N:\166037-ALIGNMENT.DGN, \\N:\166037-TOPO3.DGN, \\N:\166037-ROAD.DGN, \\N:\166037-STAGING3.DGN, \\N:\166037-SHT-STAGING3.LDGN, \\N:\166037-BORDER.DGN
 10-18-2012 13:19:52 BAJZEKJ F:\DOC\EXP\CHI-80812584-02\COMMON\FSET\TEMP\SHEET.PLOT\166037-SHT-STAGING3.LDGN

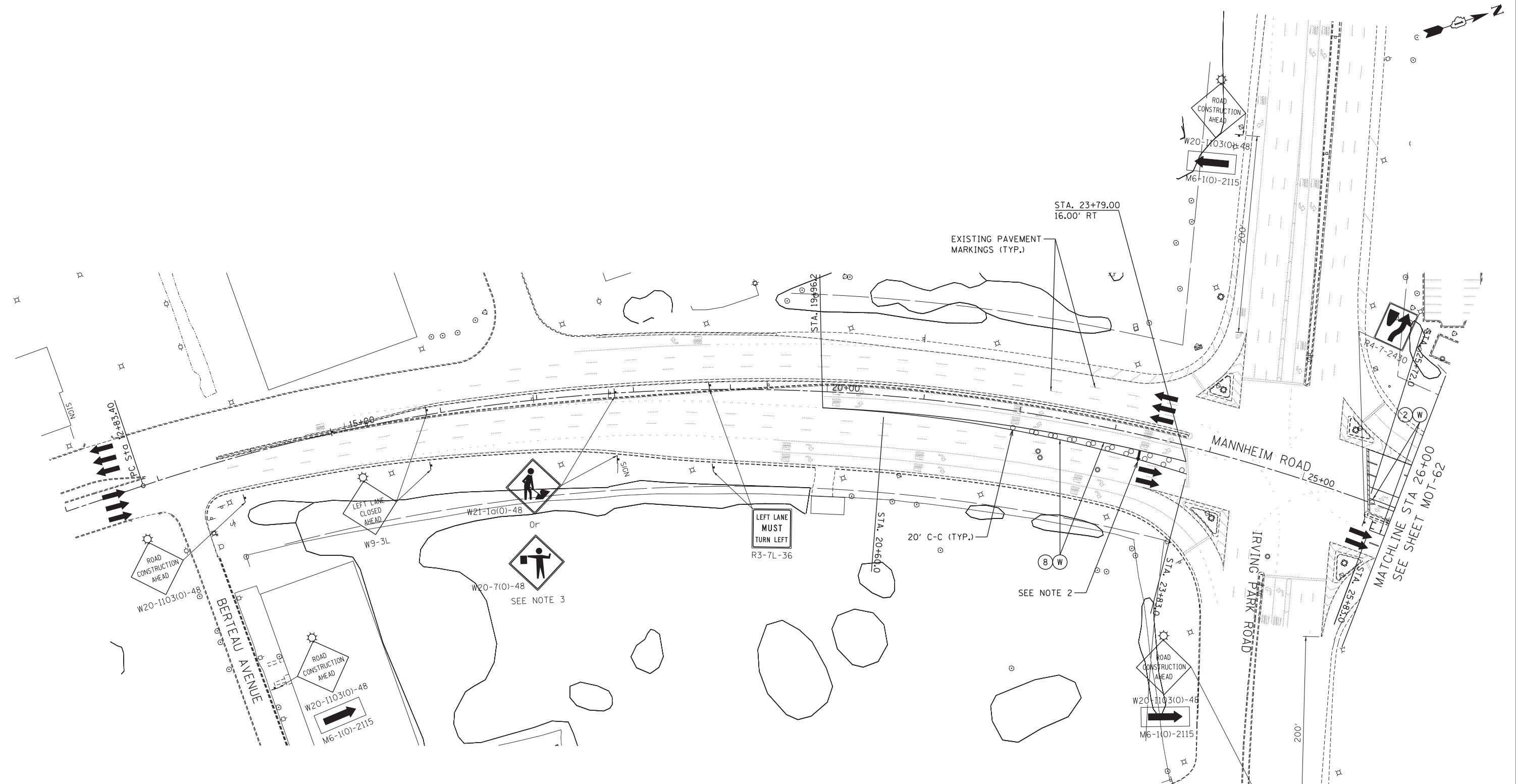

MAINTENANCE OF TRAFFIC LEGEND

| | | | | | | | | | |
|--|---|--|--|--|----------------------------|--|--|--|--|
| | WORK AREA | | TRAFFIC DIRECTION | | ARROW BOARD | | PVT MK - LINE 4" WHITE | | PVT MK - LINE 24" WHITE |
| | TEMPORARY PAVEMENT (TO BE CONSTRUCTED IN CURRENT STAGE) | | BARRICADE, TYPE III, W/ TYPE A BI-DIRECTIONAL FLASHING LIGHT | | DOUBLE VERTICAL PANEL | | PVT MK - LINE 4" YELLOW | | PVT MK - LINE 8" WHITE |
| | TYPE II BARRICADES OR DRUMS W/ TYPE C STEADY BURN LIGHT | | PROPOSED SIGN | | TEMPORARY CONCRETE BARRIER | | TEMP PVT MK (SEE GENERAL NOTES SHT G-03) | | WET REF TEM TAPE T3 (SEE GENERAL NOTES SHT G-03) |
| | TYPE B MONO-DIRECTIONAL FLASHING LIGHT | | RAMP CLOSED | | PVT MK - LINE 12" | | PERM PVT MK (SEE PVT MK PLANS) | | |
| | PVT MK - LTRS & SYMB | | | | | | | | |

NOTES:

- SIDEROAD, INTERSECTION, AND DRIVEWAY TRAFFIC CONTROL SHALL BE IN ACCORDANCE WITH DISTRICT DETAIL TC-10.
- ARROWBOARD SHALL BE PLACED WITHIN CLOSED PORTION OF LANE AT THE DOWNSTREAM END OF THE LANE CLOSURE TAPER.
- USE FLAGGER SIGN ONLY WHEN FLAGGER IS PRESENT.



TENGL & ASSOCIATES, INC.
 ENGINEERS/ARCHITECTS/PLANNERS
 CHICAGO, ILLINOIS