

RAMP CLOSURE NOTES

- 1) THE CONTRACTOR SHALL FURNISH, ERECT, MAINTAIN AND REMOVE ALL APPLICABLE SIGNS AND BARRICADES, AS DETERMINED BY THE ENGINEER, AT EXIT RAMP CLOSURES IN ACCORDANCE WITH THE REQUIREMENTS OF IDOT DISTRICT ONE DETAIL TC-08. THIS WORK WILL BE INCLUDED IN THE UNIT PRICE BID FOR TRAFFIC CONTROL AND PROTECTION (EXPRESSWAYS).
- 2) ONE CHANGEABLE MESSAGE SIGN (CMS) SHALL BE FURNISHED AND PLACED AT LOCATION AS DIRECTED BY THE ENGINEER TO ADVISE MOTORISTS OF THE RAMP CLOSURE. THE CMS SHALL BE IN OPERATION FROM TWO WEEKS PRIOR TO THE RAMP CLOSURE UNTIL THE RAMP IS REOPENED TO TRAFFIC.
- 3) ERECT OVERHEAD SIGN PANEL OVERLAY D-1 ON EXISTING OVERHEAD SIGN. THIS WORK WILL BE PAID FOR AT THE CONTRACT UNIT PRICE PER SQUARE FOOT FOR TEMPORARY INFORMATION SIGNING.

DETOUR SIGNING LEGEND:

	M4-8 (O) 24X12 (TYP)		M5-1(L)(O) 21X15		M5-1(R)(O) 21X15
	M3-3 (O) 24X12 (TYP)		M6-1(L)(O) 21X15		M6-1(R)(O) 21X15
	M1-4 (B/W) 24X24 (TYP)		M6-3(O) 21X15		
	M1-4 (B/W) 24X24 (TYP)				

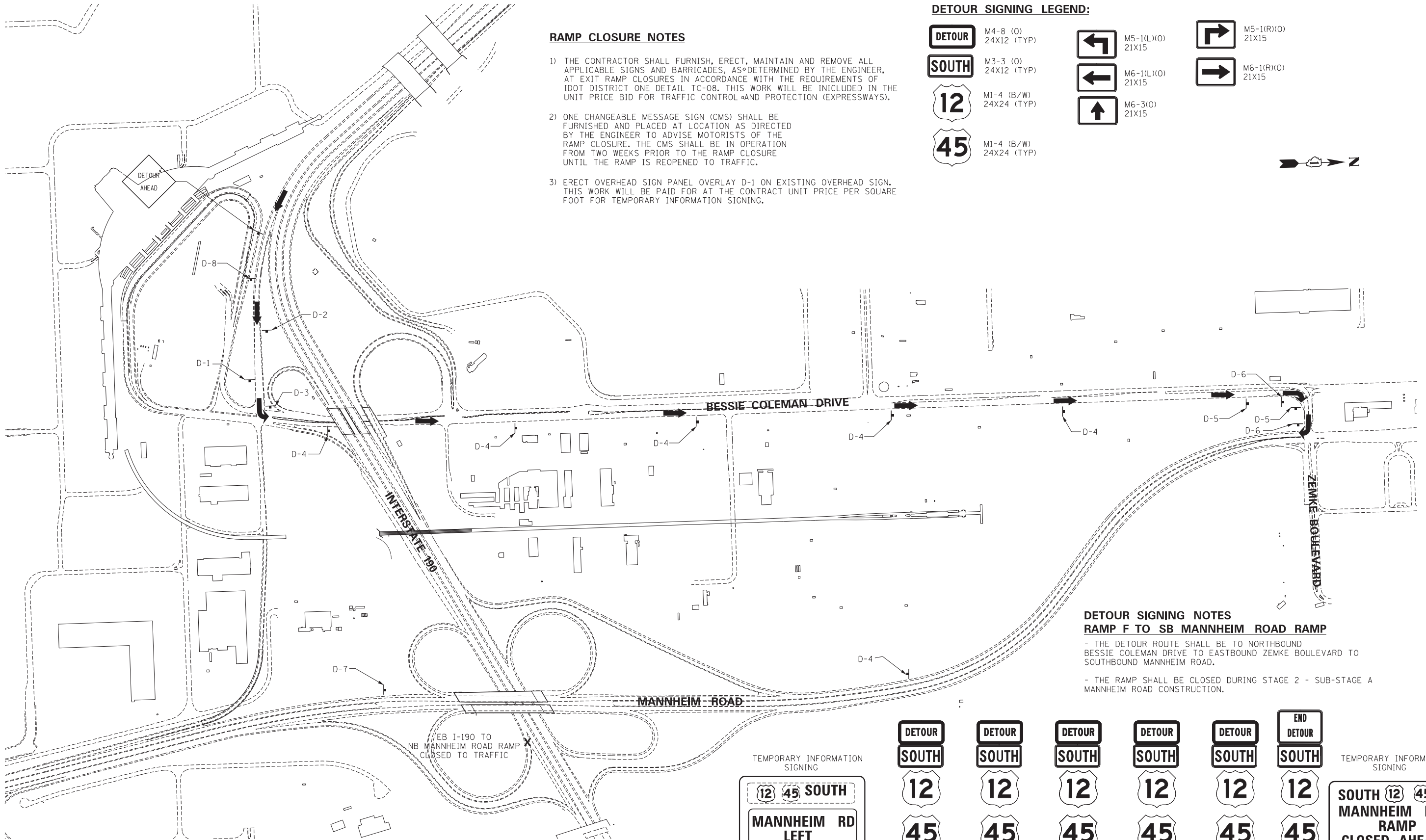

DETOUR SIGNING NOTES
RAMP F TO SB MANNHEIM ROAD RAMP

- THE DETOUR ROUTE SHALL BE TO NORTHBOUND BESSIE COLEMAN DRIVE TO EASTBOUND ZEMKE BOULEVARD TO SOUTHBOUND MANNHEIM ROAD.
- THE RAMP SHALL BE CLOSED DURING STAGE 2 - SUB-STAGE A MANNHEIM ROAD CONSTRUCTION.

TEMPORARY INFORMATION SIGNING

D-1
SEE SHEET TIS-08 FOR DETAIL

D-2 D-3 D-4 D-5 D-6 D-7

TEMPORARY INFORMATION SIGNING

D-8
SEE SHEET TIS-08 FOR DETAIL

DTR-03

N:\190-MASTER_TOP\06037-DETOUR_02.DGN...N:\190-MASTER_TOP\06037-DETOUR_06.DGN
 10-18-2012 15:25:36 BAJZEKJ F:\DOC\EXP\CHI-00012584-02\COMMON\SET\TEMP\SET\PLT\06037-SHT-DETOUR_06.DGN

FILE NAME =	USER NAME = *USER*	DESIGNED - BRH	REVISED -
FILEL		DRAWN - JZP	REVISED -
	PLOT SCALE = *SCALE*	CHECKED - KDA	REVISED -
	PLOT DATE = *DATE*	DATE - 10/19/12	REVISED -

STATE OF ILLINOIS
DEPARTMENT OF TRANSPORTATION

DETOUR PLAN			
RAMP F TO SB MANNHEIM ROAD			
SCALE: 1"=300'	SHEET NO.	OF SHEETS	STA. TO STA.

F.A. RTE.	SECTION	COUNTY	TOTAL SHEETS	SHEET NO.
	0105 WRS&HB	COOK	605	160
CONTRACT NO. 60G37				
ILLINOIS FED. AID PROJECT				

