

PLAN	SURVEYED	DATE
	PLOTTED	BY
	ALIGNED	
	CHECKED	
	DESIGNED	
	FILE NAME	
	NO.	

PROFILE	SURVEYED	DATE
	PLOTTED	BY
	GRADES CHECKED	
	STRUCTURE NOTATIONS CHKD	
	NO.	

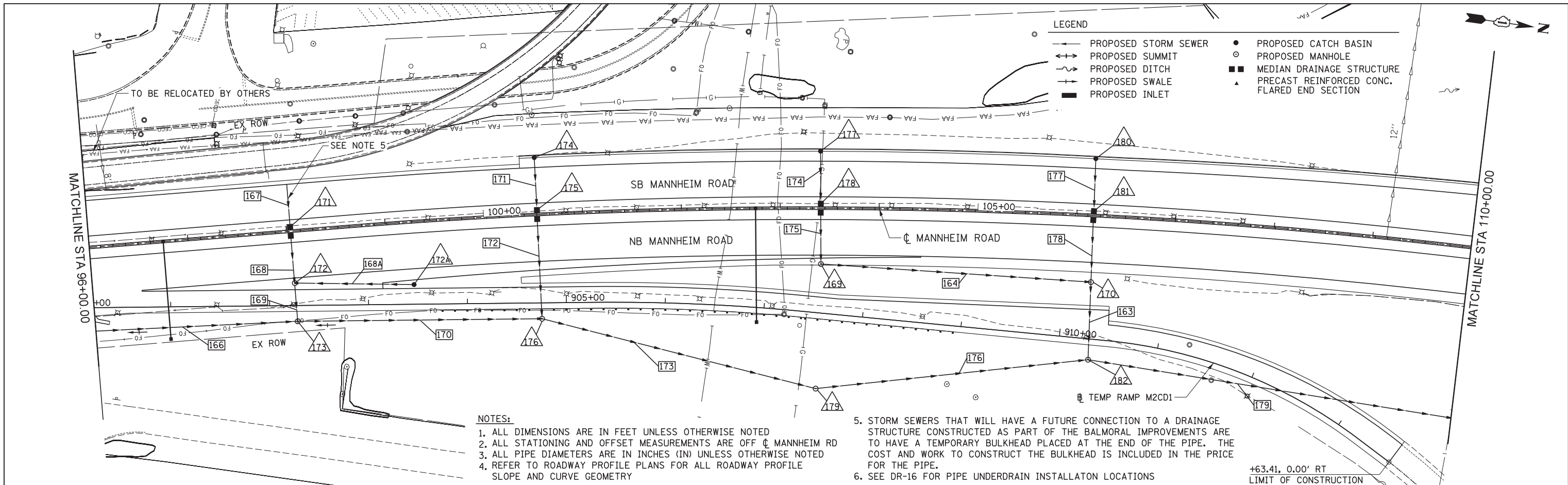

LEGEND

—●—	PROPOSED STORM SEWER	●	PROPOSED CATCH BASIN
—○—	PROPOSED SUMMIT	○	PROPOSED MANHOLE
—○—	PROPOSED DITCH	■	MEDIAN DRAINAGE STRUCTURE
—○—	PROPOSED SWALE	▲	PRECAST REINFORCED CONC. FLARED END SECTION
—	PROPOSED INLET		

- NOTES:
1. ALL DIMENSIONS ARE IN FEET UNLESS OTHERWISE NOTED
  2. ALL STATIONING AND OFFSET MEASUREMENTS ARE OFF  $\bar{C}$  MANNHEIM RD
  3. ALL PIPE DIAMETERS ARE IN INCHES (IN) UNLESS OTHERWISE NOTED
  4. REFER TO ROADWAY PROFILE PLANS FOR ALL ROADWAY PROFILE SLOPE AND CURVE GEOMETRY
  5. STORM SEWERS THAT WILL HAVE A FUTURE CONNECTION TO A DRAINAGE STRUCTURE CONSTRUCTED AS PART OF THE BALMORAL IMPROVEMENTS ARE TO HAVE A TEMPORARY BULKHEAD PLACED AT THE END OF THE PIPE. THE COST AND WORK TO CONSTRUCT THE BULKHEAD IS INCLUDED IN THE PRICE FOR THE PIPE.
  6. SEE DR-16 FOR PIPE UNDERDRAIN INSTALLATION LOCATIONS

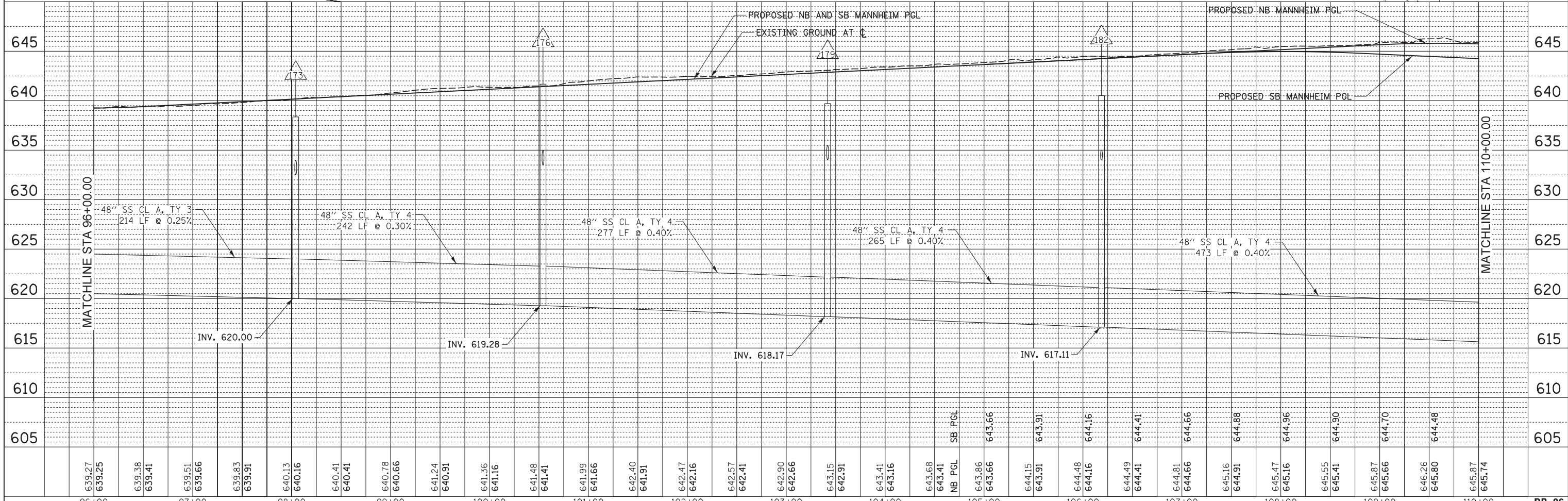

	USER NAME = mkostr	DESIGNED MAM/PMS	REVISED -	<b>STATE OF ILLINOIS</b> <b>DEPARTMENT OF TRANSPORTATION</b>	<b>DRAINAGE PLAN AND PROFILE - MANNHEIM ROAD</b>	F.A.P. RT. 330	SECTION 0105 WRS&HB	COUNTY COOK	TOTAL SHEETS 605	SHEET NO. 183
	PLOT SCALE = 50:1	CHECKED MAM	REVISED -			SCALE: 1" = 50'	SHEET NO. 6 OF 8 SHEETS	STA. 96+00.00 TO STA. 110+00.00	CONTRACT NO. 60G37	
	PLOT DATE = 19-OCT-2012	DATE 10/19/12	REVISED -			ILLINOIS FED. AID PROJECT				
	FILE NAME IP:\PWP\dms47844\DI68G37-shd-dra\mplanr\F_06.dgn									