

NOTES:

- SEE LIGHTING AND PUMP STATION PLANS FOR ALL OTHER ADDITIONAL ELECTRICAL WORK. CONTRACTOR SHALL COORDINATE ALL REMOVAL/RELOCATION WORK.
- EXCAVATE, FRAME, AND POUR CONCRETE MANHOLE AROUND EXISTING CONCRETE ENCASED DUCTS. MANHOLE SHALL INCLUDE COLLARS, FRAME, LID, LADDERS, RESTORATION AND SHALL CONFORM TO COM ED STANDARDS. PROPOSED STATIONING AND OFFSETS ARE TO CENTER OF MANHOLE. PAID FOR UNDER "SPECIAL STRUCTURE".
- CONTRACTOR SHALL INSTALL EMPTY 5" PVC DUCTS ENCASED IN CONCRETE AS SHOWN AND IN ACCORDANCE WITH COM ED STANDARDS. COM ED WILL INSTALL CABLES. UNIT PRICE FOR ENCASED DUCT SHALL INCLUDE TRENCH, BACKFILL AND RESTORATION. PAID FOR UNDER "15-WAY 15-5" PVC DUCT BANK 5 HIGH BY 3 WIDE".
- CONTRACTOR SHALL INSTALL PRECAST CONCRETE MANHOLE TYPE AS SHOWN. MANHOLE SHALL INCLUDE COLLARS, FRAME, LID, LADDERS, RESTORATION AND SHALL CONFORM TO COM ED STANDARDS. PROPOSED STATIONING AND OFFSETS ARE TO CENTER OF MANHOLE. PAID FOR UNDER "MANHOLE, SPECIAL".
- CONTRACTOR SHALL COORDINATE WITH COM ED AND INSTALL CONCRETE PADS FOR TRANSFORMERS, SECTIONALIZERS AND CONDUIT BETWEEN THEM. COM ED WILL INSTALL TRANSFORMERS AND MAKE CONNECTIONS. THE CONCRETE PADS FOR THE SECTIONALIZER AND TRANSFORMERS WILL BE PAID AT THE CONTRACT UNIT PRICE EACH FOR "CONCRETE FOUNDATIONS, SPECIAL".
- CONTRACTOR SHALL INSTALL EMPTY 5" PVC DUCTS ENCASED IN CONCRETE AS SHOWN AND IN ACCORDANCE WITH COM ED STANDARDS. COM ED WILL INSTALL CABLES. UNIT PRICE FOR ENCASED DUCTS SHALL INCLUDE TRENCH, BACKFILL, RESTORATION. PAID FOR UNDER "2-WAY 2-5" PVC DUCT BANK-1 HIGH BY 2 WIDE."

ELECTRIC UTILITY RELOCATION BILL OF MATERIALS		
ITEM	UNIT	QUANTITY
UTILITY STRUCTURE REMOVAL	EACH	1
REINFORCED CONCRETE DUCT BANK REMOVAL	FOOT	750
2-WAY 2-5" PVC DUCT BANK 1 HIGH BY 2 WIDE	FOOT	480
15-WAY 15-5" PVC DUCT BANK 5 HIGH BY 3 WIDE	FOOT	1120
SPECIAL STRUCTURE	EACH	2
MANHOLE, SPECIAL	EACH	3
CONCRETE FOUNDATIONS (SPECIAL)	EACH	1

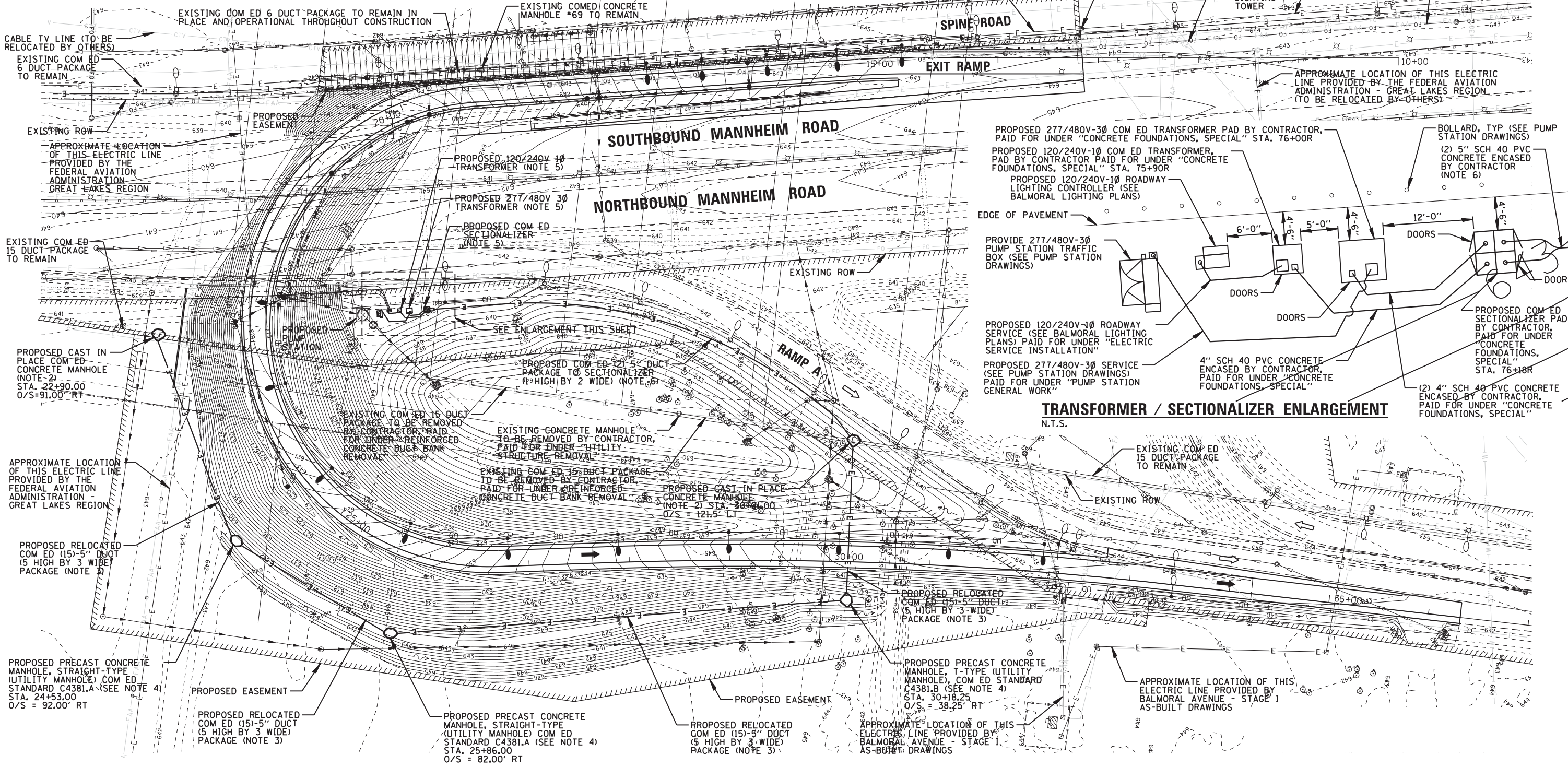
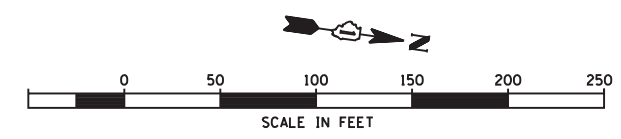

CB CHRISTOPHER B. BURKE ENGINEERING, LTD.
 9575 W. Higgins Road, Suite 600
 Rosemont, Illinois 60018
 (847) 923-0900

USER NAME = adericco
 DESIGNED GAH
 DRAWN KWB
 CHECKED AJD
 DATE 16/2012

REVISED -
 REVISED -
 REVISED -
 REVISED -

STATE OF ILLINOIS
 DEPARTMENT OF TRANSPORTATION

UTILITY RELOCATION PLAN
 COM ED ELECTRIC

SCALE: SHEET NO. OF SHEETS STA. TO STA.

F.A. RTE.	SECTION	COUNTY	TOTAL SHEETS	SHEET NO.
330	0105 WRS&HB	COOK	605	195
CONTRACT NO. 60G37				
ILLINOIS FED. AID PROJECT				