

**NOTES:**

1. TEMPORARY CIRCUITS TO BE CONNECTED TO THE EXISTING "BD" CONTROLLER. PROPOSED LIGHTING TO BE CONNECTED TO THE NEW "BD" CONTROLLER.
2. SPLICE TEMPORARY AERIAL CONDUCTORS TO EXISTING LIGHT CIRCUIT.

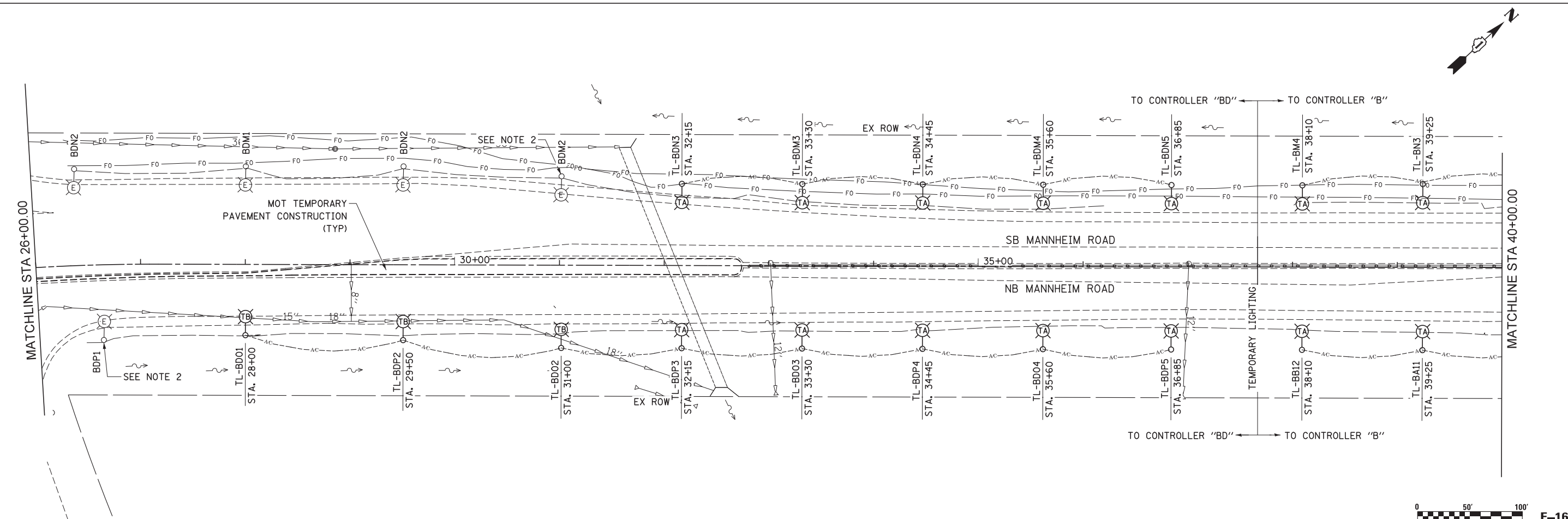

USER NAME = mksosir	DESIGNED KA	REVISED -
PLOT SCALE = 5/8"=1'	DRAWN MMK	REVISED -
PLOT DATE = 19-OCT-2012	CHECKED MCD	REVISED -
	DATE 10/19/12	REVISED -

STATE OF ILLINOIS  
DEPARTMENT OF TRANSPORTATION

**TEMPORARY LIGHTING PLAN  
PRESTAGE  
MANNHEIM ROAD**

SCALE: 1" = 50' SHEET NO. 1 OF 5 SHEETS STA. BOP TO STA. 40+00.00

F.A.P. RTE.	SECTION	COUNTY	TOTAL SHEETS	SHEET NO.
330	0105 WRS&HB	COOK	605	302
CONTRACT NO. 60G37				
ILLINOIS FED. AID PROJECT				

FILE NAME = IP\_PWP\dms47844\0160G37-shr-temp-light-prestage-01.dgn