

BILL OF MATERIAL

Bar	No.	Size	Length	Shape
d ₃₀₀ (E)	341	#5	4'-9"	J
d ₃₀₁ (E)	341	#5	4'-11"	J
e ₃₀₀ (E)	49	#5	33'-9"	—
e ₃₀₁ (E)	28	#5	29'-8"	—
t ₃₀₀ (E)	341	#6	10'-8"	U
t ₃₀₁ (E)	176	#4	4'-6"	U
t ₃₀₂ (E)	16	#5	6'-0"	—
w ₃₀₀ (E)	77	#5	33'-8"	—
w ₃₀₁ (E)	44	#5	28'-10"	—
Concrete Structures		Cu. Yd.	155.7	
Reinforcement Bars, Epoxy Coated		Pound	16,150	
Porous Granular Backfill		Cu. Yd.	65	

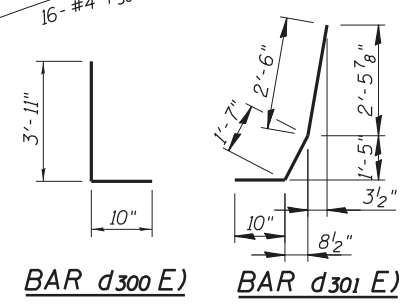

- NOTES:**
1. Reinforcement bars designated (E) shall be epoxy coated.
 2. Bars indicated thus 1 x 2-#5 etc. indicates 1 line of bars with 2 lengths per line.
 3. All corners shall have 3/4" chamfer.

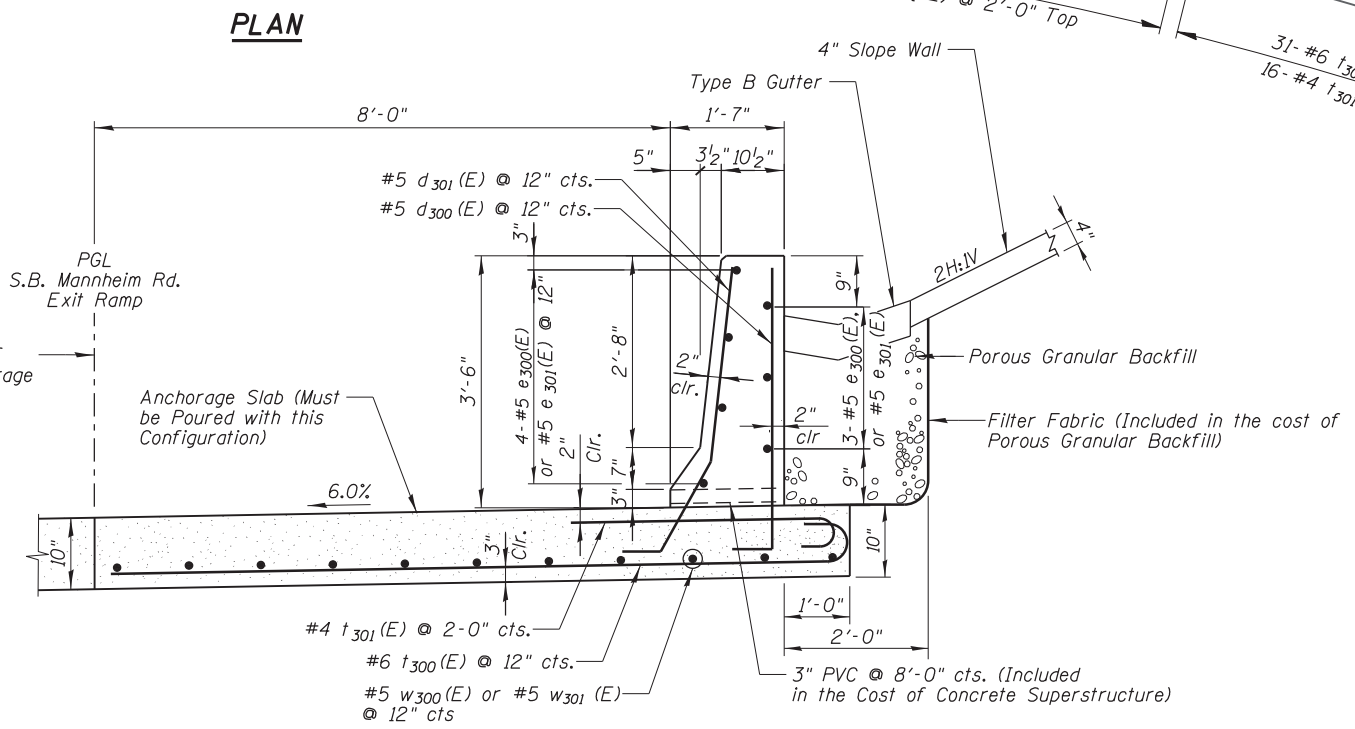

TYPICAL BARRIER WALL DETAIL

* Measured Along the Front Face of the Barrier Wall at the Base of Barrier.

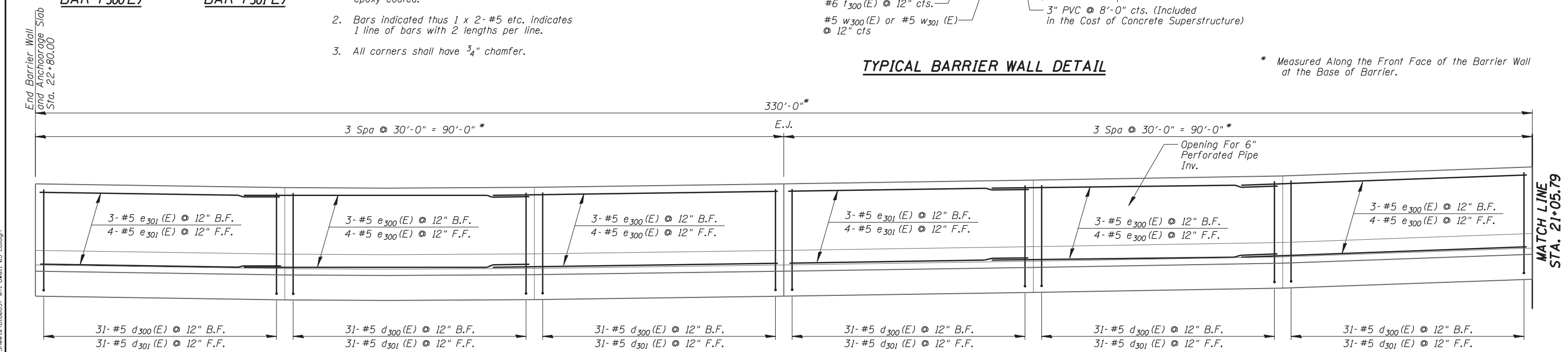

ELEVATION

N:\ROSEMONT\11000\CADD_Sheets\DI160037-sh-t-bwall-03-ceb.dgn

CHRISTOPHER B. BURKE ENGINEERING, LTD.
 8575 W. Higgins Road, Suite 600
 Rosemont, Illinois 60018
 (847) 924-8900

USER NAME =	DESIGNED - JMB	REVISED
PLOT SCALE =	CHECKED - MM	REVISED
PLOT DATE	DRAWN - PDR	REVISED
	CHECKED - MM	REVISED

**STATE OF ILLINOIS
 DEPARTMENT OF TRANSPORTATION**

**ANCHORAGE SLAB PLAN
 AND BARRIER WALL ELEVATION
 STA. 21 + 05.79 TO STA. 22 + 80.00**

F.A. RTE.	SECTION	COUNTY	TOTAL SHEETS	SHEET NO.
330	0105 WRS&HB	COOK	605	419
CONTRACT NO. 60G37				
ILLINOIS FED. AID PROJECT				

SHEET NO. S-3 OF S-3 SHEETS