

ALIGNMENT DATA

1300	N 871696.08 E 23628.71	1303	N 871407.29 E 20668.76
1301	N 871672.50 E 23329.46	1304	N 871485.00 E 20171.88
1302	N 871452.95 E 21388.38	1305	N 871693.22 E 19640.80

NOTE:

1. PLAT OF HIGHWAYS STATION EQUATION NOT APPLICABLE TO RAMP A. ALIGNMENT WAS CHANGED TO ACCOMODATE DDI DESIGN.
2. PLAT OF HIGHWAYS STATION EQUATION NOT APPLICABLE TO RAMP B, C, D, & FERRY RD.

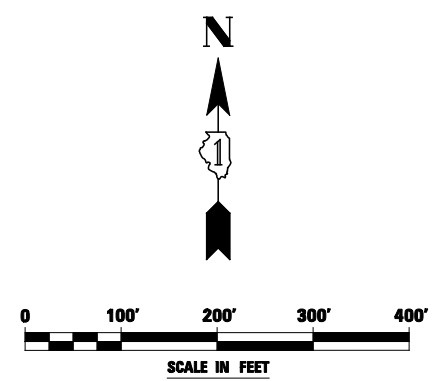
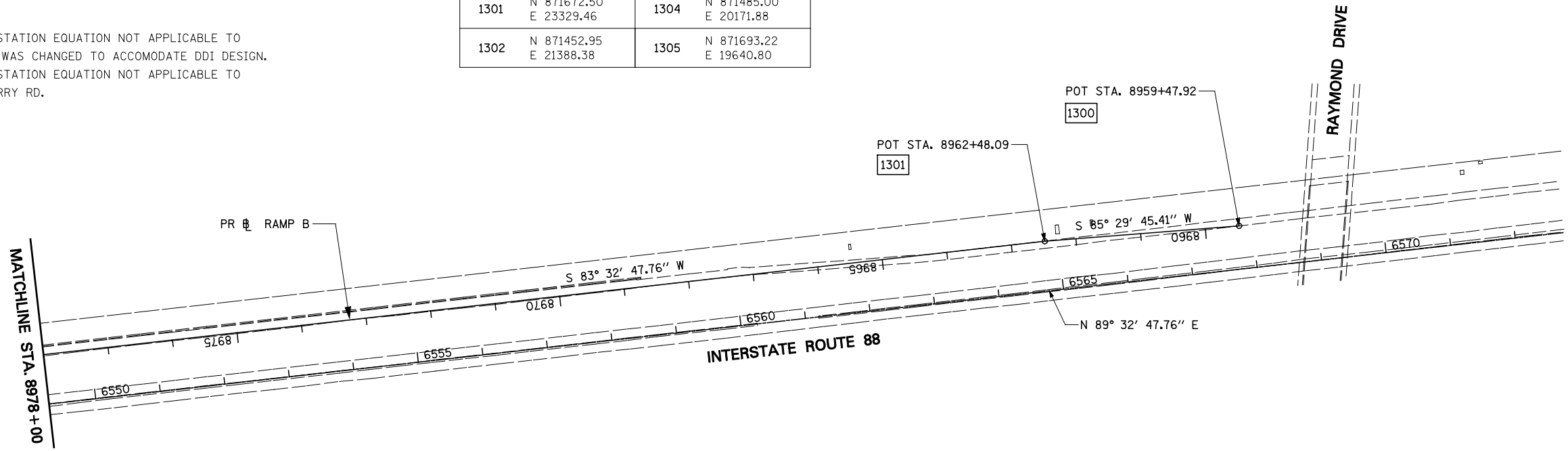

FILE NAME =	USER NAME = *USER*	DESIGNED <i>PJO</i>	REVISED -	STATE OF ILLINOIS DEPARTMENT OF TRANSPORTATION	ALIGNMENT, BENCHMARKS, AND TIES RAMP B BASELINE DATA	F.A.P. RTE.	SECTION	COUNTY	TOTAL SHEETS	SHEET NO.	
*FILEL#		DRAWN <i>KES</i>	REVISED -			338	(112 & 113) WRS-5	DUPAGE	963	81	
PLOT SCALE = *SCALE*		CHECKED <i>JCM</i>	REVISED -			CONTRACT NO. 60I31					
PLOT DATE = *DATE*		DATE <i>10/15/2012</i>	REVISED -			ILLINOIS FED. AID PROJECT					
				SCALE:		SHEET NO. 5 OF 9 SHEETS		STA. 9000+00 TO STA. 8960+52.14			