

**CONTROL POINT 436**

STA. 4038+79.94 39.71' LT.

CROSS (+) CUT ON TOP OF CURVE AT MID CURVE, SOUTHERN CURB RETURN AT ENTRANCE/EXIT TO MOBILE GAS STATION.

N 869266.8021  
E 19310.0510

ELEV. = 709.44

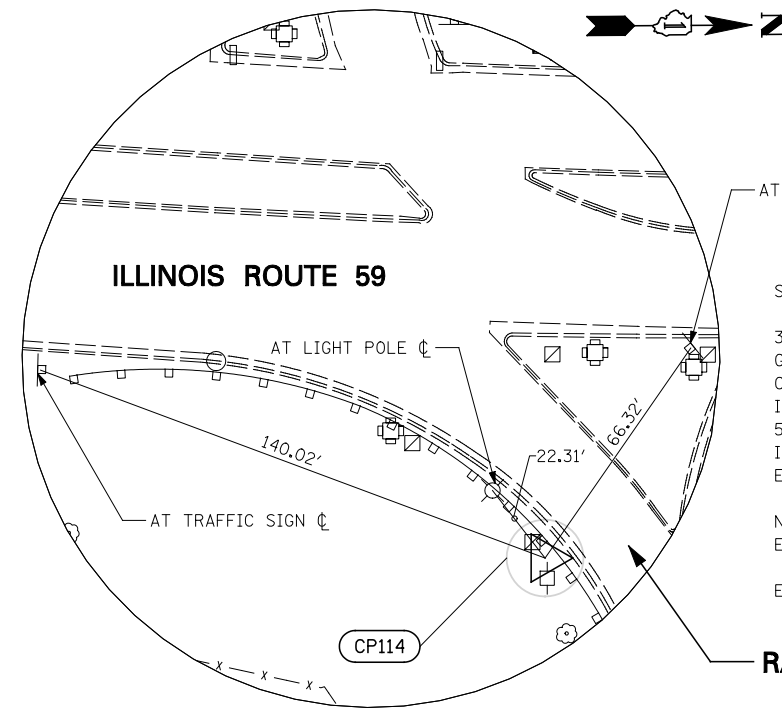

**CONTROL POINT 114**

STA. 4053+32.93 93.56' RT.

3/4" IRON PIPE W/CAP 3' SOUTHEAST ON GUARD RAIL, 5' SOUTHEAST OF EAST MID CURVE ON RTE 59 ENTRANCE RAMP TO INTERSTATE 88, 4' EAST OF HAND HOLE, 5' WEST OF POWER POLE, SOUTHEAST INTERSECTION OF RTE 59 AND EASTBOUND I-88 RAMP.

N 870675.9021  
E 19710.1510

ELEV. = 721.42

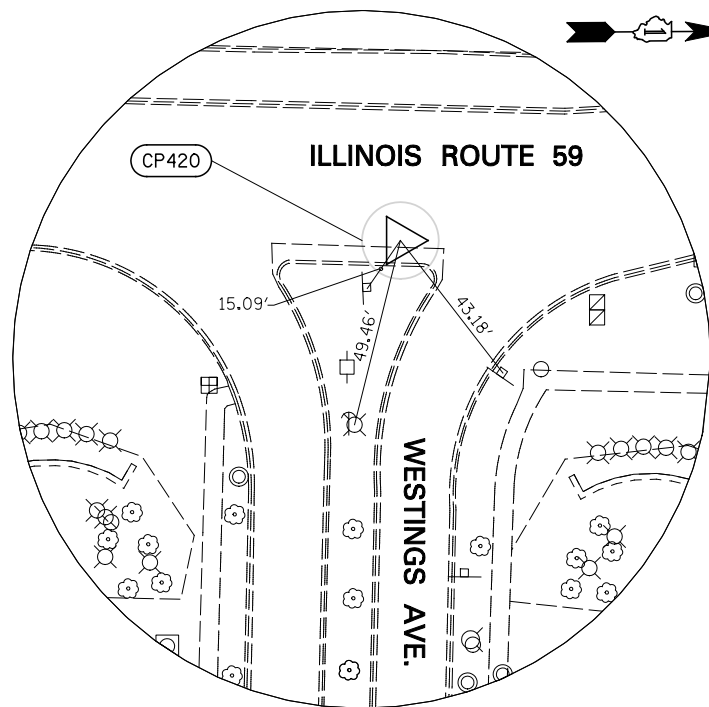

**CONTROL POINT 420**

STA. 4071+68.47 41.82' RT.

MAG NAIL 1.50' WEST OF 4' FLAG OF ISLAND, EAST SIDE OF RTE 59 AT ENTRANCE OF WESTINGS AVE, 10' SOUTH OF NORTH FLAG CORNER OF CURB.

N 872513.5010  
E 19701.7710

ELEV. = 718.10

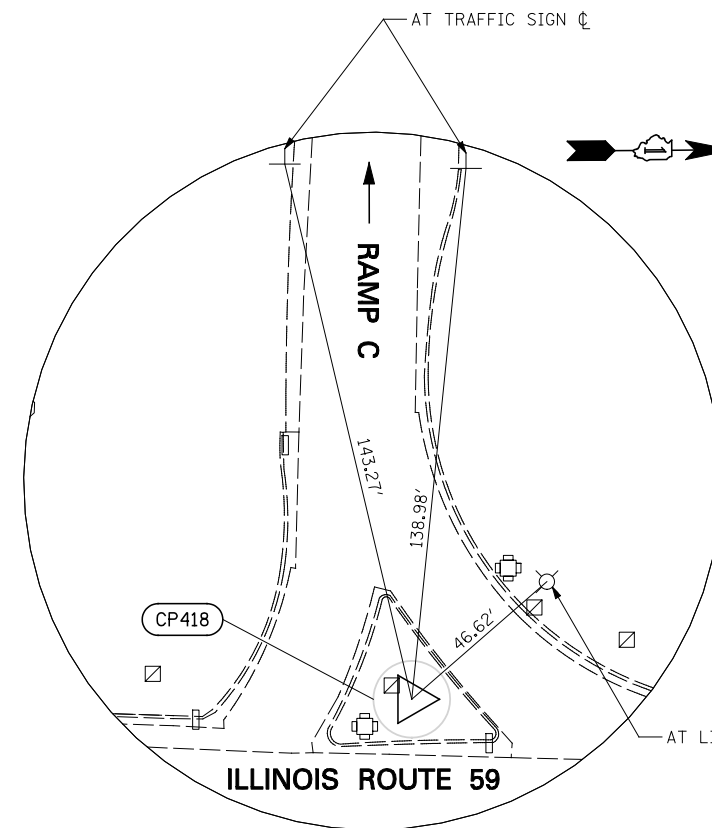

**CONTROL POINT 418**

STA. 4063+19.28 46.40' LT.

CROSS (+) CUT CENTER OF PORKCHOP ISLAND ON SOUTHBOUND RTE 59 AT RAMP TO WESTBOUND INTERSTATE 88, NORTHWEST INTERSECTION OF RTE 59 AND INTERSTATE 88.

N 871666.6010  
E 19593.7710

ELEV. = 726.60

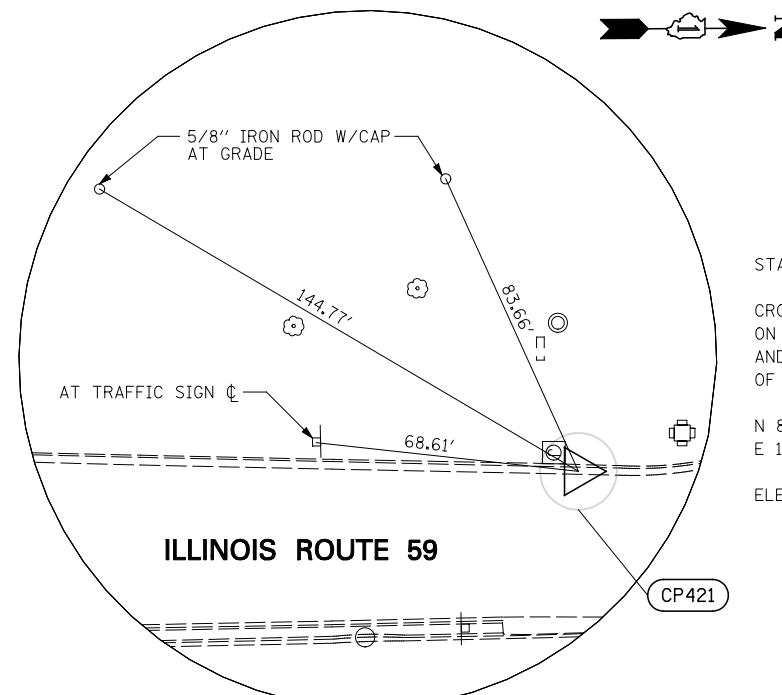

**CONTROL POINT 421**

STA. 4079+39.34 47.11' LT.

CROSS (+) CUT IN FLOW LINE OF WEST CURB ON RTE 59, SOUTHWEST CORNER OF RTE 59 AND FERRY RD, 10' SOUTH OF SOUTHERN POINT OF CURVATURE OF RTE 59 CURB.

N 873284.1010  
E 19625.5010

ELEV. = 721.79

FILE NAME =	USER NAME = #USER#	DESIGNED <i>PJO</i>	REVISED -
#FILEL#		DRAWN <i>KES</i>	REVISED -
	PLOT SCALE = #SCALE#	CHECKED <i>JCM</i>	REVISED -
	PLOT DATE = #DATE#	DATE <i>10/15/2012</i>	REVISED -

**STATE OF ILLINOIS  
DEPARTMENT OF TRANSPORTATION**

**ALIGNMENT, TIES, AND BENCHMARKS**

SCALE: SHEET NO. 8 OF 9 SHEETS STA. TO STA.

F.A.P. RTE.	SECTION	COUNTY	TOTAL SHEETS	SHEET NO.
338	(112 & 113) WRS-5	DUPAGE	963	84
CONTRACT NO. 60I31				
ILLINOIS FED. AID PROJECT				