

ADVANCE WARNING SIGN SEQUENCE DETAIL  
WESTBOUND

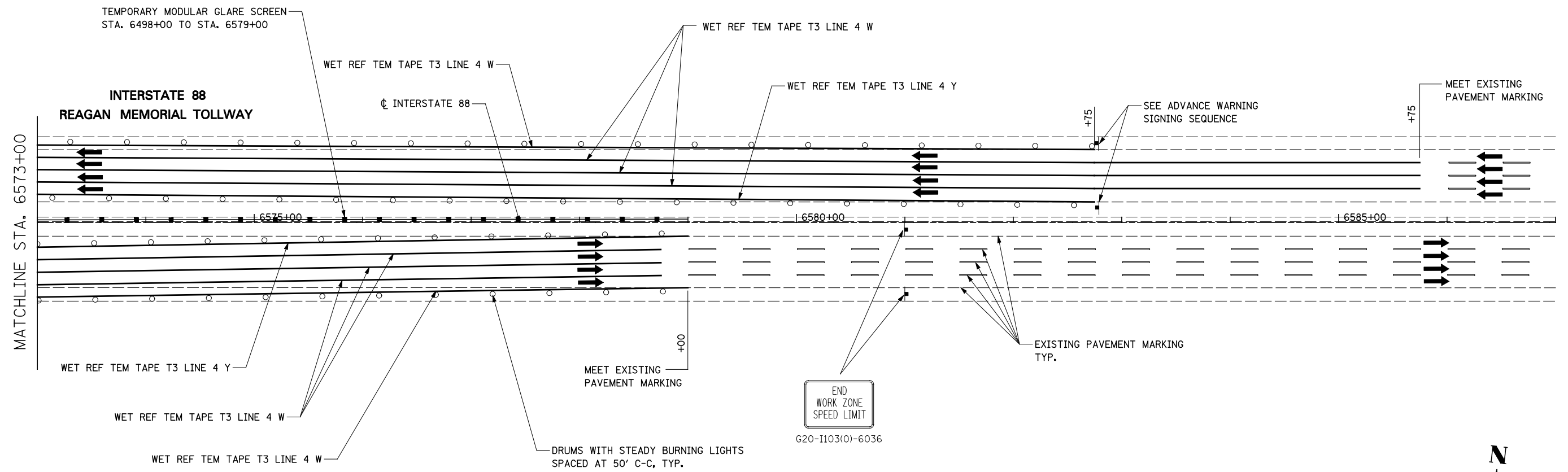

**TOLLWAY TRAFFIC CONTROL**

TRAFFIC CONTROL ON INTERSTATE 88 AND AT RAMP TERMINALS SHALL BE IN ACCORDANCE WITH THE FOLLOWING ILLINOIS TOLLWAY STANDARDS:

E1-02 CONSTRUCTION SIGNS  
 E2-02 LANE CLOSURE DETAILS  
 E3-02 SHOULDER CLOSURE DETAILS  
 E4-01 MAINTENANCE OF TRAFFIC REVERSE CURVE  
 E5-01 TEMPORARY GORE DETAILS

**NOTES**

1. LOCATION OF TRAILER MOUNTED FULL MATRIX PORTABLE CHANGEABLE MESSAGE SIGN SHALL BE COORDINATED WITH THE ENGINEER AND THE ILLINOIS TOLLWAY. MESSAGE TO BE DISPLAYED WILL BE REMOTELY CONTROLLED BY THE ILLINOIS TOLLWAY TRAFFIC MANAGEMENT CENTER.
2. THE TRAILER MOUNTED FULL MATRIX PORTABLE CHANGEABLE MESSAGE SIGN SHALL REMAIN IN PLACE FOR THE ENTIRE DURATION OF THE CONTRACT. NO ADDITIONAL COMPENSATION WILL BE ALLOWED FOR DELAYS EXTENDING THE CONTRACT BEYOND COMPLETION DATE AS SHOWN IN THE SPECIAL PROVISIONS.

