

PLAN	SURVEYED	BY	DATE
	PLOTTED		
	CHECKED		
	NOTED		
	FILE NAME		

PROFILE	SURVEYED	BY	DATE
	PLOTTED		
	CHECKED		
	NOTED		
	STRUCTURE		
	NOTATION		

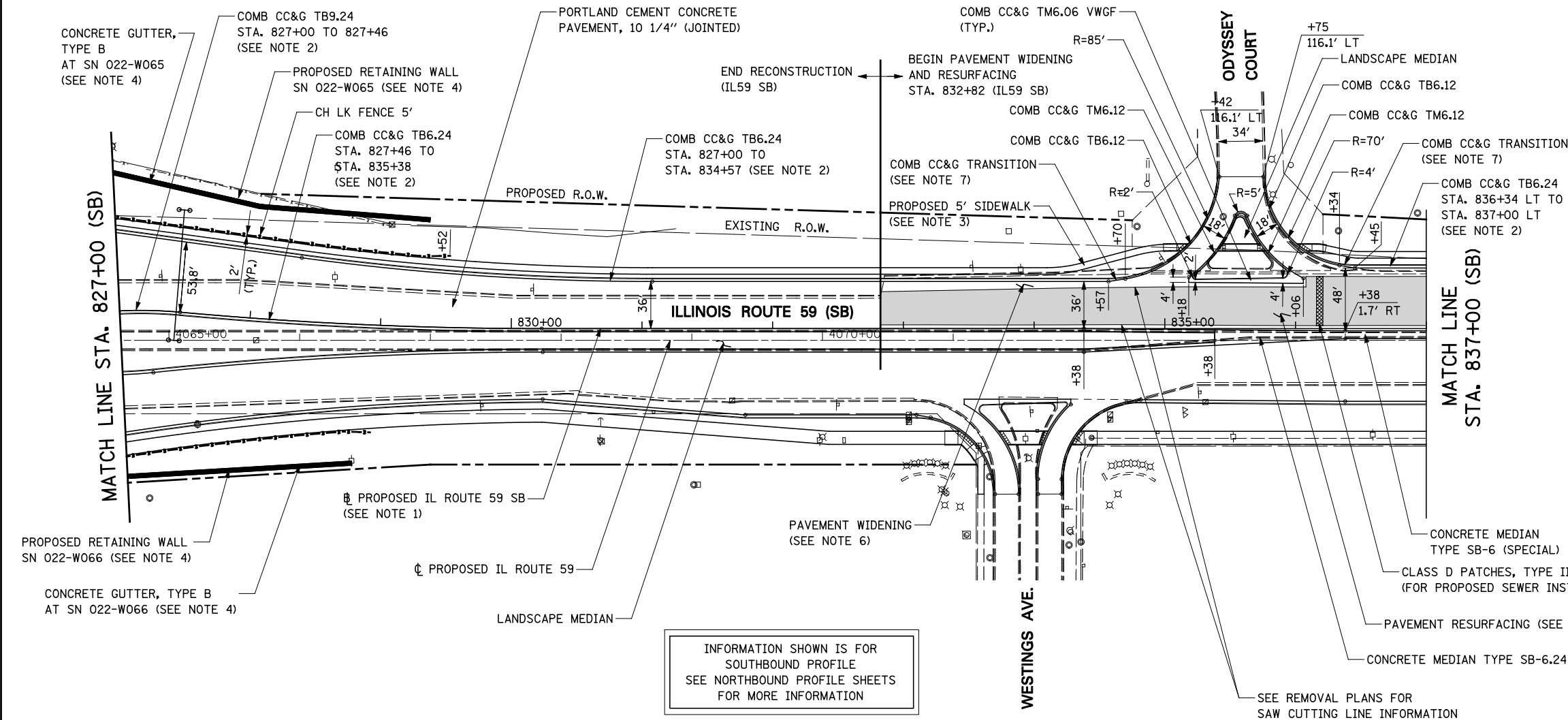

- ### NOTES
- FOR PROPOSED ILLINOIS ROUTE 59 AND I-88 RAMP BASELINE INFORMATION SEE ALIGNMENT, BENCHMARKS, AND TIES - ILLINOIS ROUTE 59 NORTHBOUND & SOUTHBOUND BASELINE AND I-88 RAMPS DATA SHEETS.
 - FOR PROPOSED ILLINOIS ROUTE 59 AND I-88 RAMP PAVEMENT GEOMETRY INFORMATION SEE GEOMETRIC LAYOUT - ILLINOIS ROUTE 59 AND GEOMETRIC LAYOUT - I-88 RAMPS SHEETS.
 - FOR PROPOSED SIDEWALK, SHARED-USE PATH, AND FENCE INFORMATION SEE SIDEWALK / SHARED-USE PATH/ FENCE PLANS.
 - FOR PROPOSED BRIDGE STRUCTURES, APPROACH PAVEMENTS, AND RETAINING WALLS SEE STRUCTURAL PLANS.
 - PAVEMENT RESURFACING SHALL CONSIST OF POLYMERIZED HMA SURFACE COURSE, MIX "F", N90, 2", LEVELING BINDER (MACHINE METHOD), N70, 3/4".
 - PAVEMENT WIDENING SHALL CONSIST OF THE FOLLOWING: HOT-MIX ASPHALT PAVEMENT (FULL-DEPTH), 10 1/4" AGGREGATE SUBGRADE IMPROVEMENT, 12" GEOTECHNICAL FABRIC FOR GROUND STABILIZATION.
 - ALL WORK REQUIRED FOR THE CONSTRUCTION OF COMBINATION CONCRETE CURB AND GUTTER TRANSITION SHALL BE PAID FOR AS COMBINATION CONCRETE CURB AND GUTTER, TYPE B-6.24.
 - FOR PROPOSED GRADING INFORMATION SEE PAVEMENT JOINTING AND ELEVATION PLANS.

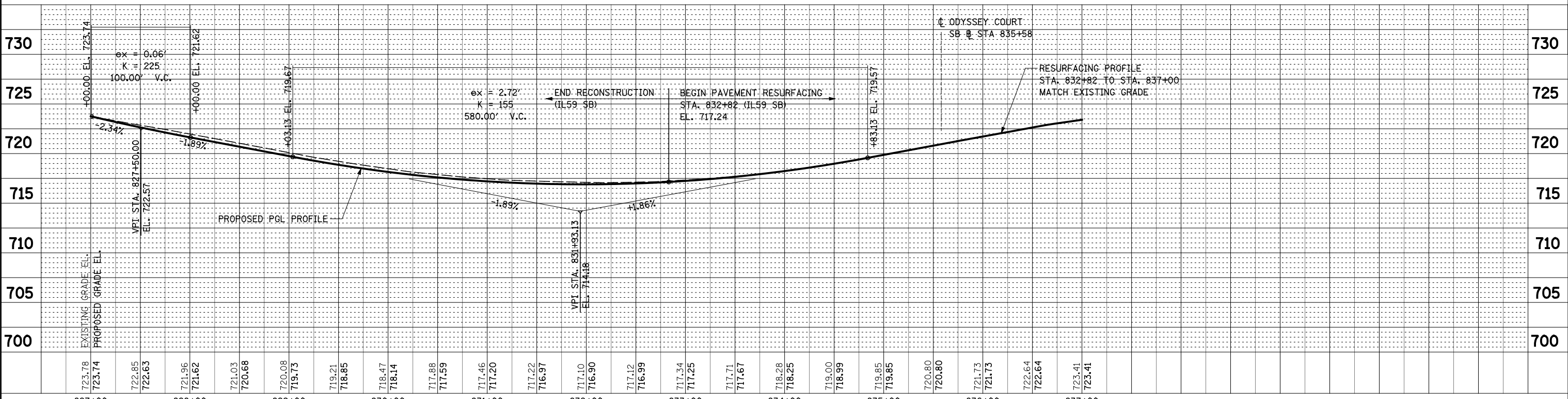
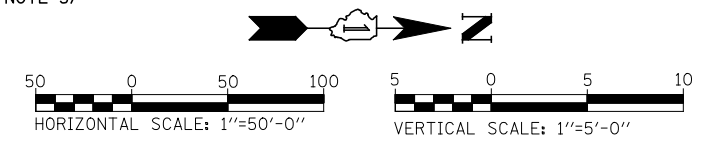

FILE NAME =	USER NAME = #USER#	DESIGNED <i>PJO</i>	REVISED -	STATE OF ILLINOIS DEPARTMENT OF TRANSPORTATION	PLAN AND PROFILE - ILLINOIS ROUTE 59 (SB)	F.A.P. RTE.	SECTION	COUNTY	TOTAL SHEETS	SHEET NO.	
*FILE#		DRAWN <i>KES</i>	REVISED -			338	(112 & 113) WRS-5	DUPAGE	963	251	
PLOT SCALE = #SCALE#		CHECKED <i>JCM</i>	REVISED -			CONTRACT NO. 60I31					
PLOT DATE = #DATE#		DATE <i>10/15/2012</i>	REVISED -			ILLINOIS FED. AID PROJECT					