

PLAN	SURVEYED	CHECKED	DATE
	PLOTTED	ALIGNMENT	
	NOTE BOOK	FILE NAME	

PROFILE	SURVEYED	CHECKED	DATE
	PLOTTED	GRADES	
	NOTE BOOK	STRUCTURE	

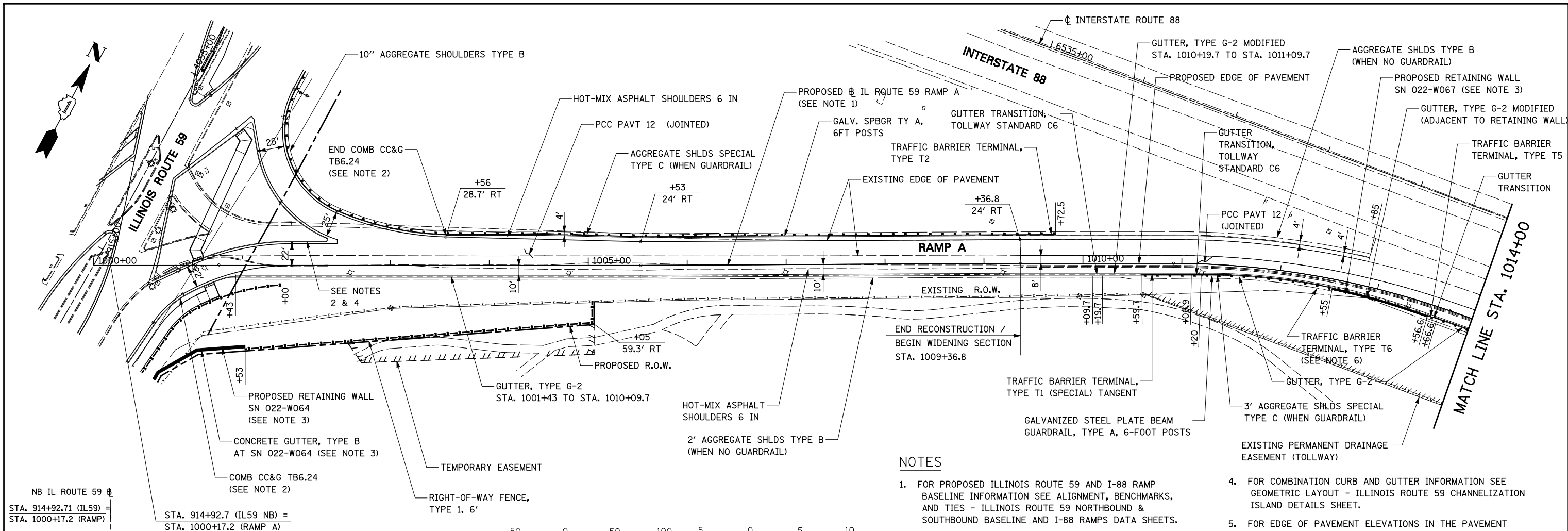

**NOTES**

- FOR PROPOSED ILLINOIS ROUTE 59 AND I-88 RAMP BASELINE INFORMATION SEE ALIGNMENT, BENCHMARKS, AND TIES - ILLINOIS ROUTE 59 NORTHBOUND & SOUTHBOUND BASELINE AND I-88 RAMPS SHEETS.
- FOR PROPOSED ILLINOIS ROUTE 59 AND I-88 RAMP PAVEMENT GEOMETRY INFORMATION SEE GEOMETRIC LAYOUT - ILLINOIS ROUTE 59 AND GEOMETRIC LAYOUT - I-88 RAMPS SHEETS.
- FOR PROPOSED BRIDGE STRUCTURES, APPROACH PAVEMENTS, AND RETAINING WALLS SEE STRUCTURAL PLANS.
- FOR COMBINATION CURB AND GUTTER INFORMATION SEE GEOMETRIC LAYOUT - ILLINOIS ROUTE 59 CHANNELIZATION ISLAND DETAILS SHEET.
- FOR EDGE OF PAVEMENT ELEVATIONS IN THE PAVEMENT WIDENING AREA SEE PAVEMENT JOINTING AND ELEVATION PLANS.
- SEE TYPE G-2 GUTTER TRANSITION DETAIL FOR TRAFFIC BARRIER TERMINAL TYPE T6 AT RETAINING WALL.
- PROPOSED PROFILE IS PROVIDED THROUGH LOCATION OF G-2 GUTTER FOR DRAINAGE INFORMATION.

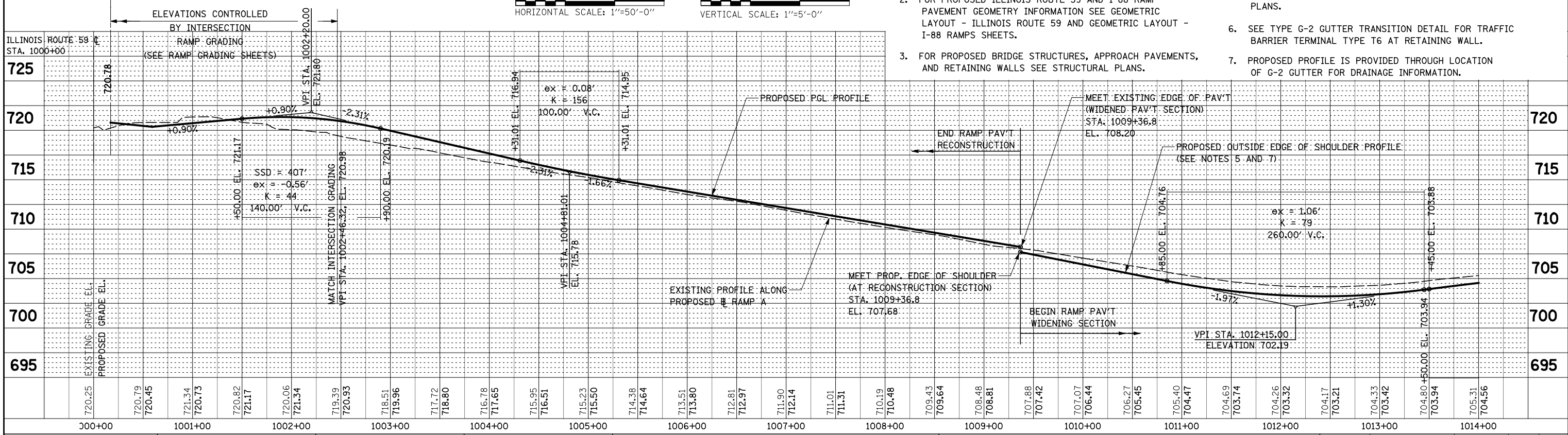
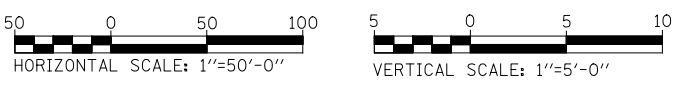

FILE NAME =	USER NAME = #USER#	DESIGNED <i>PJO</i>	REVISED -	<b>STATE OF ILLINOIS</b> <b>DEPARTMENT OF TRANSPORTATION</b>	<b>PLAN AND PROFILE - RAMP A</b>	F.A.P. RTE.	SECTION	COUNTY	TOTAL SHEETS	SHEET NO.	
*FILE#		DRAWN <i>KES</i>	REVISED -			338	(112 & 113) WRS-5	DUPAGE	963	253	
PLOT SCALE = #SCALE#		CHECKED <i>JCM</i>	REVISED -			CONTRACT NO. 60I31					
PLOT DATE = #DATE#		DATE <i>10/15/2012</i>	REVISED -			ILLINOIS FED. AID PROJECT					