

MATCH LINE STA. 1014+00
SEE DRAWING DE-08

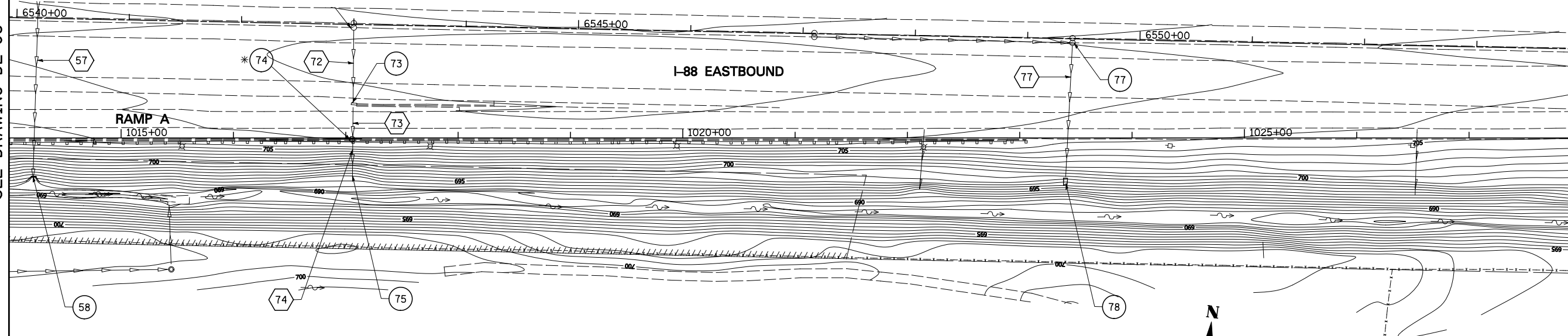

MATCH LINE STA. 1028+00
SEE BELOW

* REMOVE CATCH BASIN TO MAINTAIN FLOW.

NOTE:

1. SEE DRAWING DN-01 FOR EXISTING DRAINAGE LEGEND.

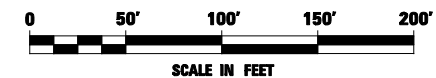

MATCH LINE STA. 1028+00
SEE ABOVE

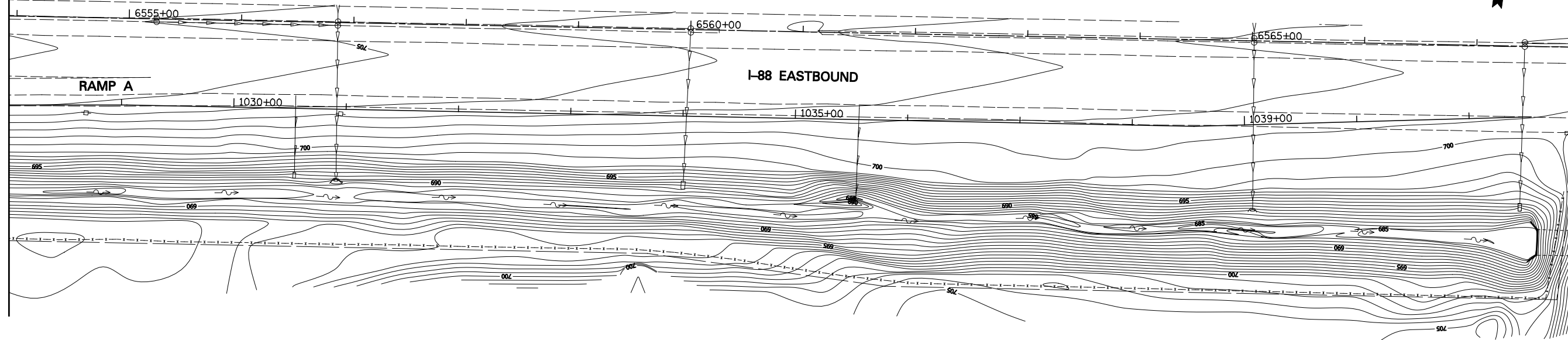

FILE NAME = #FILEL#	USER NAME = #USER#	DESIGNED <i>PJO</i>	REVISED -	STATE OF ILLINOIS DEPARTMENT OF TRANSPORTATION	EXISTING DRAINAGE PLAN - RAMP A			F.A.P. RTE. 338	SECTION (112 & 113) WRS-5	COUNTY DUPAGE	TOTAL SHEETS 963	SHEET NO. 336
	PLOT SCALE = #SCALE#	DRAWN <i>KES</i>	REVISED -		SCALE: 1"=50'	SHEET NO. 9 OF 10 SHEETS	STA. 1014+00 TO STA. 1028+00	DE-09		CONTRACT NO. 60131		
	PLOT DATE = #DATE#	CHECKED <i>JCM</i>	REVISED -		ILLINOIS FED. AID PROJECT							
		DATE <i>10/15/2012</i>	REVISED -									