

NOTES

1. HIGH MAST LIGHT TOWER, CCTV CAMERA AND CONDUIT FROM HANDHOLE TO LIGHT TOWER ARE SHOWN FOR INFORMATIONAL PURPOSES ONLY. SEE LIGHTING PLANS FOR DETAILS.

RESTORATION OF WORK AREA, RESTORATION OF THE TRAFFIC SIGNAL WORK AREA SHALL BE INCIDENTAL TO THE RELATED PAY ITEM SUCH AS FOUNDATION, CONDUIT, HANDHOLE, TRENCH AND BACKFILL, ETC., AND NO EXTRA COMPENSATION SHALL BE ALLOWED. ALL ROADWAY SURFACES SUCH AS SHOULDERS, MEDIANS, SIDEWALKS, PAVEMENT, ETC. SHALL BE REPLACED IN KIND. ALL DAMAGE TO MOWED LAWNS SHALL BE REPLACED WITH AN APPROVED SOD, AND ALL DAMAGE TO UNMOWED FIELDS SHALL BE SEED IN ACCORDANCE WITH STANDARD SPECIFICATIONS 252 AND 250 RESPECTIVELY.

THE TRAFFIC SIGNAL CONTROLLER EQUIPMENT SHALL BE "ECONOLITE" TO MATCH THE EXISTING ADJACENT SYSTEM.

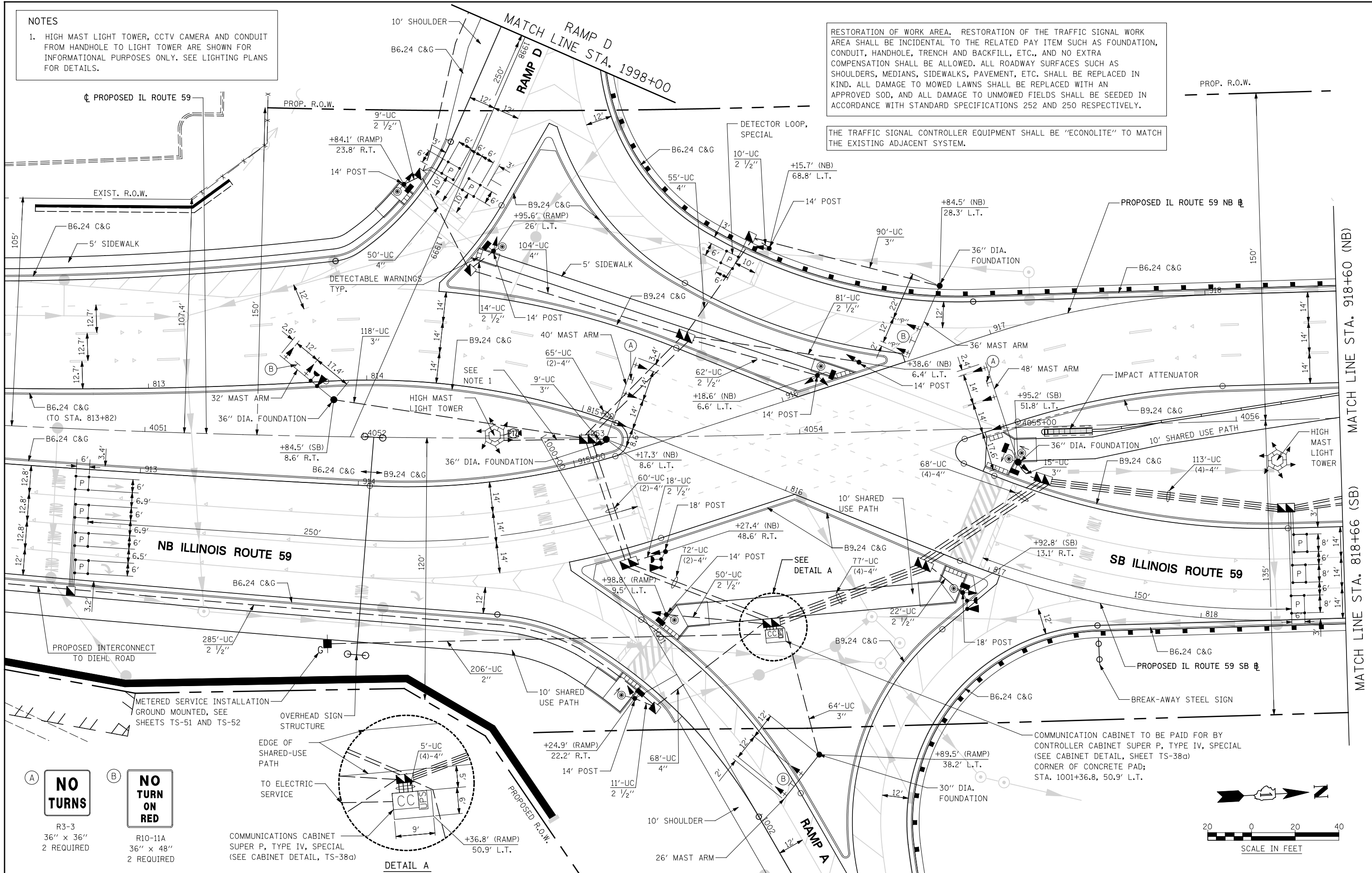

R3-3
36" x 36"
2 REQUIRED

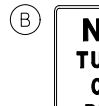

R10-11A
36" x 48"
2 REQUIRED

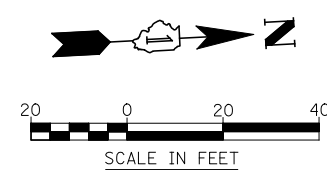
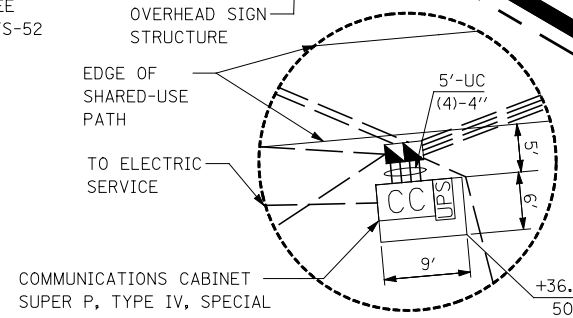

FILE NAME =	USER NAME = #USER#	DESIGNED <i>MJM</i>	REVISED -
#FILE#		DRAWN <i>KES</i>	REVISED -
		CHECKED <i>JCM</i>	REVISED -
		DATE <i>10/15/2012</i>	REVISED -

**STATE OF ILLINOIS
DEPARTMENT OF TRANSPORTATION**

**PROPOSED TRAFFIC SIGNAL PLAN
IL ROUTE 59 AND I-88 SOUTH RAMPS**

SCALE: AS SHOWN SHEET NO. 33 OF 53 SHEETS STA. TO STA.

F.A.P. RTE.	SECTION	COUNTY	TOTAL SHEETS	SHEET NO.
338	(112 & 113) WRS-5	DUPAGE	963	448
TS-33		CONTRACT NO. 60131		
ILLINOIS FED. AID PROJECT				