

PLAN
South Approach Slab (NB)

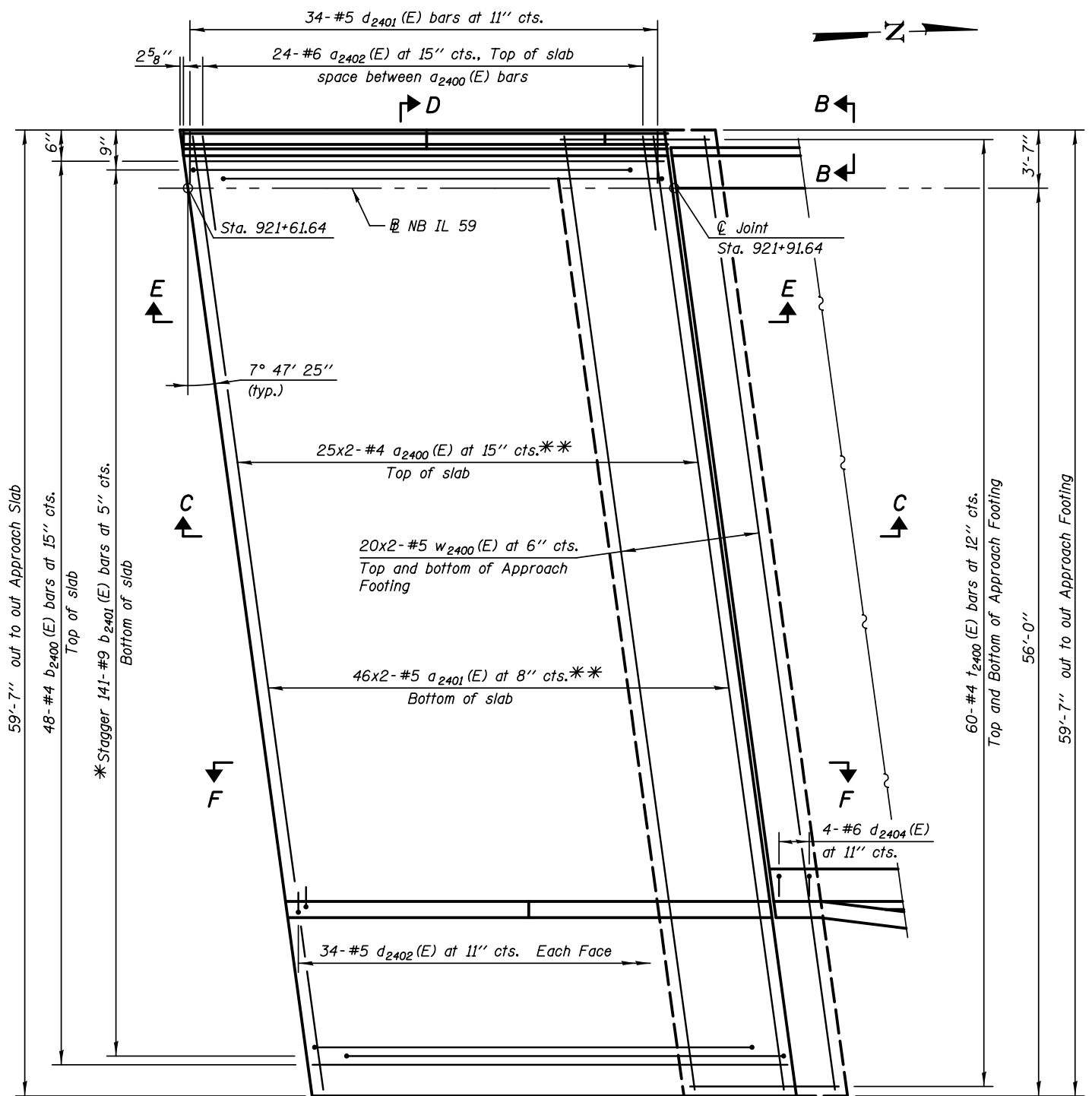

PLAN
North Approach Slab (NB)

*Tilt #9 b2401(E) bars as required to maintain clearance.
**Measured along \varnothing Roadway

NOTE A
3'-0" x 11" notch in approach slab footing for Traffic Barrier Terminal Type T6 posts. Cut t_{2400} (E) and w_{2400} (E) bars, as required, to fit notch.
South Approach Slab Only

Notes:
Bars indicated thus 20x3-#5 ect. indicates 20 lines of bars with 3 lengths per line.
See Sheet SA-34 for Sections C-C & D-D and Views B-B & E-E
See Sheet SA-35 for View F-F and Shared Use Path and Parapet Details.

KNIGHT
Engineers & Architects

DESIGNED - WPM	REVISION
CHECKED - TB	REVISION
SCALE - NONE	REVISION
DATE - 10/15/2012	REVISION
DRAWN - TB	REVISION
CHECKED - WPM	REVISION

STATE OF ILLINOIS
DEPARTMENT OF TRANSPORTATION

BRIDGE APPROACH SLAB PLAN (NB)
S.N. 022-2029 (SB) TOLLWAY B.N. 826
S.N. 022-2030 (NB) TOLLWAY B.N. 825
SHEET NO. SA-33 OF 63 SHEETS

F.A.P. RTE.	SECTION	COUNTY	TOTAL SHEETS	SHEET NO.
338	(112 & 113) WRS-5	DUPAGE	963	617
CONTRACT NO. 60131				
ILLINOIS FED. AID PROJECT				