

ELEVATION - FORM LINER

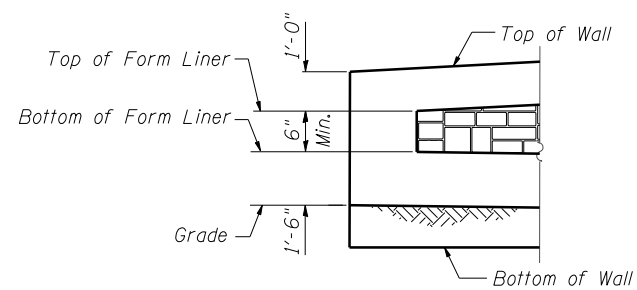

END FORM LINER FINISH

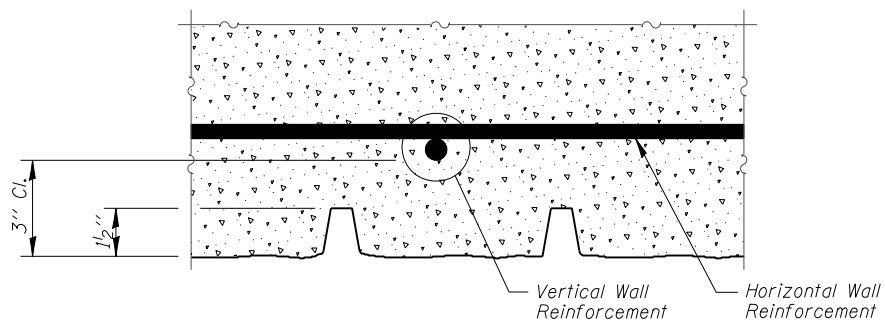

PLAN - FORM LINER

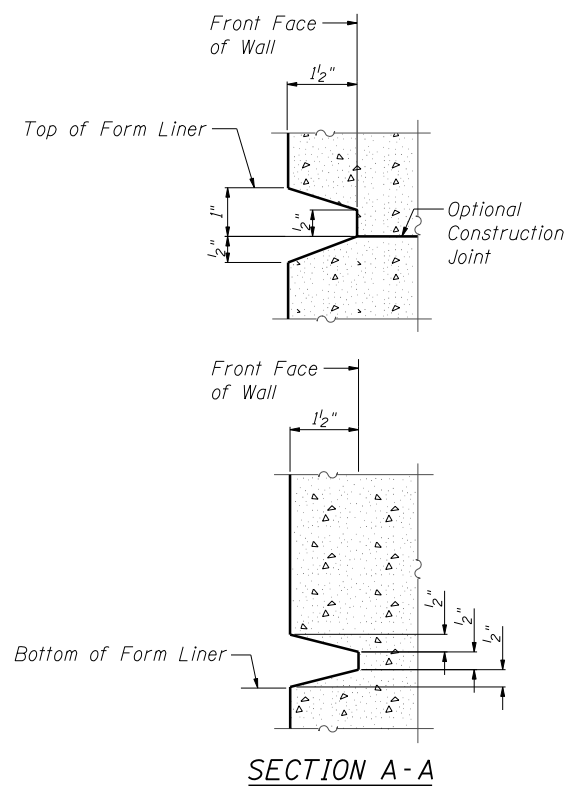

FORM LINER ELEVATION TABLE

Station	Form Liner Top Elevation	Form Liner Bottom Elevation
829+35.77	None	None
829+29.56	710.36	709.86
829+25.16	711.32	709.00
829+08.61	711.81	708.91
828+81.88	712.61	708.77
828+55.14	713.41	708.63
828+28.38	714.20	708.50
828.01.62	715.00	708.36
827+76.35	715.08	708.07
827+50.82	715.17	707.77
827+30.54	715.25	707.48
827+11.76	715.33	706.86
826+93.49	715.42	706.25
826+75.79 Offset 117.98' Lt.	715.50	705.63
826+77.49 Offset 137.74' Lt.	705.55	705.05
826+77.90 Offset 142.81' Lt.	None	None

FILE NAME = ...E0131-W065-010-ArchFinish.dgn



Zroka Engineering, P.C.
4216 North Hermitage
Chicago, IL 60613

USER NAME = SAW	DESIGNED - LAS	REVISED -
	CHECKED - DAZ	REVISED -
PLOT SCALE = 0.1667' / IN.	DRAWN - SAW	REVISED -
PLOT DATE = 10/10/2012	CHECKED - JLA	REVISED -

STATE OF ILLINOIS
DEPARTMENT OF TRANSPORTATION

ARCHITECTURAL FINISH DETAILS
STRUCTURE NUMBER 022-W065

SHEET NO. SD-10 OF SD-11 SHEETS

ARCHITECTURAL FINISH DETAILS
SN 022-W065

F.A.P. RTE.	SECTION	COUNTY	TOTAL SHEETS	SHEET NO.
338/1L 59	(112 & 113) WRS-5	DUPAGE	963	671
CONTRACT NO. 60131			ILLINOIS FED. AID PROJECT	