

ELEVATION - FORM LINER

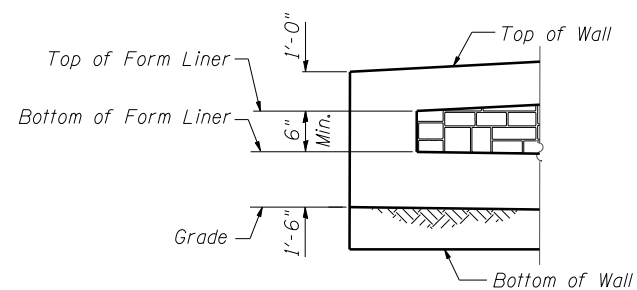

END FORM LINER FINISH

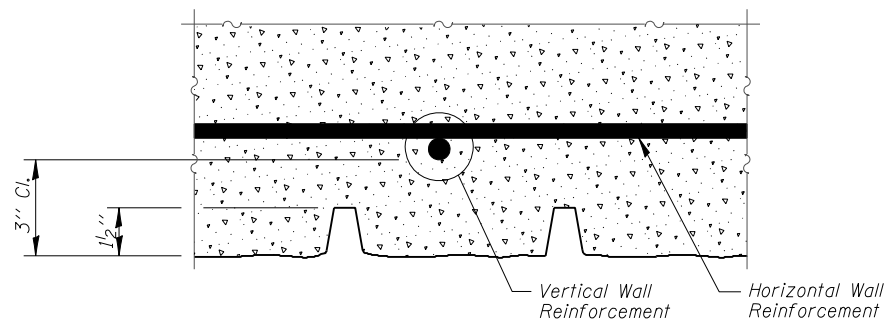

PLAN - FORM LINER

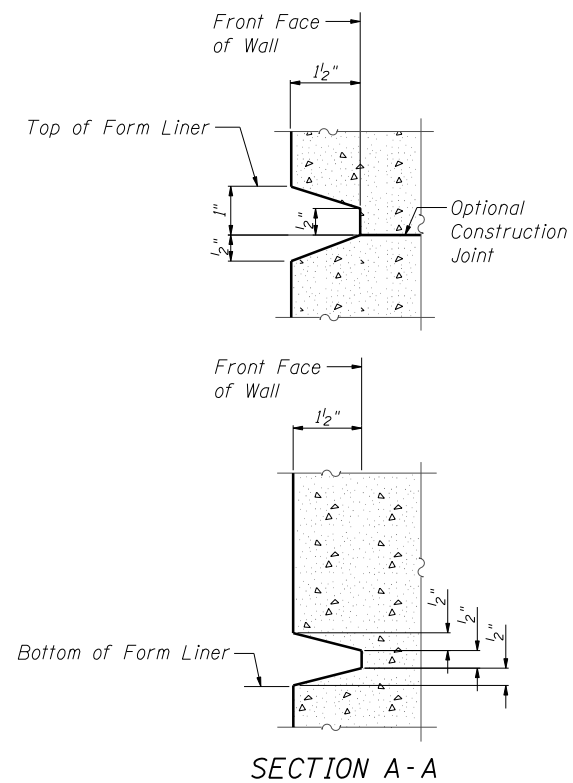

FORM LINER ELEVATION TABLE

Station	Form Liner Top Elevation	Form Liner Bottom Elevation
926+14.90	None	None
926+15.61	712.46	711.96
926+17.34	713.54	712.10
926+29.99	716.17	712.31
926+43.68	718.81	712.53
926+58.80	721.50	712.71
926+79.91	720.31	712.91
927+01.14	719.12	713.10
927+25.08	717.94	713.06
927+52.12	716.75	713.02
927+79.18	715.56	712.96
928+06.25	714.37	712.96
928+26.88	713.47	712.96
928+33.32	None	None
928+60.40	None	None

ARCHITECTURAL FINISH DETAILS
SN 022-W066

FILE NAME = ...E0131-W066-010-ArchFinish.dgn



USER NAME = SAW	DESIGNED - LAS	REVISED -
	CHECKED - DAZ	REVISED -
PLOT SCALE = 0.1667' / IN.	DRAWN - SAW	REVISED -
PLOT DATE = 10/10/2012	CHECKED - JLA	REVISED -

STATE OF ILLINOIS
DEPARTMENT OF TRANSPORTATION

ARCHITECTURAL FINISH DETAILS
STRUCTURE NUMBER 022-W066

SHEET NO. SE-10 OF SE-11 SHEETS

F.A.P. RTE.	SECTION	COUNTY	TOTAL SHEETS	SHEET NO.
338/1L 59	(112 & 113) WRS-5	DUPAGE	963	682
			CONTRACT NO. 60131	
ILLINOIS FED. AID PROJECT				