

**RUMBLE STRIPE
EXPRESSWAY DIVIDED**

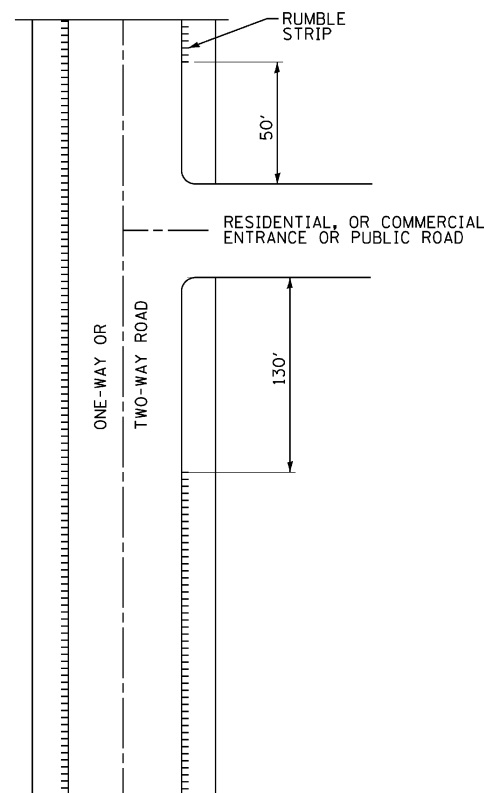

**RUMBLE STRIPE
INTERSECTIONS**

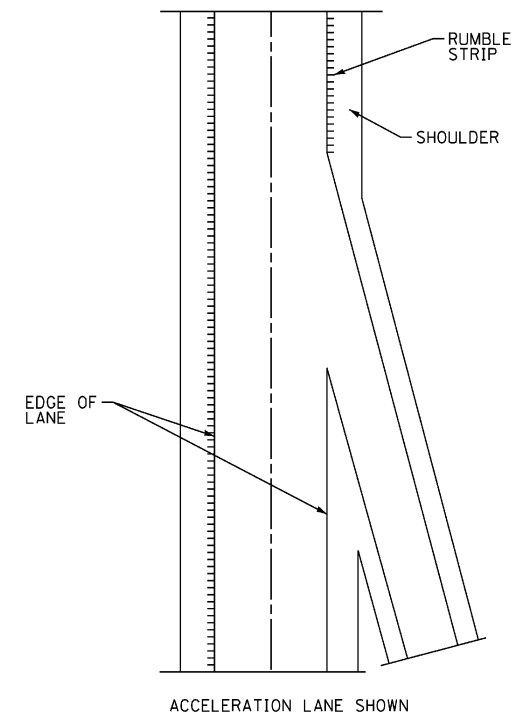

**RUMBLE STRIPE
ACCELERATION OR DECELERATION LANE**

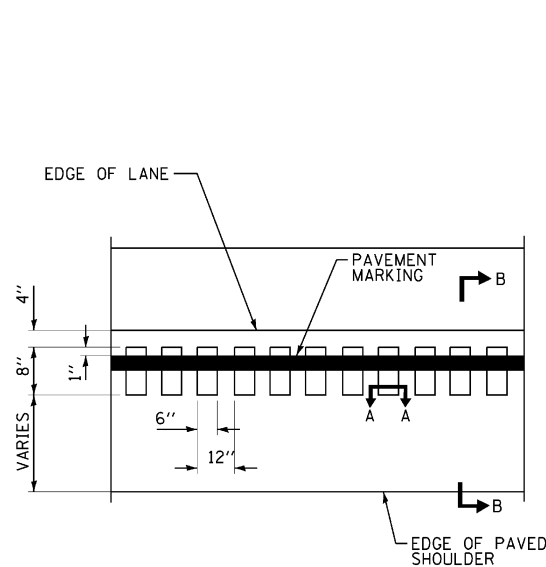

PLAN FOR RUMBLE STRIPE

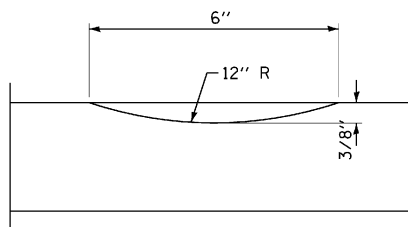

SECTION A-A

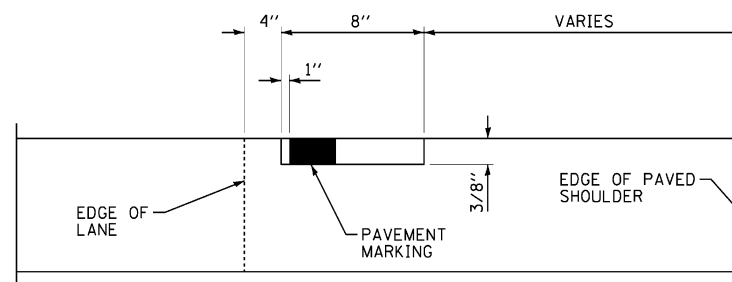

SECTION B-B

GENERAL NOTES

ON PORTLAND CEMENT CONCRETE SHOULDERS,
NO SHOULDER RUMBLE STRIPE SHALL BE LOCATED
CLOSER THAN 150mm (6") TO A TRANSVERSE
JOINT.

OMIT SHOULDER RUMBLE STRIP ACROSS
STRUCTURES.

SHOULDER RUMBLE STRIPES TO BE PAID FOR AS
SHOULDER RUMBLE STRIP AND HOT-SPRAY THERMOPLASTIC
PAVEMENT MARKING - LINE 4"

COPYRIGHT © 2012 BY BAXTER & WOODMAN, INC. ALL RIGHTS RESERVED. ILLINOIS PROFESSIONAL ENGINEERING LICENSE NO. 189-001272 EXP. 12/31/2015
 PROJECT: ILLINOIS DEPARTMENT OF TRANSPORTATION, ILLINOIS ROUTE 23 TO BUNKER HILL ROAD, ILLINOIS COUNTY, McHENRY COUNTY, ILLINOIS
 DRAWING NO. 100153-W018-MISC-DETS.dgn
 DATE: 12-13-10
 FILE: 100153-W018-MISC-DETS.dgn



DESIGNED -	DSH	REVISED -	
DRAWN -	KAR	REVISED -	
CHECKED -	LDH	REVISED -	
DATE -	12-13-10	FILE -	100153-W018-MISC-DETS.dgn

**STATE OF ILLINOIS
DEPARTMENT OF TRANSPORTATION**

**US ROUTE 14
IL ROUTE 23 TO BUNKER HILL ROAD
SHOULDER RUMBLE STRIPE FOR NON-FREEWAY**

SCALE: NONE

STA. TO STA.

F.A.P. RTE.	SECTION	COUNTY	TOTAL SHEETS	SHEET NO.
305	29R-RS-4	McHENRY	25	17
C-91-298-11		CONTRACT NO. 60N28		
FED. ROAD DIST. NO. 1 ILLINOIS FED AID PROJECT				