

PLAN	SURVEYED	BY	DATE
	PLOTTED		
	CHECKED		
	FILE NAME		
	NO.		

PROFILE	SURVEYED	BY	DATE
	PLOTTED		
	CHECKED		
	NOTATIONS		
	NO.		

SEE SHEET NO. 68
MATCH LINE STATION 661+00

MATCH LINE STATION 672+00
SEE SHEET NO. 70

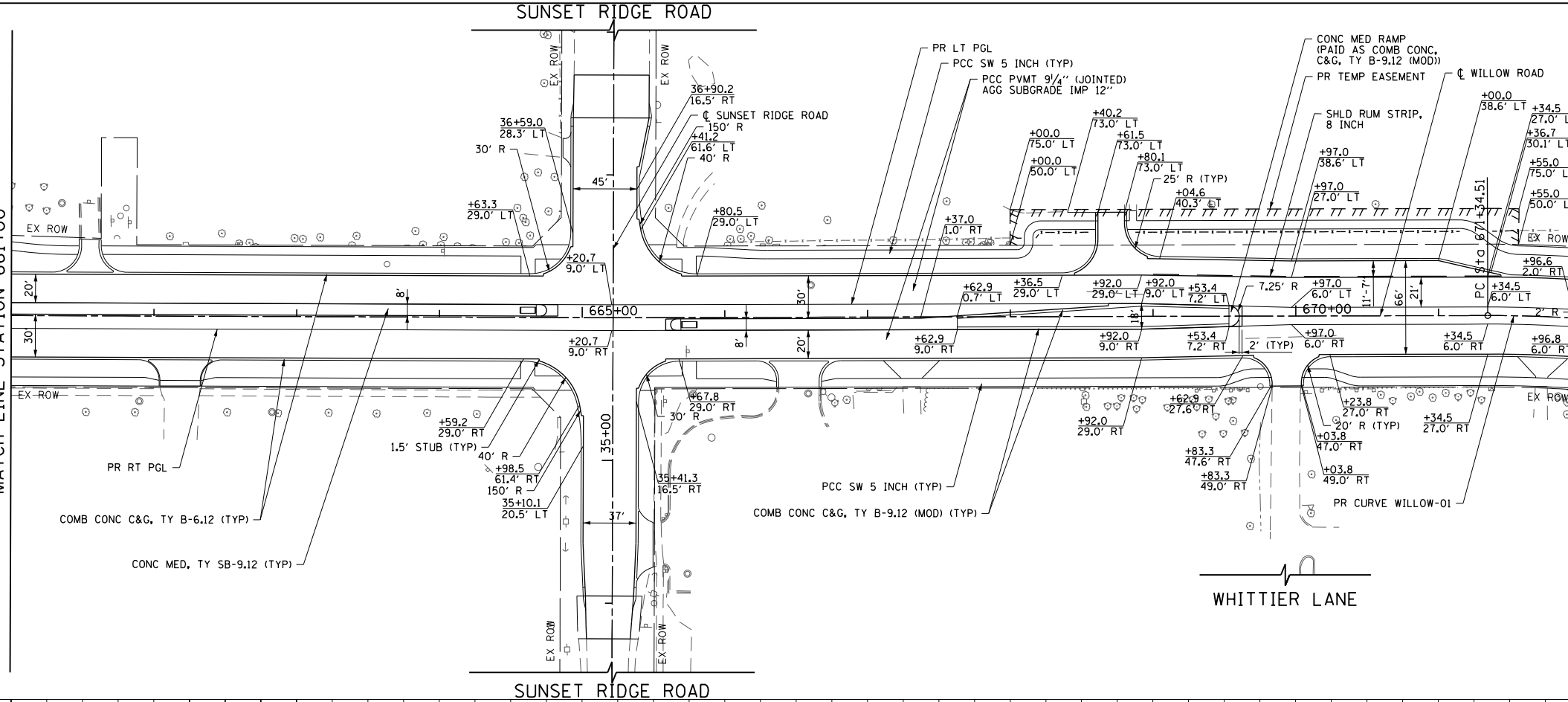

PR CURVE WILLOW-01
PI STA. = 675+79.83
 $\Delta = 51^\circ 04' 32''$ (RT)
D = 6° 08' 50"
R = 932.06'
T = 445.32'
L = 830.87'
E = 100.92'
e = 3.2%
T.R. = 55
S.E. RUN = 84
P.C. STA. = 671+34.51
P.T. STA. = 679+65.38

- NOTES:**
- FOR SUNSET RIDGE ROAD PLAN AND PROFILE SEE SHEET NO. 79
 - FOR WAGNER ROAD PLAN AND PROFILE SEE SHEET NO. 80
 - FOR INTERSTATE 94 RAMP A AND RAMP D PLAN AND PROFILE SEE SHEET NO. 81 TO 84
 - FOR SOMERSET LANE / OLD WILLOW ROAD PLAN SEE SHEET NO. 99
 - FOR SIDEWALK AND DRIVEWAY PLANS SEE SHEET NO. 94 TO 98
 - FOR INTERSECTION AND INTERSTATE 94 RAMP AND AUXILIARY LANE PAVING PLANS SEE SHEET NO. 264 TO 275
 - FOR PEDESTRIAN REFUGE ISLAND, ISLAND, CURB AND GUTTER TRANSITION, AND MEDIAN TRANSITION DETAILS SEE SHEET NO. 101 TO 103
 - FOR PROPOSED RIGHT PGL PROFILE SEE SHEET NO. 85 TO 90
 - THE GENERAL CONTRACTOR IS REQUIRED TO HIRE AN ENVIRONMENTAL FIRM WITH AT LEAST FIVE (5) DOCUMENTED LEAKING UNDERGROUND STORAGE TANK CLEANUPS OR THAT IS PRE-QUALIFIED IN HAZARDOUS WASTE BY THE DEPARTMENT TO REMEDIATE THE SOIL CONTAMINATION AND MONITOR FOR WORKER PROTECTION.

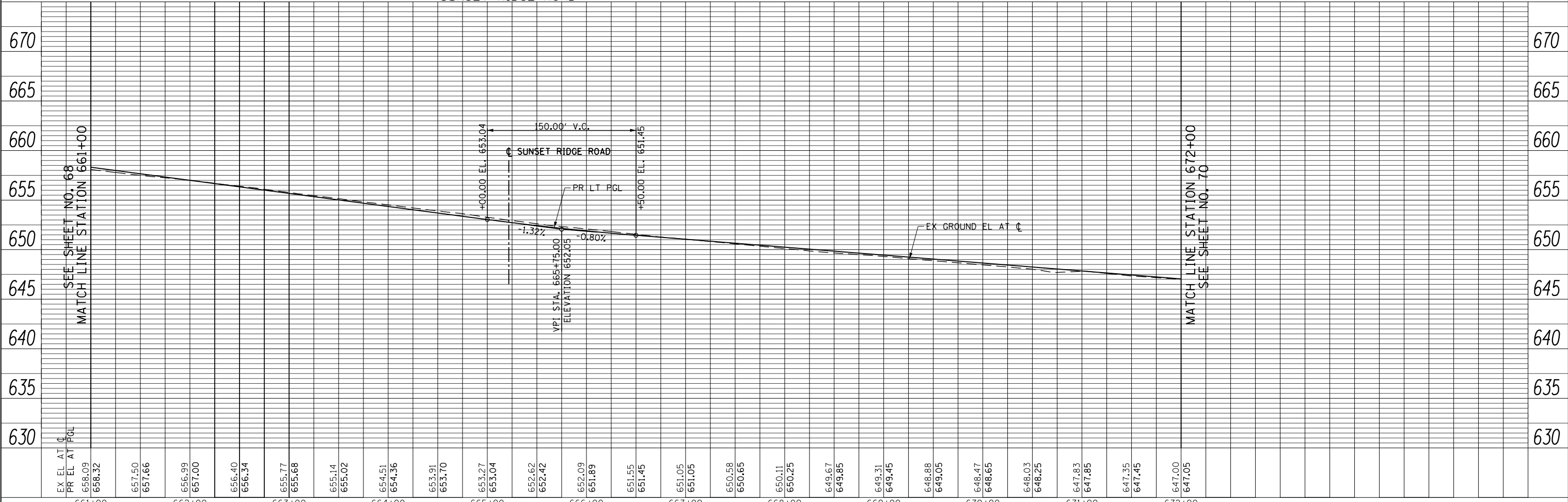

EX EL AT C	PR EL AT PGL	661+00	662+00	663+00	664+00	665+00	666+00	667+00	668+00	669+00	670+00	671+00	672+00
658.09	658.32	657.50	657.66	656.99	657.00	656.40	656.34	655.77	655.68	655.14	655.02	654.51	654.36
653.91	653.70	653.27	653.04	652.62	652.42	652.09	651.89	651.55	651.45	651.05	650.95	650.11	650.25
649.67	649.85	649.31	649.45	648.88	649.05	648.47	648.65	648.03	648.25	647.83	647.85	647.35	647.45
647.00	647.05												

FILE NAME = g:\ch11\158\road\Sheets\160135-SHT-PLNPRF-04.dgn

USER NAME = BAW\rtt
PLOT SCALE = 100.000' / in.
PLOT DATE = 11/28/2012

DESIGNED - JLV
DRAWN - KAL
CHECKED - RCB
DATE - 10/31/2012

REVISED -
REVISED -
REVISED -
REVISED -

STATE OF ILLINOIS
DEPARTMENT OF TRANSPORTATION

WILLOW ROAD PLAN AND PROFILE

SCALE: HORIZ: 1"=50'
VERT: 1"=5'
SHEET NO. 69 OF 919 SHEETS
STA. 661+00 TO STA. 672+00

F.A.P. RTE.	SECTION	COUNTY	TOTAL SHEETS	SHEET NO.
305	(1920.01,1518,2022&1922,4BR)	COOK	919	69
CONTRACT NO. 60T35			FED. ROAD DIST. NO. 1 ILLINOIS FED. AID PROJECT	