

NOTES

1. THE DETOUR HAS BEEN APPROVED TO COMPLETE CONSTRUCTION OF INTERSTATE 94 RAMP D. THE CONTRACTOR HAS 10 CALENDAR DAYS TO DETOUR TRAFFIC. AFTER 10 CALENDAR DAYS, THE CONTRACTOR SHALL OPEN RAMP D IN THE PROPOSED CONFIGURATION.
2. CHANGEABLE MESSAGE SIGNS ARE TO BE PLACED TWO (2) WEEKS PRIOR TO THE START OF THE DETOUR. CHANGEABLE MESSAGE SIGNS TO BE PAID FOR SEPARATELY (NOT INCLUDED IN THE COST OF THE DETOUR).
3. ANY EXISTING SIGNS THAT CONTRADICT THE DETOUR SIGNAGE AS SHOWN ON THE PLANS SHALL BE COVERED PRIOR TO THE OPENING OF THE DETOUR ROUTE. THIS WORK IS INCIDENTAL TO THE COST OF "TRAFFIC CONTROL AND PROTECTION FOR TEMPORARY DETOUR". COVERS SHALL BE REMOVED AT THE TIME THE DETOUR SIGNS ARE REMOVED.
4. ALL SIGNAGE SHALL BE IN ACCORDANCE WITH THE LATEST ILLINOIS STANDARD SPECIFICATIONS FOR ROAD AND BRIDGE CONSTRUCTION, "THE QUALITY STANDARD FOR WORK ZONE TRAFFIC CONTROL DEVICES", THE DETAILS OF THESE PLANS, THE "2009 MANUAL OF UNIFORM TRAFFIC CONTROL DEVICES", THE SPECIAL PROVISIONS FOR "TRAFFIC CONTROL AND PROTECTION FOR TEMPORARY DETOUR", HIGHWAY STANDARD 701901, AND DISTRICT DETAIL TC-21.
5. IF DEEMED NECESSARY BY THE ENGINEER, A PRE-CONSTRUCTION MEETING WITH THE CONTRACTOR SHALL BE HELD AT LEAST TWO WEEKS PRIOR TO THE DAY THE DETOUR IS TO BE IN EFFECT. THE ROAD SHALL NOT BE CLOSED UNTIL ALL DETOUR SIGNAGE IS IN PLACE.
6. THE SIGNAGE SHOWN ON THE PLANS IS DEEMED TO BE THE MINIMUM REQUIRED. THE CONTRACTOR SHALL MAKE ALL CHANGES DEEMED NECESSARY BY THE ENGINEER. ADDITIONS AND DELETIONS OF TRAFFIC CONTROL FOR THIS DETOUR SHALL BE CONSIDERED INCLUDED IN THE COST OF "TRAFFIC CONTROL AND PROTECTION FOR TEMPORARY DETOUR" AND WILL NOT BE PAID FOR SEPARATELY.
7. ALL DETOUR SIGNS SHALL BE REMOVED ONCE CONSTRUCTION IS COMPLETE AND THE RAMP IS REOPENED TO TRAFFIC.
8. ALL SIGNS SHOWN SHALL BE FURNISHED, ERECTED, AND MAINTAINED BY THE CONTRACTOR, AND SHALL BE POST-MOUNTED IN THE GROUND PER ARTICLE 701.14 OF THE STANDARD SPECIFICATIONS AND STANDARD 701901.

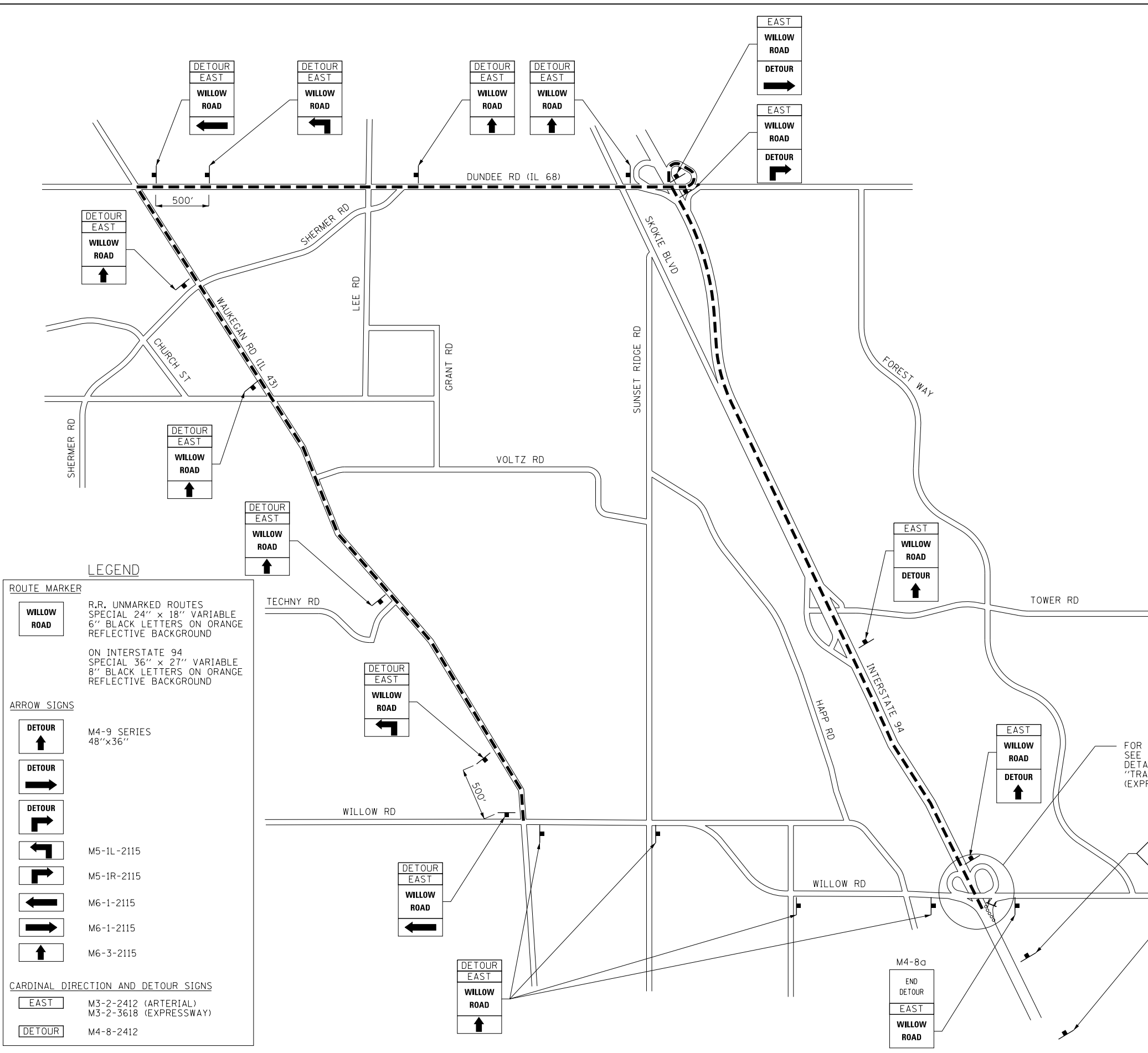

LEGEND

ROUTE MARKER

WILLOW ROAD
R.R. UNMARKED ROUTES
SPECIAL 24" x 18" VARIABLE
6" BLACK LETTERS ON ORANGE
REFLECTIVE BACKGROUND

ON INTERSTATE 94
SPECIAL 36" x 27" VARIABLE
8" BLACK LETTERS ON ORANGE
REFLECTIVE BACKGROUND

ARROW SIGNS

DETOUR (up arrow)
M4-9 SERIES
48" x 36"

DETOUR (right arrow)

DETOUR (left arrow)

DETOUR (down arrow)

M5-1L-2115
M5-1R-2115
M6-1-2115
M6-1-2115
M6-3-2115

CARDINAL DIRECTION AND DETOUR SIGNS

EAST
M3-2-2412 (ARTERIAL)
M3-2-3618 (EXPRESSWAY)

DETOUR
M4-8-2412

DETAIL A - PRE-DETOUR SIGN LAYOUT

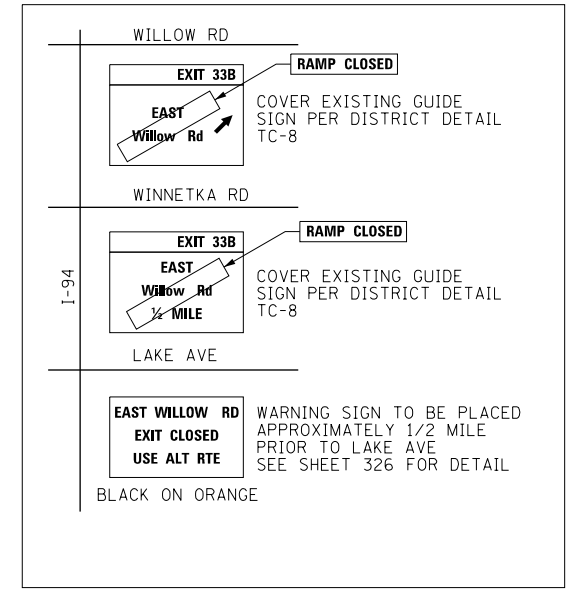

FOR RAMP CLOSURE DETAILS
SEE DISTRICT 1 STANDARD TC-8 AND
DETAIL A. TO BE PAID FOR AS
"TRAFFIC CONTROL AND PROTECTION
(EXPRESSWAYS)".

MESSAGE 1
**EB WILLOW
EXIT
CLOSED** **

MESSAGE 2
**DETOUR
AHEAD**

MESSAGE 3
**BEGINS
DATE**

- AMBER FLASHING LIGHT
- ** CHANGEABLE MESSAGE SIGN
SEE NOTE 2

FILE NAME =	USER NAME = BAW:ort	DESIGNED - JLV	REVISED -
G:\CH11\0158\Road\Sheets\160T35-SHT-STAGING-2-13.dgn		DRAWN - MNB	REVISED -
		CHECKED - RCB	REVISED -
		DATE - 10/31/2012	REVISED -

**STATE OF ILLINOIS
DEPARTMENT OF TRANSPORTATION**

**INTERSTATE 94 RAMP D DETOUR PLAN
STAGE 2**

SCALE: N.T.S. SHEET NO. 135 OF 919 SHEETS

F.A.P. RTE.	SECTION	COUNTY	TOTAL SHEETS	SHEET NO.
305	(1920.01,1518,2022&1922,4BR)	COOK	919	135
FED. ROAD DIST. NO. 1 ILLINOIS FED. AID PROJECT			CONTRACT NO. 60T35	