



LEGEND

----- PAVEMENT CONSTRUCTION STAGE BOUNDARIES

NOTES:

1. A NARRATIVE OF THE CONSTRUCTION STAGING FOR THIS INTERSECTION CAN BE FOUND ON SHEET 146.
2. THE STAGING BOUNDARIES PRESENTED IN THIS SHEET AND IN THE STAGE DETAIL SHEETS ARE A SUGGESTED METHOD OF CONSTRUCTION. THE CONTRACTOR CAN PROPOSE ALTERNATIVE METHOD(S) WITH PRIOR APPROVAL OF THE ENGINEER AND IN ADHERENCE OF IDOT POLICIES.
3. A QUANTITY OF TEMPORARY PAVEMENT HAS BEEN INCLUDED FOR INTERSECTION GRADING BETWEEN STAGES.

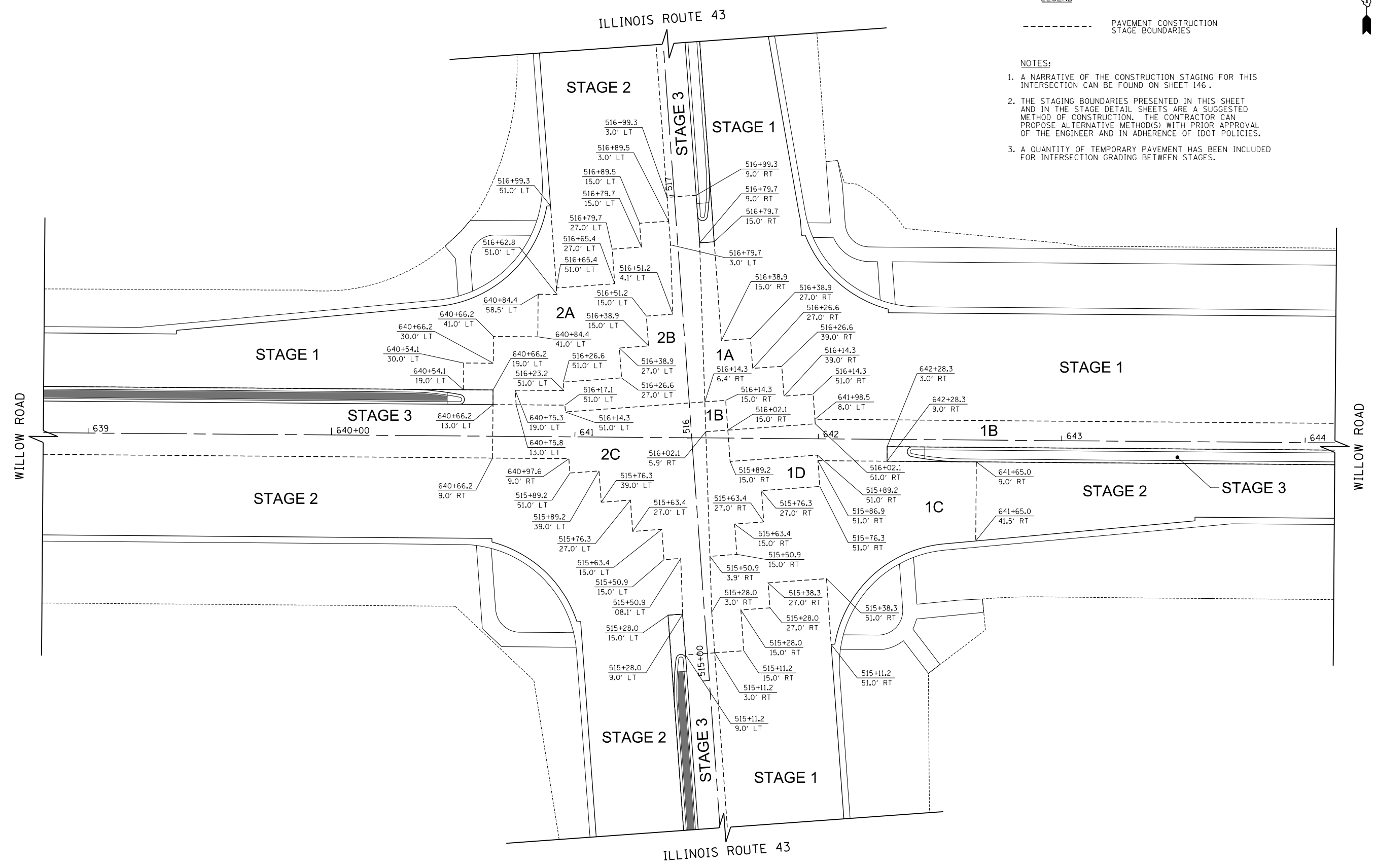

FILE NAME =	USER NAME = BAWtor.t	DESIGNED - ACW	REVISED -
G:\CH11\0158\Road\Road-GV\Sheets\0160T35-SHT-STAGING-WILWAU.dgn		DRAWN - ACW	REVISED -
	PLOT SCALE = 40.000' / in.	CHECKED - DBC	REVISED -
	PLOT DATE = 11/29/2012	DATE - 10/31/2012	REVISED -

**STATE OF ILLINOIS
DEPARTMENT OF TRANSPORTATION**

**SUGGESTED CONSTRUCTION PROCEDURES AND
MAINTENANCE OF TRAFFIC - CONSTRUCTION STAGING LIMITS
WILLOW ROAD AT ILLINOIS ROUTE 43**

SCALE: 1" = 20' SHEET NO. 147 OF 919 SHEETS

F.A.P. RTE.	SECTION	COUNTY	TOTAL SHEETS	SHEET NO.
305	(1920.01,1518,2022&1922.4B)R	COOK	919	147
CONTRACT NO. 60T35				
FED. ROAD DIST. NO. 1 ILLINOIS FED. AID PROJECT				