

FOR LEGEND AND NOTES  
SEE SHEET NO. 156

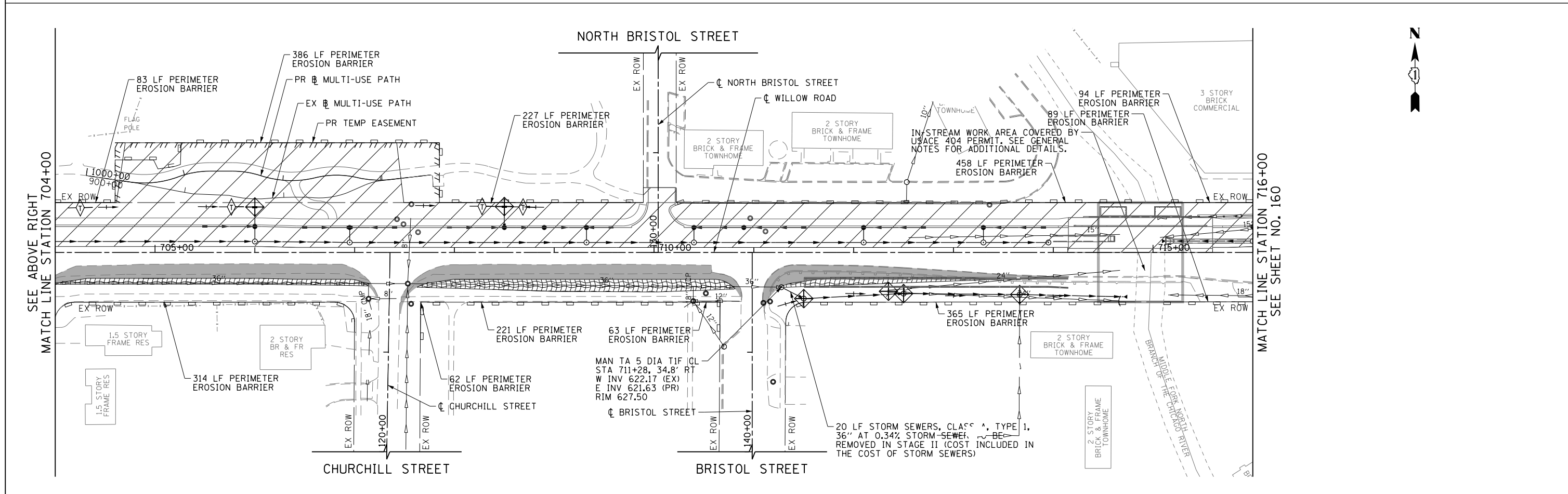

|   |                     |                |   |   |   |                             |  |                |                    |                 |  |
|---|---------------------|----------------|---|---|---|-----------------------------|--|----------------|--------------------|-----------------|--|
| FILE NAME = G:\CH11\0158\Road\Sheets\160T35-SHT-EROS-1-04.dgn | USER NAME = BAW\ort | DESIGNED - JLV | REVISED -   | <b>STATE OF ILLINOIS<br/>DEPARTMENT OF TRANSPORTATION</b> | <b>WILLOW ROAD EROSION CONTROL PLAN<br/>STAGE 1</b> | F.A.P. RT. = 305            | SECTION = (1920.01,1518,2022&1922,4BR) | COUNTY = COOK  | TOTAL SHEETS = 919 | SHEET NO. = 159 |  |
| PLOT SCALE = 100.000' / in.                                   | CHECKED - RCB       | REVISIED -     | SCALE: 1" = 50'                                     |   |   | SHEET NO. 159 OF 919 SHEETS | STA. 693+00                            | TO STA. 716+00 | CONTRACT NO. 60T35 |                 |  |
| PLOT DATE = 11/1/2012   | DATE = 10/31/2012   | REVISIED -     | FED. ROAD DIST. NO. 1   ILLINOIS   FED. AID PROJECT |   |   |                             |  |                |                    |                 |  |
|   |                     |                |   |   |   |                             |  |                |                    |                 |  |