

KRAFT FOODS

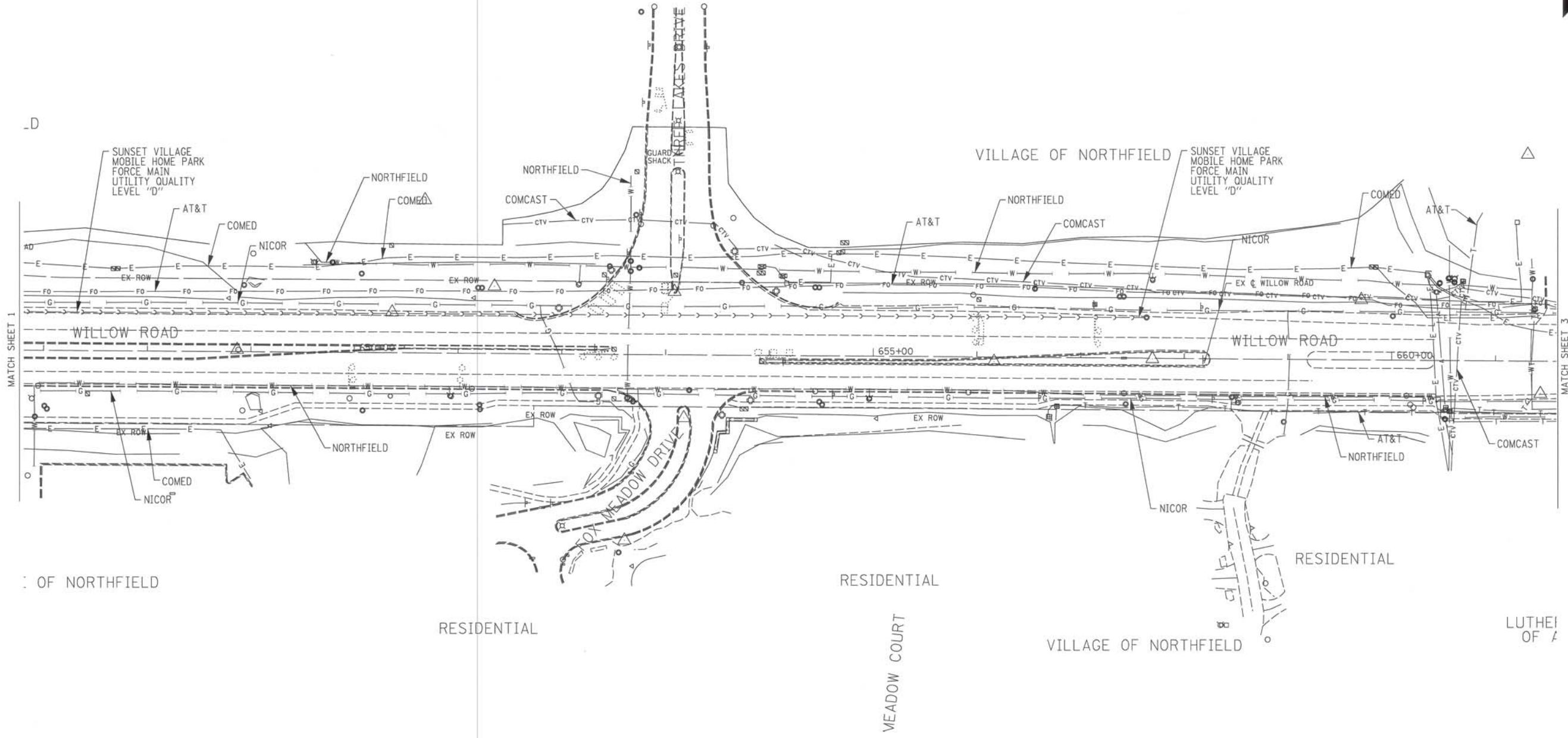

.D



OF NORTHFIELD

RESIDENTIAL

RESIDENTIAL

MEADOW COURT

VILLAGE OF NORTHFIELD

RESIDENTIAL

LUTHEI OF A

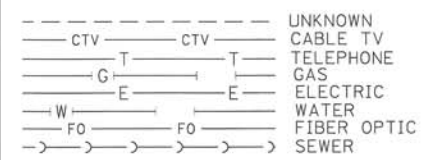

**UTILITY OWNERS**  
 AT&T = TELEPHONE  
 AT&T = FIBER OPTIC  
 NICOR = GAS  
 COMCAST = CABLE TV  
 COMCAST = FIBER OPTIC  
 COMED = ELECTRIC  
 SPRINT = FIBER OPTIC  
 NORTHFIELD = WATER  
 QWEST = FIBER OPTIC  
 EXCELON-COMED = FIBER OPTIC  
 SUNSET VILLAGE MOBILE HOMES - FORCE MAIN

Utilities shown on these plans as depicted in the legend have been investigated by Cardno TBE in accordance with SUE Industry Standards. All other information shown has been provided to Cardno TBE by others. Cardno TBE's "B" SUE field investigation was performed 1/16/12 through 2/18/12. Changes to utilities after 2/18/12 may have been made and therefore may result in variances from this plan. Consideration should be given to updating this plan if deemed advisable prior to final design and construction.

ALL UTILITIES SHOWN QUALITY LEVEL "B" UNLESS NOTED OTHERWISE.

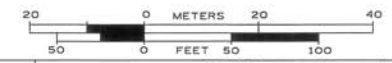

TBE Job No. IL09510464\_465  
 SUE Plan Page: 2 of 13

Utility Quality Level "A" : visually verified Test Hole  
 Utility Quality Level "B" : Designating/non Visually Verified Test Hole  
 Utility Quality Level "C" : Research with Survey  
 Utility Quality Level "D" : Records Research

DESIGNED	LP	REVISED
DRAWN	KLC	REVISED
CHECKED	KFS	REVISED
DATE	3/27/12	REVISED

STATE OF ILLINOIS  
 DEPARTMENT OF TRANSPORTATION

Willow Road along I-94  
 Northfield, Illinois

F.A. RTE.	SECTION	COUNTY	TOTAL SHEETS	SHEET NO.
	N/A	Cook		
Contract No. N/A				
FED. ROAD DIST. NO. [ILLINOIS] IDOT Project No.				