

SEE SHEET 265
MATCH LINE STATION 517+40
ILLINOIS ROUTE 43/WAUKEGAN ROAD

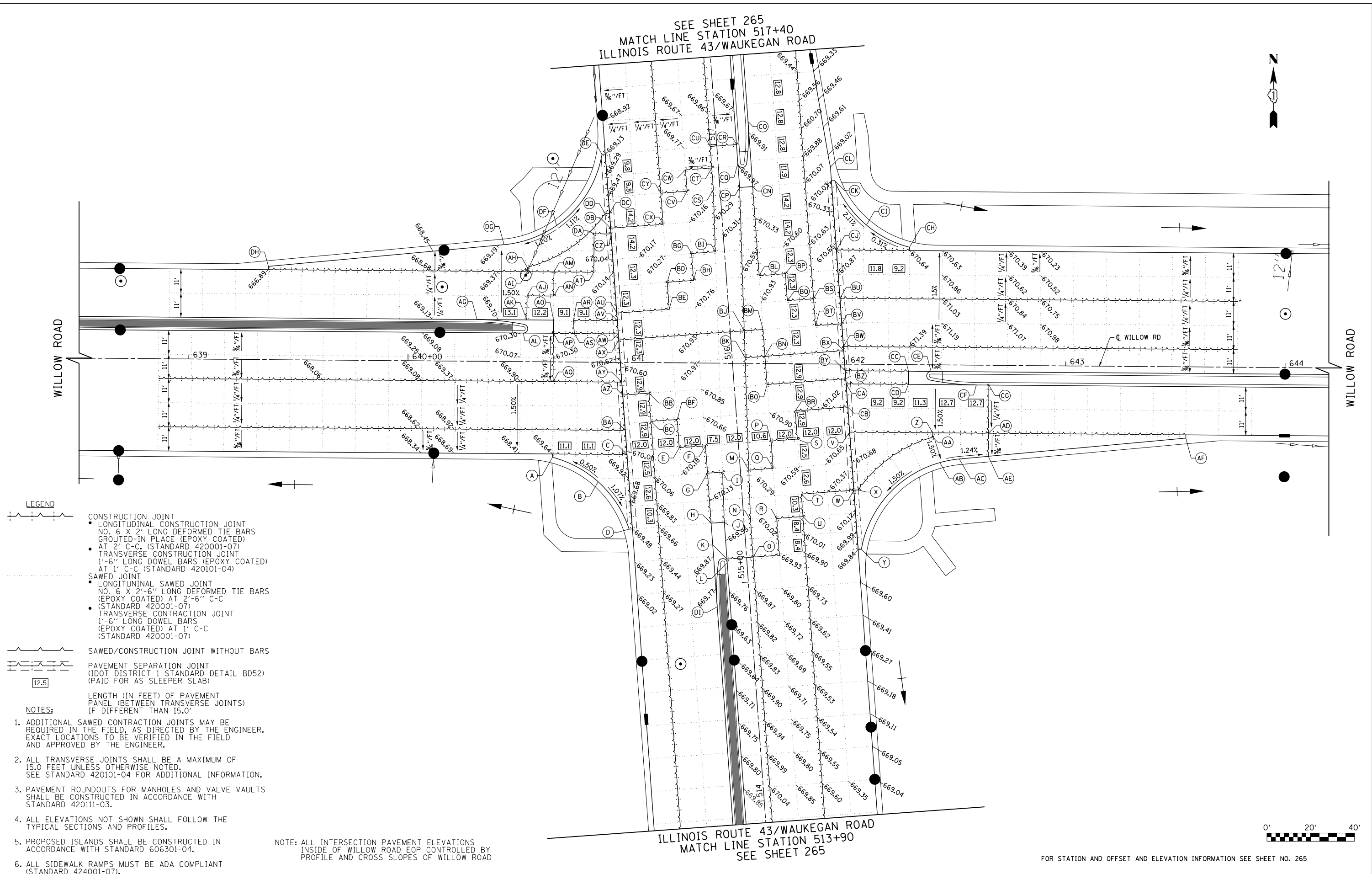

LEGEND

- LONGITUDINAL CONSTRUCTION JOINT NO. 6 X 2' LONG DEFORMED TIE BARS GROUTED-IN PLACE (EPOXY COATED) AT 2' C-C. (STANDARD 42001-07)
- TRANSVERSE CONSTRUCTION JOINT 1'-6" LONG DOWEL BARS (EPOXY COATED) AT 1' C-C (STANDARD 420101-04)
- SAWED JOINT
 - LONGITUDINAL SAWED JOINT NO. 6 X 2'-6" LONG DEFORMED TIE BARS (EPOXY COATED) AT 2'-6" C-C (STANDARD 42001-07)
 - TRANSVERSE CONTRACTION JOINT 1'-6" LONG DOWEL BARS (EPOXY COATED) AT 1' C-C (STANDARD 42001-07)
- SAWED/CONSTRUCTION JOINT WITHOUT BARS
- PAVEMENT SEPARATION JOINT (IDOT DISTRICT 1 STANDARD DETAIL BD52) (PAID FOR AS SLEEPER SLAB)

- NOTES:
1. ADDITIONAL SAWED CONTRACTION JOINTS MAY BE REQUIRED IN THE FIELD, AS DIRECTED BY THE ENGINEER. EXACT LOCATIONS TO BE VERIFIED IN THE FIELD AND APPROVED BY THE ENGINEER.
 2. ALL TRANSVERSE JOINTS SHALL BE A MAXIMUM OF 15.0 FEET UNLESS OTHERWISE NOTED. SEE STANDARD 420101-04 FOR ADDITIONAL INFORMATION.
 3. PAVEMENT ROUNDOUTS FOR MANHOLES AND VALVE VAULTS SHALL BE CONSTRUCTED IN ACCORDANCE WITH STANDARD 420111-03.
 4. ALL ELEVATIONS NOT SHOWN SHALL FOLLOW THE TYPICAL SECTIONS AND PROFILES.
 5. PROPOSED ISLANDS SHALL BE CONSTRUCTED IN ACCORDANCE WITH STANDARD 606301-04.
 6. ALL SIDEWALK RAMPS MUST BE ADA COMPLIANT (STANDARD 424001-07).

NOTE: ALL INTERSECTION PAVEMENT ELEVATIONS INSIDE OF WILLOW ROAD EOP CONTROLLED BY PROFILE AND CROSS SLOPES OF WILLOW ROAD

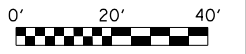

STATE OF ILLINOIS
DEPARTMENT OF TRANSPORTATION

WILLOW ROAD INTERSECTION PAVING PLAN
AT ILLINOIS ROUTE 43 / WAUKEGAN RD

FILE NAME =	USER NAME = BAW\ort	DESIGNED -	REVISED -
G:\CH11\0158\Road\Sheets\0160T35-SHT-INTERSEC-01.dgn		DRAWN -	REVISED -
		CHECKED -	REVISED -
		DATE - 10/31/2012	REVISED -

SCALE:	SHEET NO. 264 OF 919 SHEETS
--------	-----------------------------

F.A.P. RTE.	SECTION	COUNTY	TOTAL SHEETS	SHEET NO.
305	(1920.01,1518,2022&1922.4BR	COOK	919	264
FED. ROAD DIST. NO. 1 ILLINOIS FED. AID PROJECT			CONTRACT NO. 60T35	

FOR STATION AND OFFSET AND ELEVATION INFORMATION SEE SHEET NO. 265

ILLINOIS ROUTE 43/WAUKEGAN ROAD
MATCH LINE STATION 513+90
SEE SHEET 265