

MATCH LINE STATION 815+00
SEE BELOW LEFT

- NOTES:
1. ELEVATIONS ARE GIVEN EVERY 25' UNLESS OTHERWISE NOTED.
 2. CROSS-SLOPE OF AUXILIARY LANE AND SHOULDER ARE 2.0% AND 4.0%, RESPECTIVELY, UNLESS OTHERWISE NOTED.

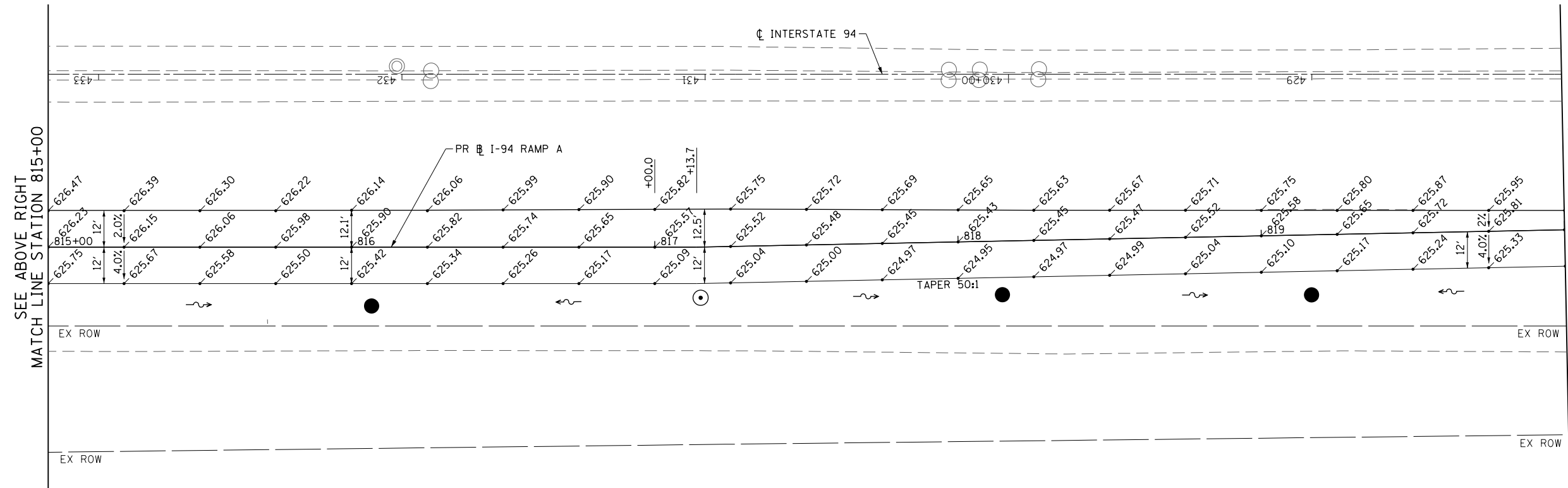

SEE ABOVE RIGHT
MATCH LINE STATION 815+00

MATCH LINE STATION 820+00
SEE SHEET NO. 273

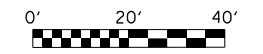

FILE NAME = G:\CH11\0158\Road\Sheets\0160T35-SHT-INTERSEC-09.dgn	USER NAME = BAW\rtort	DESIGNED - JLV	REVISED -	STATE OF ILLINOIS DEPARTMENT OF TRANSPORTATION	INTERSTATE 94 RAMP A AUXILIARY LANE PAVING PLAN			F.A.P. RTE. 305	SECTION (1920.01,1518,2022&1922.4)BR	COUNTY COOK	TOTAL SHEETS 919	SHEET NO. 272
	PLOT SCALE = 40.000' / in.	CHECKED - RCB	REVISED -		SCALE: 1" = 20'	SHEET NO. 272 OF 919 SHEETS	STA. 810+00	TO STA. 820+00	CONTRACT NO. 60T35			
	PLOT DATE = 12/6/2012	DATE - 10/31/2012	REVISED -		FED. ROAD DIST. NO. 1 ILLINOIS FED. AID PROJECT							