

PILE DATA
 (See 3rd note on Sheet 3 of 30)
 Type: Metal Shell-14 in. dia. x 0.312 in. walls with Pile Shoes
 Nominal Required Bearing: 516 kips
 Factored Resistance Available: 284 kips
 Est. Length: 61'
 No. Production Piles: 15
 No. Test Piles: 1

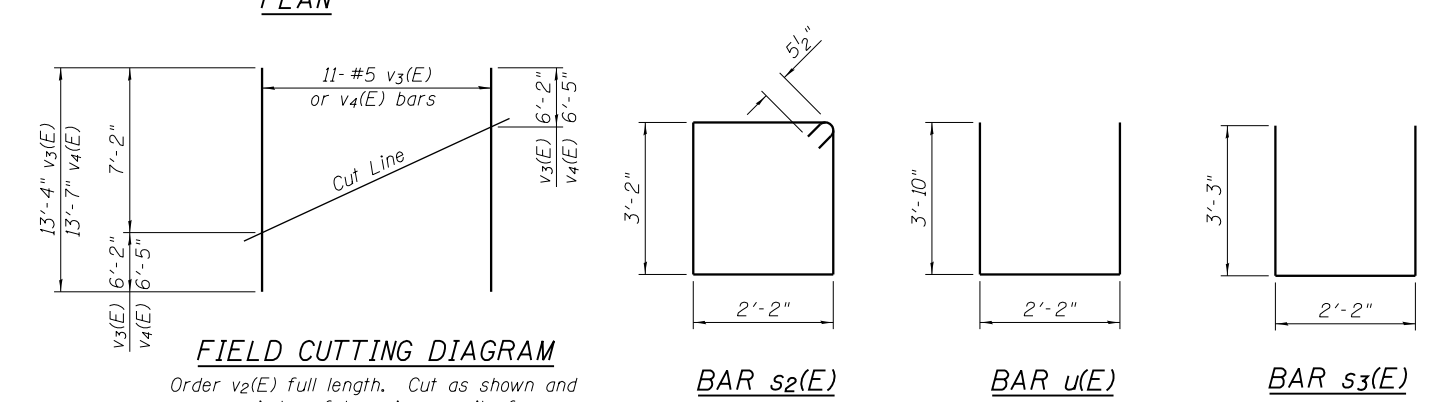

SEC. THRU ABUT.

BILL OF MATERIAL

| Bar | No. | Size | Length | Shape |
|---|-----|------|---------|-------|
| h ₃ (E) | 32 | #5 | 13'-1" | — |
| p ₂ (E) | 4 | #5 | 14'-0" | — |
| p ₃ (E) | 4 | #5 | 19'-0" | — |
| p ₄ (E) | 12 | #8 | 37'-5" | — |
| p ₅ (E) | 12 | #8 | 39'-8" | — |
| s ₂ (E) | 74 | #5 | 11'-7" | □ |
| s ₃ (E) | 35 | #5 | 8'-8" | □ |
| v(E) | 152 | #5 | 4'-4" | — |
| v ₃ (E) | 11 | #5 | 13'-4" | — |
| v ₄ (E) | 11 | #5 | 13'-7" | — |
| u(E) | 8 | #6 | 9'-8" | □ |
| Structure Excavation | | | Cu. Yd. | 270 |
| Concrete Structures | | | Cu. Yd. | 32.1 |
| Reinforcement Bars, Epoxy Coated | | | Pound | 5,370 |
| Furnishing Metal Shell Piles 14" x 0.312" | | | Foot | 915 |
| Driving Piles | | | Foot | 915 |
| Test Pile Metal Shells | | | Each | 1 |
| Pile Shoes | | | Each | 16 |

Notes:
 Four steps monolithically with cap.
 For details of Bar Splicers, see sheet 25 of 30.
 For details of piles, see sheet 24 of 30.

12/5/2012 5:46:19 PM - G:\CHIN\058\Bridges\CADD\Sheets\0162844-D160135-22-EABUT.dgn



| | | |
|--------------------------------|----------------|-----------|
| USER NAME = jrmickow | DESIGNED - JRM | REVISED - |
| PLOT SCALE = 8:0.0000 1" = 10' | CHECKED - MDS | REVISED - |
| PLOT DATE = 12/5/2012 | DRAWN - DMG | REVISED - |
| | CHECKED - MDS | REVISED - |

STATE OF ILLINOIS
 DEPARTMENT OF TRANSPORTATION

EAST ABUTMENT
 STRUCTURE NO. 016-2844

| | | | | |
|--------------------|------------------------------|--------|---------------------------|-----------|
| F.A.P. RTE. | SECTION | COUNTY | TOTAL SHEETS | SHEET NO. |
| 0305 | (1920.01,1518,2022&1922,4BIR | COOK | 919 | 472 |
| CONTRACT NO. 60T35 | | | ILLINOIS FED. AID PROJECT | |

SHEET NO. 22 OF 30 SHEETS