

**STAGE 1**  
**IL ROUTE 19 AT CPR BRIDGE (LOOKING EAST)**

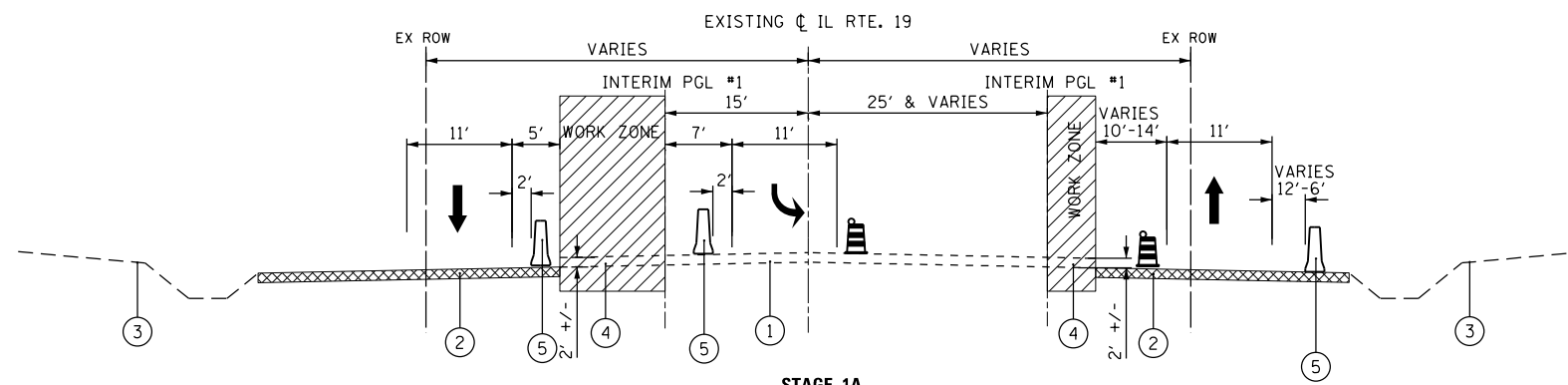

**STAGE 1A**  
**IL ROUTE 19 AT CPR BRIDGE (LOOKING EAST)**

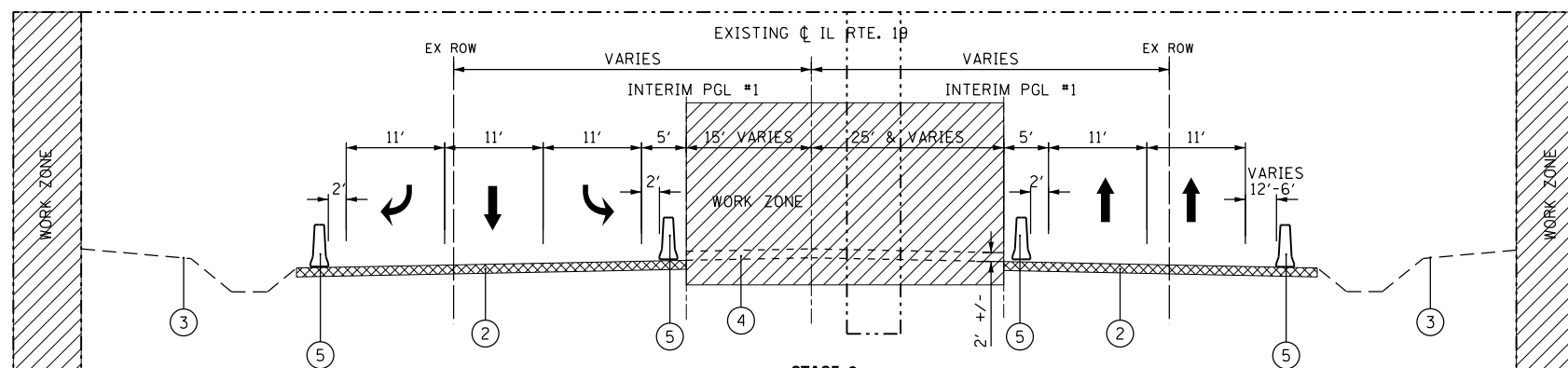

**STAGE 2**  
**IL ROUTE 19 AT CPR BRIDGE (LOOKING EAST)**  
**CONSTRUCT CPR BRIDGE**  
**12'-6" TEMPORARY VERTICAL CLEARANCE-NO TRUCKS- TRUCK DETOUR ACTIVE**

**LEGEND**

- ① EXISTING PAVEMENT
  - ② EXISTING TEMPORARY PAVEMENT
  - ③ EXISTING GROUND
  - ④ CONSTRUCT TEMPORARY PAVEMENT
  - ⑤ TEMPORARY CONCRETE BARRIER
- WORK ZONE
  - TEMPORARY PAVEMENT
  - DIRECTION OF TRAFFIC
  - DRUM WITH STEADY BURNING LIGHT



USER NAME = user	DESIGNED - JJS	REVISED -
PLOT SCALE = *SCALE*	DRAWN - TT	REVISED -
PLOT DATE = 11/2/2012	CHECKED - LGP	REVISED -
	DATE - 11-02-2012	REVISED -

**STATE OF ILLINOIS**  
**DEPARTMENT OF TRANSPORTATION**

**MOT TYPICAL CROSS SECTION**  
**IL ROUTE 19 (IRVING PARK ROAD)**

SCALE: NTS SHEET NO. 3 OF 29 SHEETS STA. TO STA.

F.A.U. RTE.	SECTION	COUNTY	TOTAL SHEETS	SHEET NO.
1321	32VB	DUPAGE	388	52
CONTRACT NO. 60W01				
ILLINOIS FED. AID PROJECT				