

STAGE 3
IL ROUTE 19 AT CPR BRIDGE (LOOKING EAST)
12'-6" TEMPORARY VERTICAL CLEARANCE-NO TRUCKS- TRUCK DETOUR ACTIVE

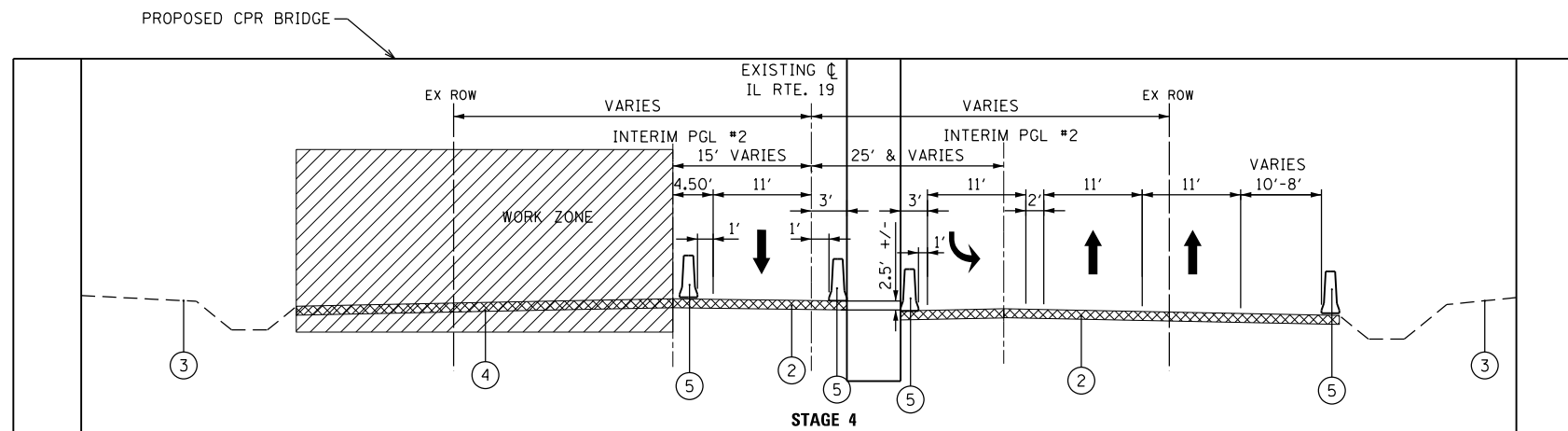

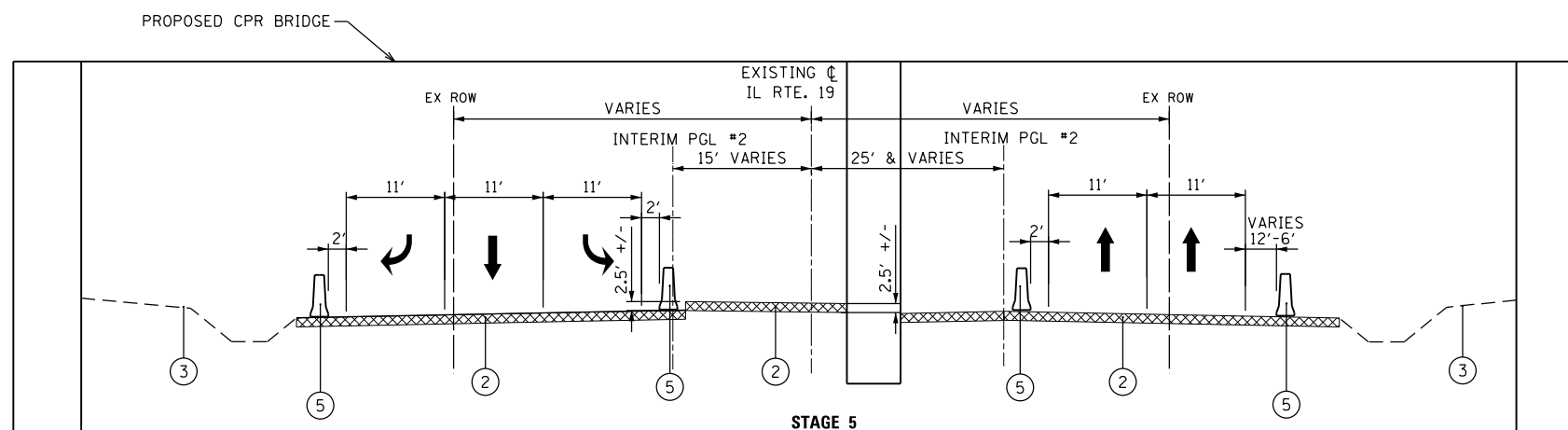

STAGE 4
IL ROUTE 19 AT CPR BRIDGE (LOOKING EAST)
12'-6" TEMPORARY VERTICAL CLEARANCE-NO TRUCKS- TRUCK DETOUR ACTIVE

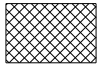

STAGE 5
IL ROUTE 19 AT CPR BRIDGE (LOOKING EAST)
14'-10" VERTICAL CLEARANCE-NO TRUCK DETOUR ROUTE

LEGEND

- ① EXISTING PAVEMENT
- ② EXISTING TEMPORARY PAVEMENT
- ③ EXISTING GROUND
- ④ CONSTRUCT TEMPORARY PAVEMENT
- ⑤ TEMPORARY CONCRETE BARRIER
-  WORK ZONE
-  TEMPORARY PAVEMENT
-  DIRECTION OF TRAFFIC
-  DRUM WITH STEADY BURNING LIGHT



USER NAME = user	DESIGNED - JJS	REVISED -
PLOT SCALE = *SCALE*	DRAWN - TT	REVISED -
PLOT DATE = 11/2/2012	CHECKED - LGP	REVISED -
	DATE - 11-02-2012	REVISED -

STATE OF ILLINOIS
DEPARTMENT OF TRANSPORTATION

MOT TYPICAL CROSS SECTION
IL ROUTE 19 (IRVING PARK ROAD)

SCALE: NTS SHEET NO. 4 OF 29 SHEETS STA. TO STA.

F.A.U. RTE. 1321	SECTION 32VB	COUNTY DUPAGE	TOTAL SHEETS 388	SHEET NO. 53
CONTRACT NO. 60W01				
ILLINOIS FED. AID PROJECT				