

LEGEND

	EXISTING	PROPOSED		EXISTING	PROPOSED
STORM SEWER			DITCH		
SUBSURFACE PAVEMENT DRAIN			OUTLET		
INLET			CULVERT SIZE-TYPE		
CATCH BASIN			SLOTTED DRAIN		
PIPE CALL OUT			SANITARY SEWER		
STRUCTURE CALL OUT			SANITARY MANHOLE		
MANHOLE			WATER VALVE VAULT		
SWALE					

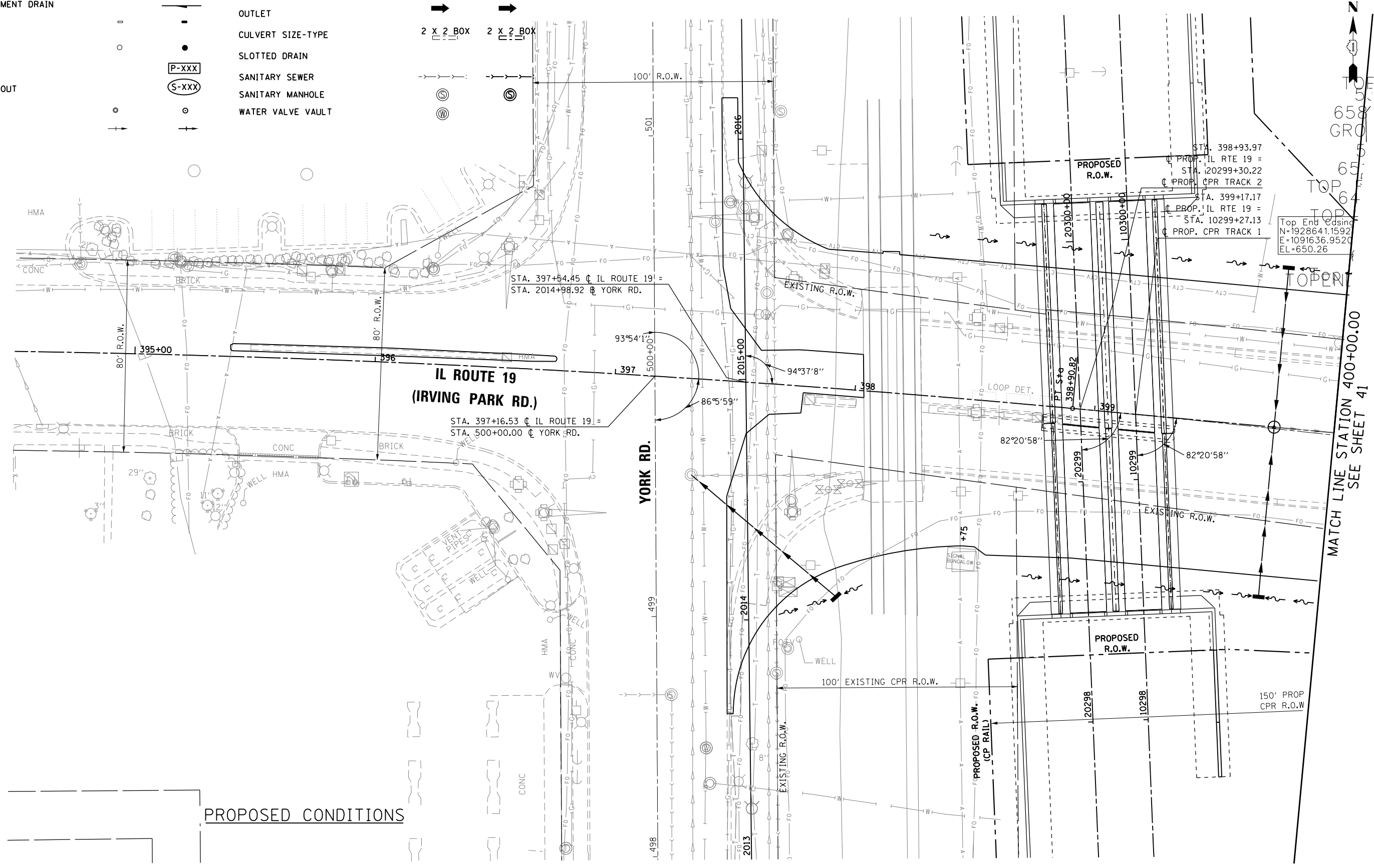
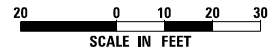

PROPOSED CONDITIONS

USER NAME = user	DESIGNED - MPK	REVISED -
	DRAWN - ML	REVISED -
PLOT SCALE = *SCALE*	CHECKED - LGP	REVISED -
PLOT DATE = 11/2/2012	DATE - 11-02-2012	REVISED -

**STATE OF ILLINOIS
 DEPARTMENT OF TRANSPORTATION**

PROPOSED DRAINAGE PLAN			
IL ROUTE 19 (IRVING PARK RD.)			
SCALE: 1"=20'	SHEET NO. OF SHEETS	STA. 394+50 TO STA. 400+00	

F.A.U. RTE.	SECTION	COUNTY	TOTAL SHEETS	SHEET NO.
1321	32VB	DUPAGE	388	83
CONTRACT NO. 60W01				
ILLINOIS FED. AID PROJECT				