

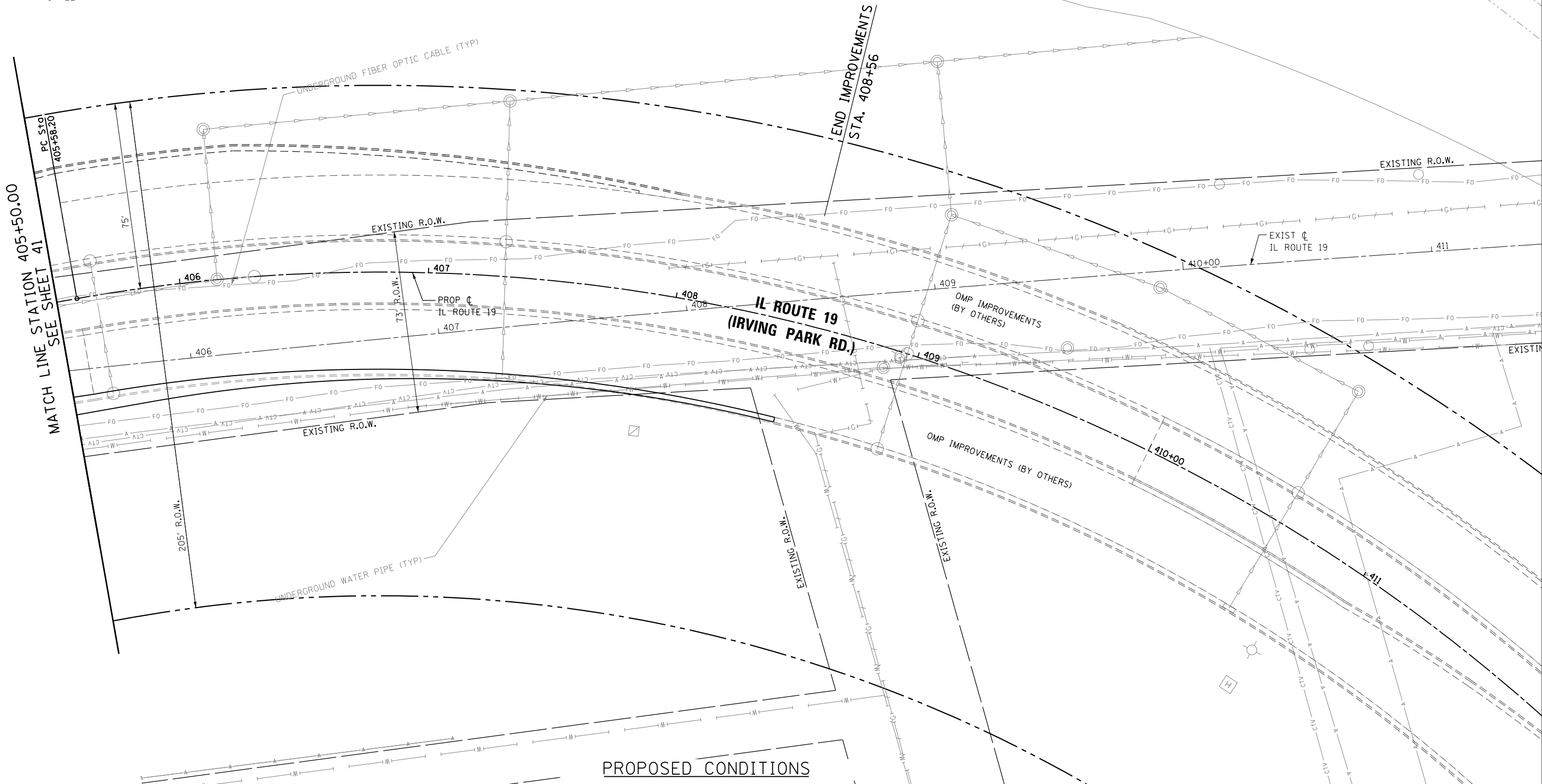

LEGEND

	EXISTING	PROPOSED		EXISTING	PROPOSED
STORM SEWER			DITCH		
SUBSURFACE PAVEMENT DRAIN			OUTLET		
INLET			CULVERT SIZE-TYPE		
CATCH BASIN			SLOTTED DRAIN		
PIPE CALL OUT			SANITARY SEWER		
STRUCTURE CALL OUT			SANITARY MANHOLE		
MANHOLE			WATER VALVE VAULT		
SWALE					



PROPOSED CONDITIONS

USER NAME = user	DESIGNED - MPK	REVISED -
	DRAWN - ML	REVISED -
PLOT SCALE = *SCALE*	CHECKED - LGP	REVISED -
PLOT DATE = 11/2/2012	DATE - 11-02-2012	REVISED -

STATE OF ILLINOIS
DEPARTMENT OF TRANSPORTATION

PROPOSED DRAINAGE PLAN
IL ROUTE 19 (IRVING PARK RD.)

SCALE: 1" = 20' SHEET NO. OF SHEETS STA. 405+50 TO STA. 407+95.42

F.A.U. RTE.	SECTION	COUNTY	TOTAL SHEETS	SHEET NO.
1321	32VB	DUPAGE	388	85
CONTRACT NO. 60W01				
ILLINOIS FED. AID PROJECT				