

|              |               |
|--------------|---------------|
| DATE         |               |
| BY           |               |
| FINAL SURVEY | SURVEYED      |
| NOTE BOOK    | PLOTTED       |
| NO.          | TEMPLATE      |
|              | AREAS CHECKED |
|              | AREAS CHECKED |

|                 |               |
|-----------------|---------------|
| DATE            |               |
| BY              |               |
| ORIGINAL SURVEY | SURVEYED      |
| NOTE BOOK       | PLOTTED       |
| NO.             | TEMPLATE      |
|                 | AREAS CHECKED |
|                 | AREAS CHECKED |

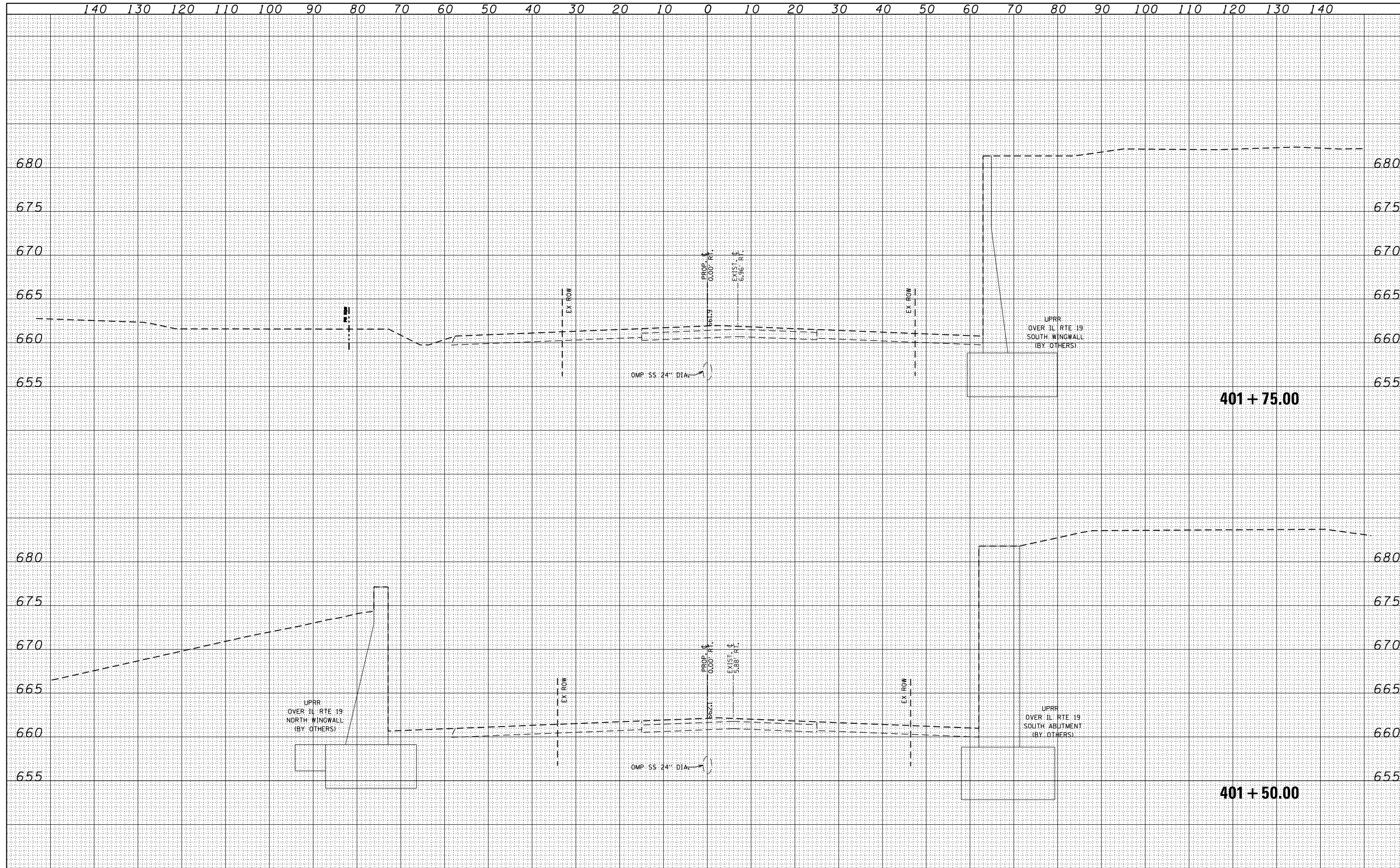

|           |              |
|-----------|--------------|
| USER NAME | = user       |
| DESIGNED  | - MPK        |
| DRAWN     | - ML         |
| CHECKED   | - LGP        |
| DATE      | - 11-02-2012 |

|         |   |
|---------|---|
| REVISED | - |
| REVISED | - |
| REVISED | - |
| REVISED | - |

**STATE OF ILLINOIS  
DEPARTMENT OF TRANSPORTATION**

**IRVING PARK (IL 19)  
CROSS SECTIONS- STAGES 3 THROUGH 5**

SCALE: 1"=10'H; 1"=5'V SHEET NO. 9 OF 19 SHEETS STA. 401+50.00 TO STA. 401+75.00

|                           |         |        |              |           |
|---------------------------|---------|--------|--------------|-----------|
| F.A.U. RTE.               | SECTION | COUNTY | TOTAL SHEETS | SHEET NO. |
| 1321                      | 32VB    | DUPAGE | 388          | 287       |
| CONTRACT NO. 60W01        |         |        |              |           |
| ILLINOIS FED. AID PROJECT |         |        |              |           |