

DATE _____
 BY _____
 SURVEYED _____
 PLOTTED _____
 TEMPLATE _____
 NOTE BOOK _____
 AREAS CHECKED _____

DATE _____
 BY _____
 SURVEYED _____
 PLOTTED _____
 TEMPLATE _____
 NOTE BOOK _____
 AREAS CHECKED _____

FILE NAME = ... \D60801-SHT-VSC-Rail.dgn

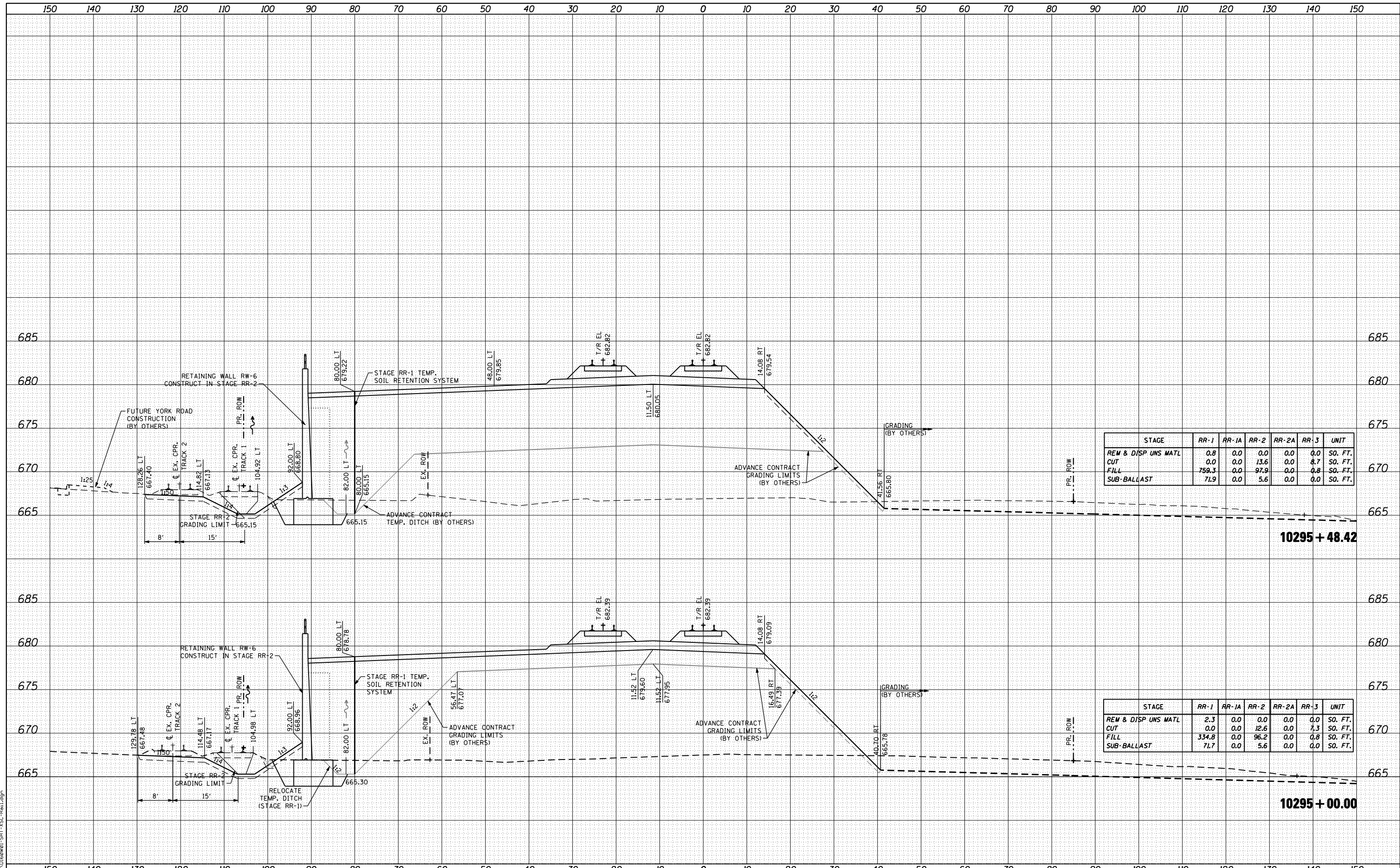

STAGE	RR-1	RR-1A	RR-2	RR-2A	RR-3	UNIT
REM & DISP UNS MATL	0.8	0.0	0.0	0.0	0.0	SO. FT.
CUT	0.0	0.0	13.6	0.0	8.7	SO. FT.
FILL	759.3	0.0	97.9	0.0	0.8	SO. FT.
SUB-BALLAST	71.9	0.0	5.6	0.0	0.0	SO. FT.

STAGE	RR-1	RR-1A	RR-2	RR-2A	RR-3	UNIT
REM & DISP UNS MATL	2.3	0.0	0.0	0.0	0.0	SO. FT.
CUT	0.0	0.0	12.6	0.0	7.3	SO. FT.
FILL	334.8	0.0	96.2	0.0	0.8	SO. FT.
SUB-BALLAST	71.7	0.0	5.6	0.0	0.0	SO. FT.



USER NAME = natterm
 DESIGNED - NMR
 DRAWN - NMR
 CHECKED - MPH
 DATE - 11-02-2012

REVISÉ -
 REVISÉ -
 REVISÉ -
 REVISÉ -

STATE OF ILLINOIS
 DEPARTMENT OF TRANSPORTATION

CANADIAN PACIFIC RAILWAY
 CROSS SECTIONS

SCALE: SHEET NO. 9 OF 28 SHEETS STA. 10295+00.00 TO STA. 10295+48.42

F.A.U. RTE.	SECTION	COUNTY	TOTAL SHEETS	SHEET NO.
1321	32VB	DUPAGE	388	369
ILLINOIS FED. AID PROJECT			CONTRACT NO. 60W01	