

DATE	
BY	
FINISHED SURVEY	
PLOTTED	
TEMPLATE	
NOTE BOOK	
AREAS CHECKED	
NO.	

DATE	
BY	
ORIGINAL SURVEY	
PLOTTED	
TEMPLATE	
NOTE BOOK	
AREAS CHECKED	
NO.	

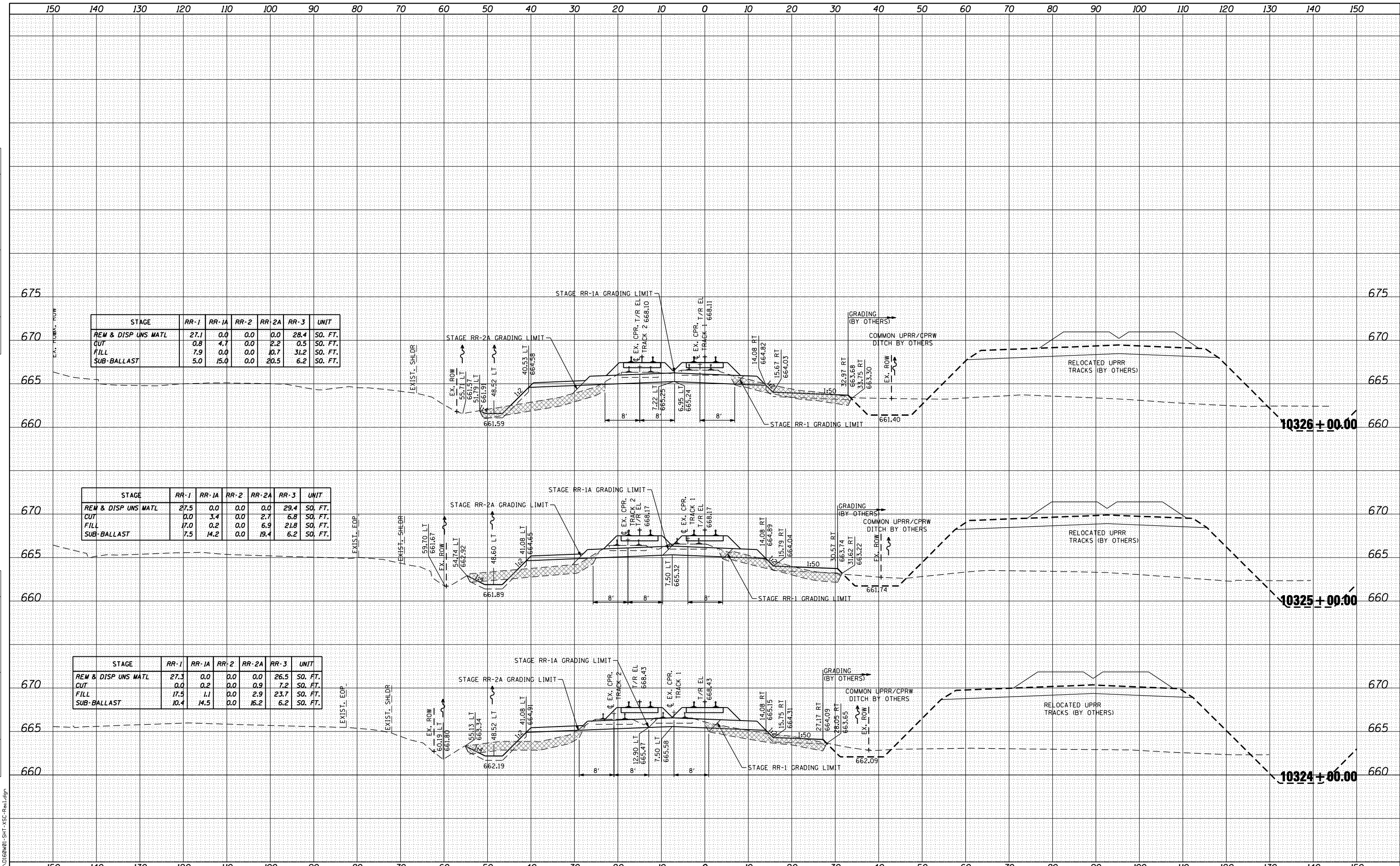

STAGE	RR-1	RR-1A	RR-2	RR-2A	RR-3	UNIT
REM & DISP UNS MATL	27.1	0.0	0.0	0.0	28.4	SO. FT.
CUT	0.8	4.1	0.0	2.2	0.5	SO. FT.
FILL	7.9	0.0	0.0	10.7	31.2	SO. FT.
SUB-BALLAST	5.0	15.0	0.0	20.5	6.2	SO. FT.

STAGE	RR-1	RR-1A	RR-2	RR-2A	RR-3	UNIT
REM & DISP UNS MATL	27.5	0.0	0.0	0.0	29.4	SO. FT.
CUT	0.0	3.4	0.0	2.7	6.8	SO. FT.
FILL	17.0	0.2	0.0	6.9	21.8	SO. FT.
SUB-BALLAST	7.5	14.2	0.0	19.4	6.2	SO. FT.

STAGE	RR-1	RR-1A	RR-2	RR-2A	RR-3	UNIT
REM & DISP UNS MATL	27.3	0.0	0.0	0.0	26.5	SO. FT.
CUT	0.0	0.2	0.0	0.9	7.2	SO. FT.
FILL	17.5	1.1	0.0	2.9	23.7	SO. FT.
SUB-BALLAST	10.4	14.5	0.0	16.2	6.2	SO. FT.

FILE NAME = ... \D060801-SHT-VSC-Rail.dwg



USER NAME = natterm	DESIGNED - NMR	REVISED -
PLOT SCALE = 20.0000' / IN.	DRAWN - NMR	REVISED -
PLOT DATE = 11/2/2012	CHECKED - MPH	REVISED -
	DATE - 11-02-2012	REVISED -

STATE OF ILLINOIS
DEPARTMENT OF TRANSPORTATION

CANADIAN PACIFIC RAILWAY
CROSS SECTIONS

SCALE: SHEET NO. 26 OF 28 SHEETS STA. 10324+00.00 TO STA. 10326+00.00

F.A.U. RTE. 1321	SECTION 32VB	COUNTY DUPAGE	TOTAL SHEETS 388	SHEET NO. 386
CONTRACT NO. 60W01			ILLINOIS FED. AID PROJECT	