

DATE	
BY	
SURVEYED	
PLOTTED	
TEMPLATE	
AREAS	
CHECKED	
NO.	

DATE	
BY	
SURVEYED	
PLOTTED	
TEMPLATE	
AREAS	
CHECKED	
NO.	

FILE NAME : ...\\D69081-SHT-VSC-Rail.dgn

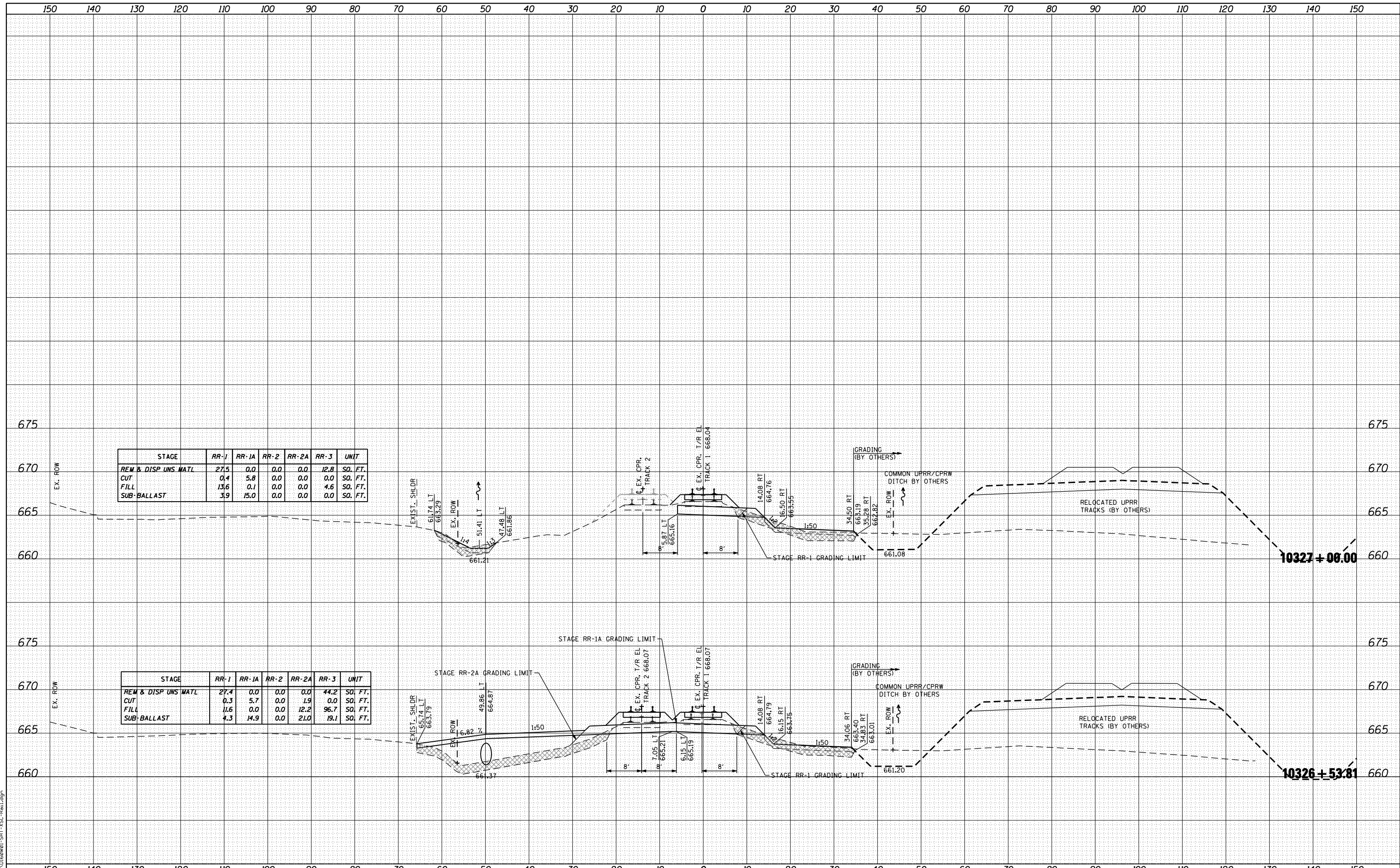

STAGE	RR-1	RR-1A	RR-2	RR-2A	RR-3	UNIT
REM & DISP UNS MATL	27.5	0.0	0.0	0.0	12.8	SO. FT.
CUT	0.4	5.8	0.0	0.0	0.0	SO. FT.
FILL	13.6	0.1	0.0	0.0	4.6	SO. FT.
SUB-BALLAST	3.9	15.0	0.0	0.0	0.0	SO. FT.

STAGE	RR-1	RR-1A	RR-2	RR-2A	RR-3	UNIT
REM & DISP UNS MATL	27.4	0.0	0.0	0.0	44.2	SO. FT.
CUT	0.3	5.7	0.0	1.9	0.0	SO. FT.
FILL	11.6	0.0	0.0	12.2	96.7	SO. FT.
SUB-BALLAST	4.3	14.9	0.0	21.0	19.1	SO. FT.



USER NAME = natterm
 DESIGNED - NMR
 DRAWN - NMR
 CHECKED - MPH
 DATE - 11-02-2012
 PLOT SCALE = 20.0000' / IN.
 PLOT DATE = 11/2/2012

REVISED -
 REVISED -
 REVISED -
 REVISED -

**STATE OF ILLINOIS
 DEPARTMENT OF TRANSPORTATION**

**CANADIAN PACIFIC RAILWAY
 CROSS SECTIONS**

SCALE: SHEET NO. 27 OF 28 SHEETS STA. 10326+53.81 TO STA. 10327+00.00

F.A.U. RTE.	SECTION	COUNTY	TOTAL SHEETS	SHEET NO.
1321	32VB		388	387
CONTRACT NO. 60W01			ILLINOIS FED. AID PROJECT	