

BEGIN IMPROVEMENT
STA. 547+04

- 1 STA. 550+75.0, 34.0' RT.
INLET TA T23F&G
RIM EL. = 683.19
INV. EL. = 680.53
- 2 STA. 549+05.0, 34.0' RT.
CB TA 4DIA T23F&G
RIM EL. = 682.46
INV. EL. = 679.69 (SE)
INV. EL. = 679.69 (NE)
- 3 STA. 549+05.0, 41.0' LT.
MAN ADJUST
RIM EL. = 683.00
INV. EL. = 674.40 (SE)
INV. EL. = 674.40 (NW)
INV. EL. = 678.07 (SW)

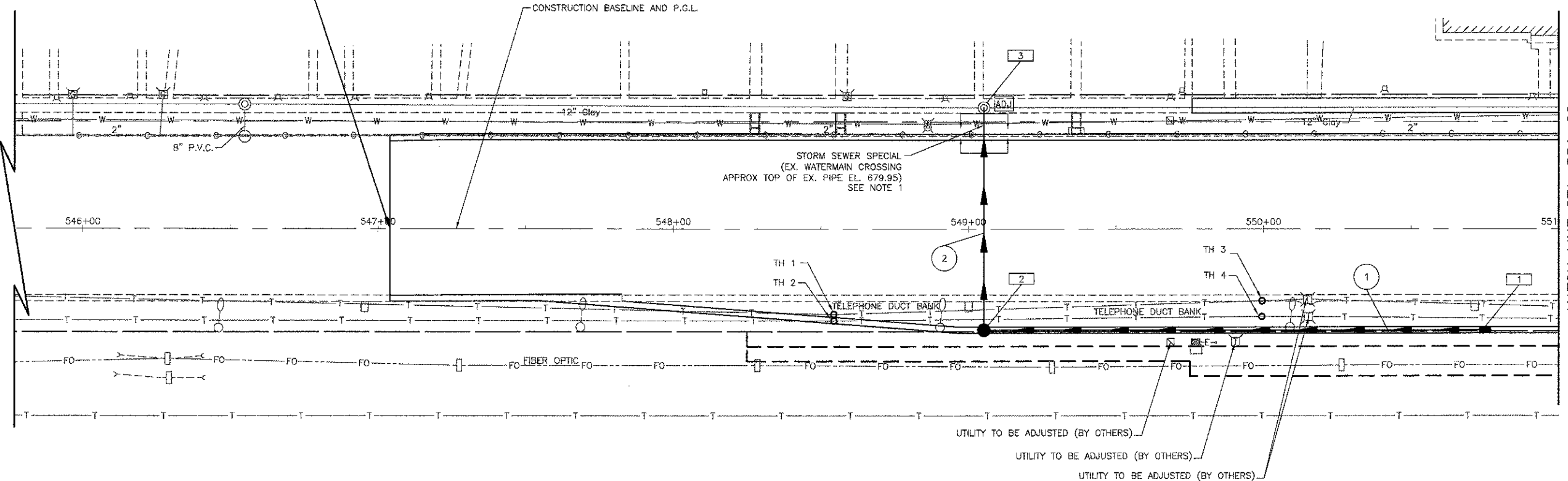

MATCH LINE STA. 551+00
(SEE SHEET NO. 41)

1 167' - STORM SEW CL A 1, 12" @ 0.50%
T.B.F. = 40 CU. YD.

2 57' - STORM SEW CL A 1, 12" @ 2.25%
15' - STORM SEW WM REQ, 12" @ 2.25%
T.B.F. = 30 CU. YD.

TEST HOLES (TH)				
TH	STATION	OFFSET	TOP OF UTILITY ELEV.	
1	548+54.46	28.73 RT	679.35	
2	548+56.48	30.94 RT	678.90	
3	549+99.51	24.12 RT	678.51	
4	549+99.43	29.44 RT	677.75	

NOTES:

1. THE WATERMAIN SHALL BE RELOCATED IF A CONFLICT EXISTS WITH A PROPOSED STORM SEWER. PAID FOR AS "REMOVE AND RELOCATE WATERMAIN".
2. SEE LIGHTING PLAN SHEETS E1 TO E21 FOR TEMPORARY LIGHTING & RELOCATION PLAN.

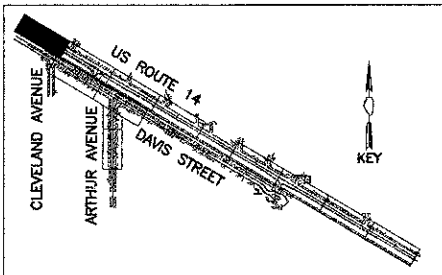

U.S. ROUTE 14

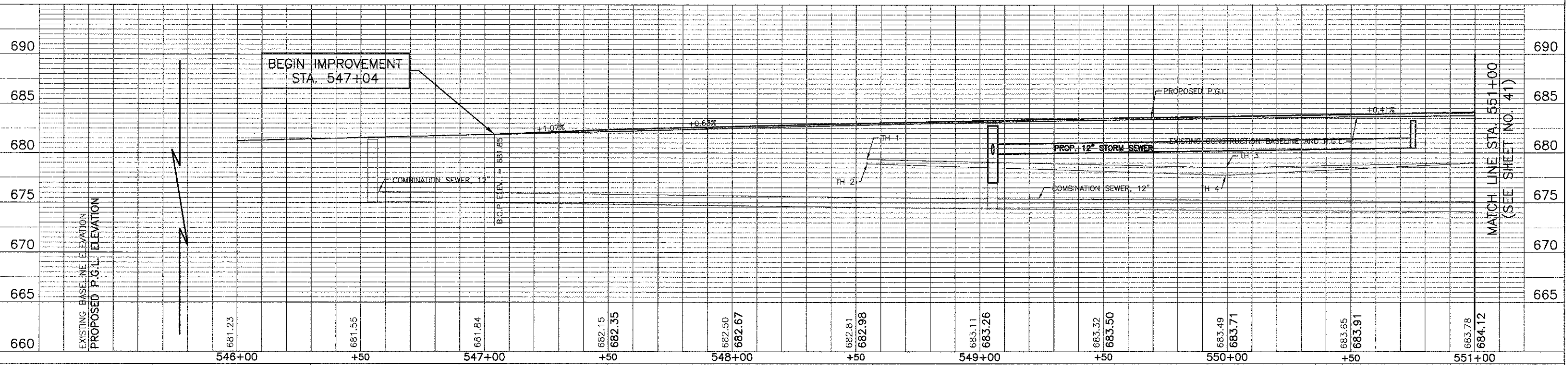

MATCH LINE STA. 551+00
(SEE SHEET NO. 41)



USER NAME = #USER#	DESIGNED - RTM	REVISED -
PLOT SCALE = #SCALE#	DRAWN - JRR	REVISED -
PLOT DATE = #DATE#	CHECKED - RTM	REVISED -
	DATE - 10/22/12	REVISED -

STATE OF ILLINOIS
DEPARTMENT OF TRANSPORTATION

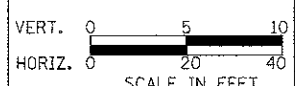

DRAINAGE AND UTILITIES - U.S. ROUTE 14 WEST

SHEET NO. 1 OF 12 SHEETS

STA. 547+04 TO STA. 551+00

F.A.U. RTE. 3512	SECTION 02-00177-00 WR	COUNTY COOK	TOTAL SHEETS 142	SHEET NO. 40
PROJECT NO. M-8003(426)		CONTRACT NO. 63514		
FED. ROAD DIST. NO. 1 ILLINOIS FED. AID PROJECT				