

- 4 STA. 552+06.0, 37.0' LT.
INLET TA T8C
RIM EL. = 683.00
INV. EL. = 680.80
- 5 STA. 551+95.0, 32.2' LT.
CB TA 4 DIA T23F&G
RIM EL. = 683.50
INV. EL. = 678.50 (N)
INV. EL. = 680.50 (E)
- 6 STA. 554+42.0, 43.0' RT.
INLET TA T23F&G
RIM EL. = 682.75
INV. EL. = 680.36

MATCH LINE STA. 551+00
(SEE SHEET NO. 40)

MATCH LINE STA. 556+50
(SEE SHEET NO. 42)

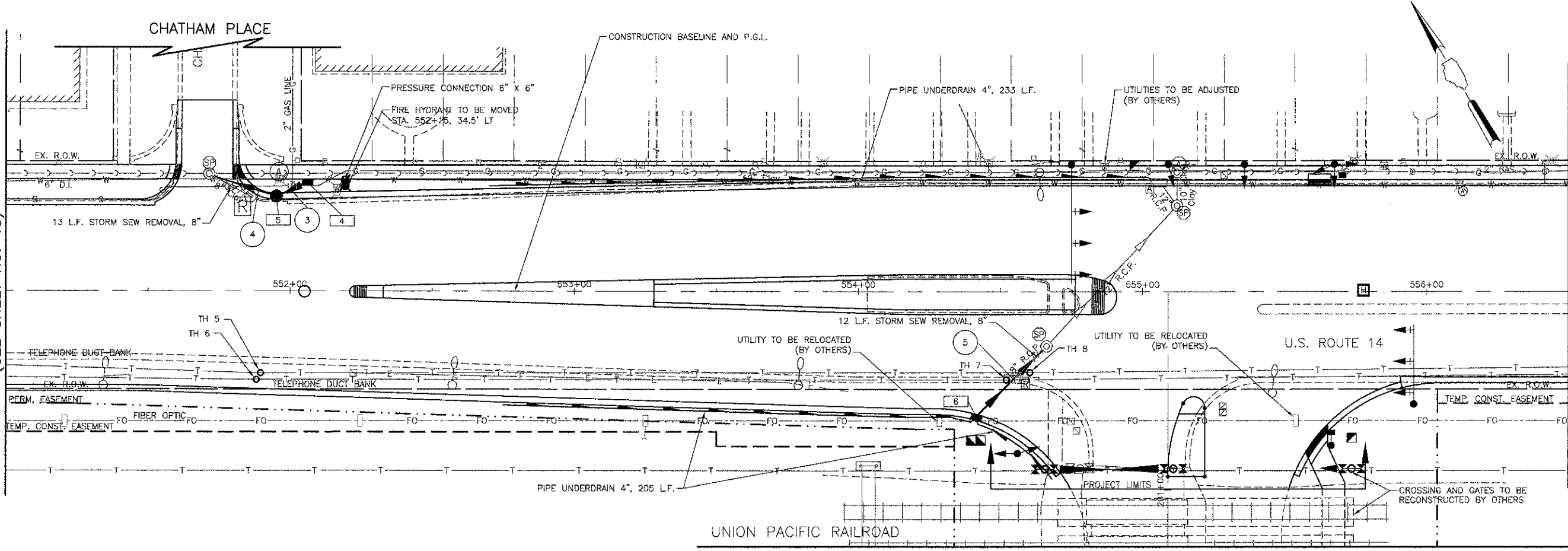

DATE	
BY	
STARTED	
PLOTTED	
NOTE BOOK	
NO.	
STRUCTURE	
NOTATIONS	
CHKD	
NO.	

DATE	
BY	
STARTED	
PLOTTED	
NOTE BOOK	
NO.	
STRUCTURE	
NOTATIONS	
CHKD	
NO.	

- 3 10' - STORM SEW WM REQ, 10" @ 3.00%
T.B.F. = 2 CU. YD.
- 4 20' - STORM SEW WM REQ, 10" @ 5.00%
T.B.F. = 5 CU. YD.
- 5 32' - STORM SEW CL A 1, 12" @ 1.45%
T.B.F. = 5 CU. YD.

TEST HOLES (TH)

TH	STATION	OFFSET	TOP OF UTILITY ELEV.
5	551+89.72	28.74 RT	679.47
6	551+88.21	31.08 RT	680.04
7	554+51.25	31.00 RT	679.68
8	554+60.40	28.40 RT	680.26

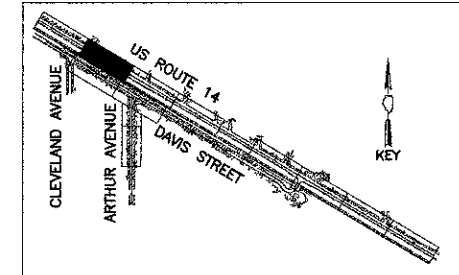

U.S. ROUTE 14

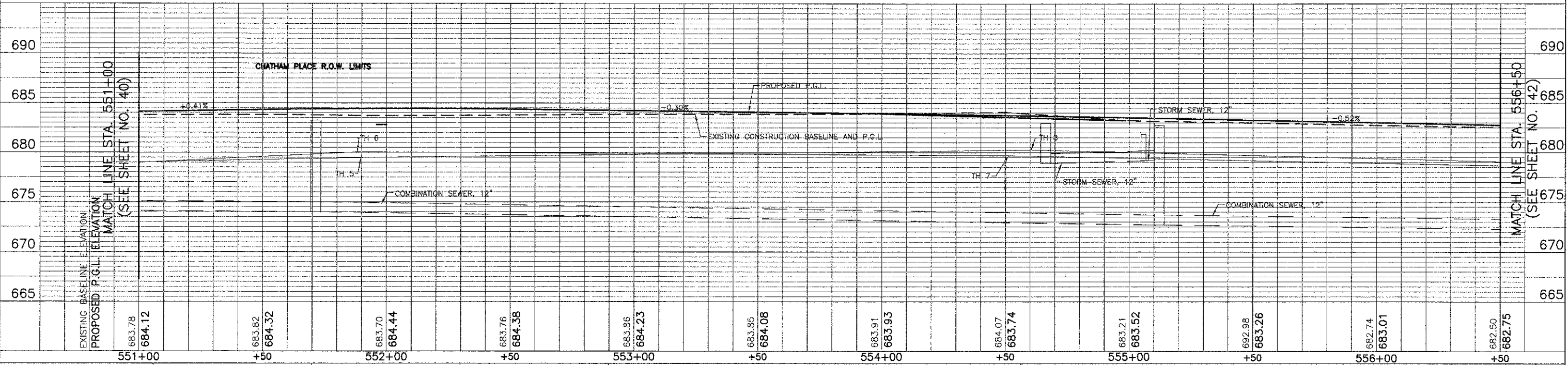

683.78	684.12	683.82	684.32	683.70	684.44	683.76	684.38	683.86	684.23	683.86	684.08	683.91	683.93	684.07	683.74	683.21	683.52	692.98	683.26	682.74	683.01	682.50	682.75
551+00		+50		552+00		+50		553+00		+50		554+00		+50		555+00		+50		556+00		+50	



USER NAME = #USER#	DESIGNED - RTM	REVISED -
PLOT SCALE = #SCALE#	DRAWN - JRR	REVISED -
PLOT DATE = #DATE#	CHECKED - RTM	REVISED -
	DATE - 10/22/12	REVISED -

STATE OF ILLINOIS
DEPARTMENT OF TRANSPORTATION

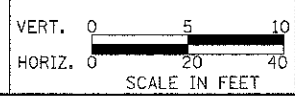

DRAINAGE AND UTILITIES - U.S. ROUTE 14 WEST

F.A.U. RTE. 3512	SECTION 02-00177-00 WR	COUNTY COOK	TOTAL SHEETS 142	SHEET NO. 41
PROJECT NO. M-8003(426)		CONTRACT NO. 63514		
FED. ROAD DIST. NO. 1 ILLINOIS FED. AID PROJECT				

SHEET NO. 2 OF 12 SHEETS STA. 551+00 TO STA. 556+50